



## 50 Ohm 1 Watts Brass SMP Male RF Load Up To 10 GHz

### TECHNICAL DATA SHEET

**PE6161**

#### 50 Ohm 1 Watts Brass SMP Male RF Load Up To 10 GHz

##### Configuration

Connector	SMP Male
Connector Specification	MIL-STD-348
Heat Sink	Brass, Gold

##### Electrical Specifications

Frequency Range, GHz	DC to 18
Impedance, Ohms	50
Maximum Return Loss, dB	20.1
Maximum Input Power, Watts	1

##### Frequency 1

Frequency, MHz	DC to 1,000
Return Loss, dB	28.3

##### Mechanical Specifications

###### Temperature

Operating Range, deg C	-55 to +155
------------------------	-------------

###### Size

Length, in [mm]	0.45 [11.43]
Width/Dia., in [mm]	0.2 [5.08]

##### Connector

Type	SMP Male
Mating Cycles	500
Inner Conductor Material and Plating	Brass, Gold
Inner Conductor Plating Specification	40µ in. minimum
Body Material and Plating	Brass, Gold

##### Compliance Certifications (visit [www.Pasternack.com](http://www.Pasternack.com) for current document)

RoHS Compliant	Yes
----------------	-----

Click the following link (or enter part number in "SEARCH" on website) to obtain additional part information including price, inventory and certifications: [50 Ohm 1 Watts Brass SMP Male RF Load Up To 10 GHz PE6161](#)

The information contained in this document is accurate to the best of our knowledge and representative of the part described herein. It may be necessary to make modifications to the part and/or the documentation of the part, in order to implement improvements. Pasternack reserves the right to make such changes as required. Unless otherwise stated, all specifications are nominal.



PE6161 CAD Drawing

50 Ohm 1 Watts Brass SMP Male RF Load Up To 10 GHz

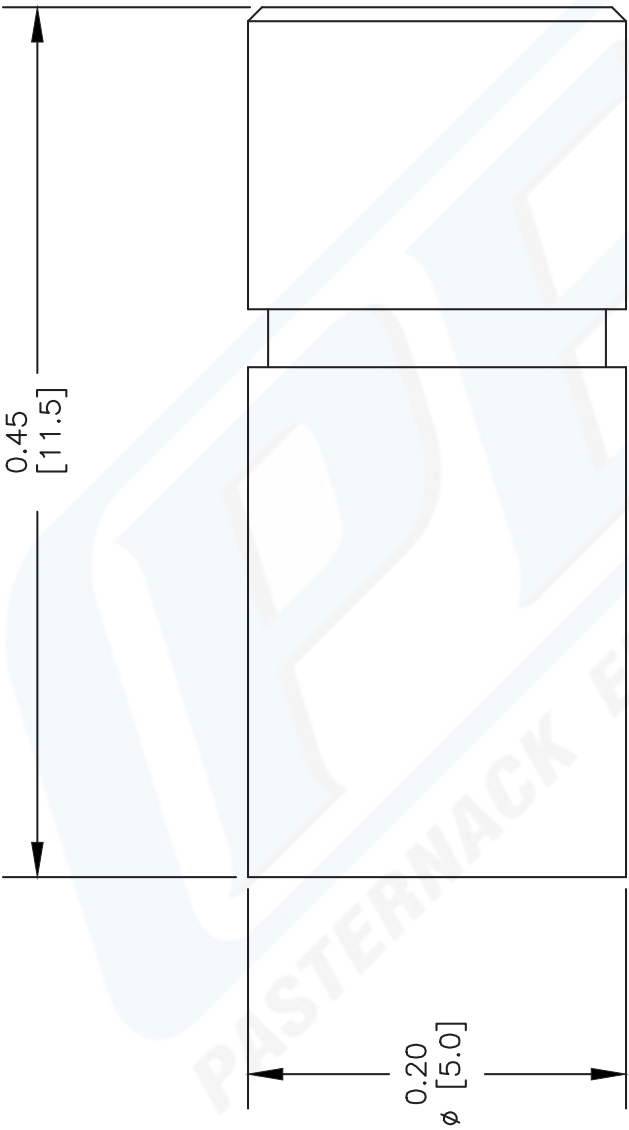

**PASTERNAK®**  
Pasternack Enterprises, Inc.  
P.O. Box 16759 | Irvine | CA | 92623  
**Phone:** (949) 261-1920 | **Fax:** (949) 261-7451  
**Website:** [www.pasternack.com](http://www.pasternack.com) | **E-Mail:** [sales@pasternack.com](mailto:sales@pasternack.com)

DWG TITLE

PE6161

FSCM NO. 53919

NOTES:  
1. UNLESS OTHERWISE SPECIFIED ALL DIMENSIONS ARE NOMINAL.  
2. ALL SPECIFICATIONS ARE SUBJECT TO CHANGE WITHOUT NOTICE AT ANY TIME.  
3. DIMENSIONS ARE IN INCHES [mm].

CAD FILE 101106

SCALE N/A

SIZE A

127