



SMA Female Bulkhead Connector Solder
Attachment 0.042 inch End Launch PCB, .250 inch
Diameter, .020 inch x .010 inch Contact

TECHNICAL DATA SHEET

PE44213

SMA Female Bulkhead Connector Solder Attachment 0.042 inch End Launch PCB, .250 inch Diameter, .020 inch x .010 inch Contact

Configuration

Connector	SMA Female
Connector Specification	MIL-C-39012
Connector Interface Type	0.042 inch End Launch
Cable Attachment Method (Shield/Contact)	Solder
Body Style	Straight
Mount Method	Bulkhead

Electrical Specifications

Impedance, Ohms	50
-----------------	----

Mechanical Specifications

Temperature

Operating Range, deg C	-65 to +165
------------------------	-------------

Size

Length, in [mm]	0.687 [17.45]
Width/Dia., in [mm]	0.375 [9.53]
Height, in [mm]	0.312 [7.92]
Weight, lbs [g]	0.008 [3.63]

Connector

Type	SMA Female
Contact Material and Plating	Gold
Contact Plating Specification	MIL-G-45204
Body Material and Plating	Brass, Gold
Body Plating Specification	MIL-G-45204
Dielectric Type	Teflon

Compliance Certifications (visit www.Pasternack.com for current document)

RoHS Compliant	Yes
----------------	-----

Click the following link (or enter part number in "SEARCH" on website) to obtain additional part information including price, inventory and certifications: [SMA Female Bulkhead Connector Solder Attachment 0.042 inch End Launch PCB, .250 inch Diameter, .020 inch x .010 inch Contact PE44213](#)

The information contained in this document is accurate to the best of our knowledge and representative of the part described herein. It may be necessary to make modifications to the part and/or the documentation of the part, in order to implement improvements. Pasternack reserves the right to make such changes as required. Unless otherwise stated, all specifications are nominal.



SMA Female Bulkhead Connector Solder
Attachment 0.042 inch End Launch PCB, .250 inch
Diameter, .020 inch x .010 inch Contact

TECHNICAL DATA SHEET

PE44213

Plotted and Other Data

Notes:

Values at 25 °C, sea level

SMA Female Bulkhead Connector Solder Attachment 0.042 inch End Launch PCB, .250 inch Diameter, .020 inch x .010 inch Contact from Pasternack Enterprises has same day shipment for domestic and International orders. Our RF, microwave and fiber optic products maintain a 99% availability and are part of the broadest selection in the industry.

Click the following link (or enter part number in "SEARCH" on website) to obtain additional part information including price, inventory and certifications: [SMA Female Bulkhead Connector Solder Attachment 0.042 inch End Launch PCB, .250 inch Diameter, .020 inch x .010 inch Contact PE44213](http://www.pasternack.com/sma-female-standard-0.042-end-launch-connector-pe44213-p.aspx)

URL: <http://www.pasternack.com/sma-female-standard-0.042-end-launch-connector-pe44213-p.aspx>

The information contained in this document is accurate to the best of our knowledge and representative of the part described herein. It may be necessary to make modifications to the part and/or the documentation of the part, in order to implement improvements. Pasternack reserves the right to make such changes as required. Unless otherwise stated, all specifications are nominal.

PE44213 CAD Drawing

SMA Female Bulkhead Connector Solder Attachment 0.042 inch End
Launch PCB, .250 inch Diameter, .020 inch x .010 inch Contact

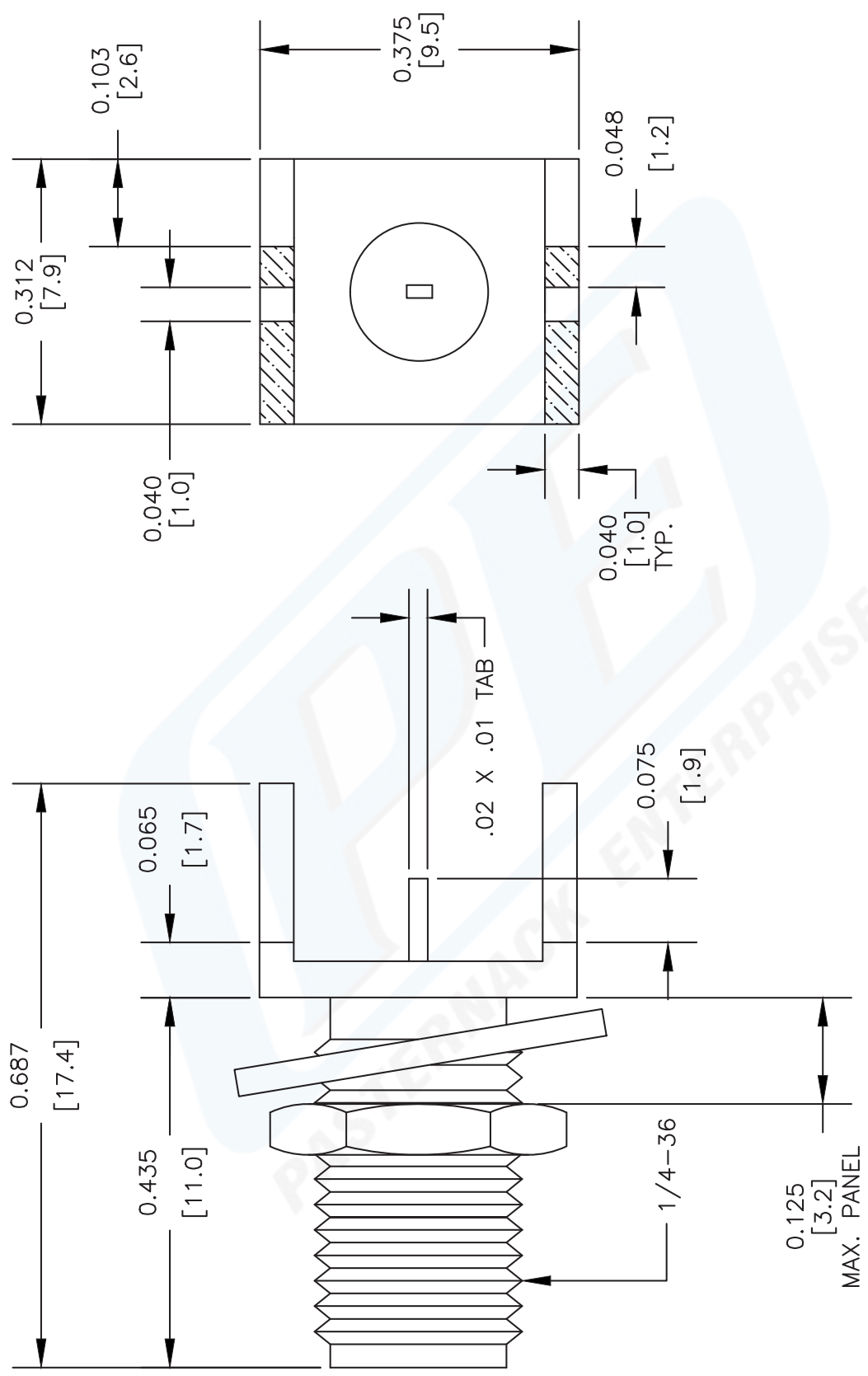

NOTES:
1. UNLESS OTHERWISE SPECIFIED ALL DIMENSIONS ARE NOMINAL.
2. ALL SPECIFICATIONS ARE SUBJECT TO CHANGE WITHOUT NOTICE AT ANY TIME.
3. DIMENSIONS ARE IN INCHES [mm].

DWG TITLE		FSCM NO. 53919		CAD FILE XXXXXX		SCALE N/A	SIZE A	XXXX
PE44213								



PASTERNAK®
Pasternack Enterprises, Inc.
P.O. Box 16759 | Irvine | CA | 92623
Phone: (949) 261-1920 | Fax: (949) 261-7451
Website: www.pasternack.com | E-Mail: sales@pasternack.com