

ATTENUATORS FLANGED

DC-4 GHz, 10 WATTS

SPECIFICATIONS:

Electrical:

Frequency Range _____ DC - 4 GHz
Atten. Accuracy _____ DC-1 GHz 1-2.5 GHz 2.5-4 GHz
1 - 10 dB _____ ± 0.5 dB _____ ± 0.5 dB _____ ± 0.5 dB
11 - 20 dB _____ ± 1.0 dB _____ ± 2.0 dB _____ ± 3.0 dB
Ohm Value _____ 50 Ohms
Power _____ 10 Watts Max.
Based on flange temp. of 100°C Max.
VSWR _____ 1.30:1 Max.
Temperature Range: _____ -55°C to +150°C

Mechanical:

Substrate _____ Beryllium Oxide
Cover _____ Alumina Ceramic
Mounting Flange _____ Nickel Plated Copper
Tabs _____ Gold Plated Beryllium Copper



Model Number: PPA10-XX

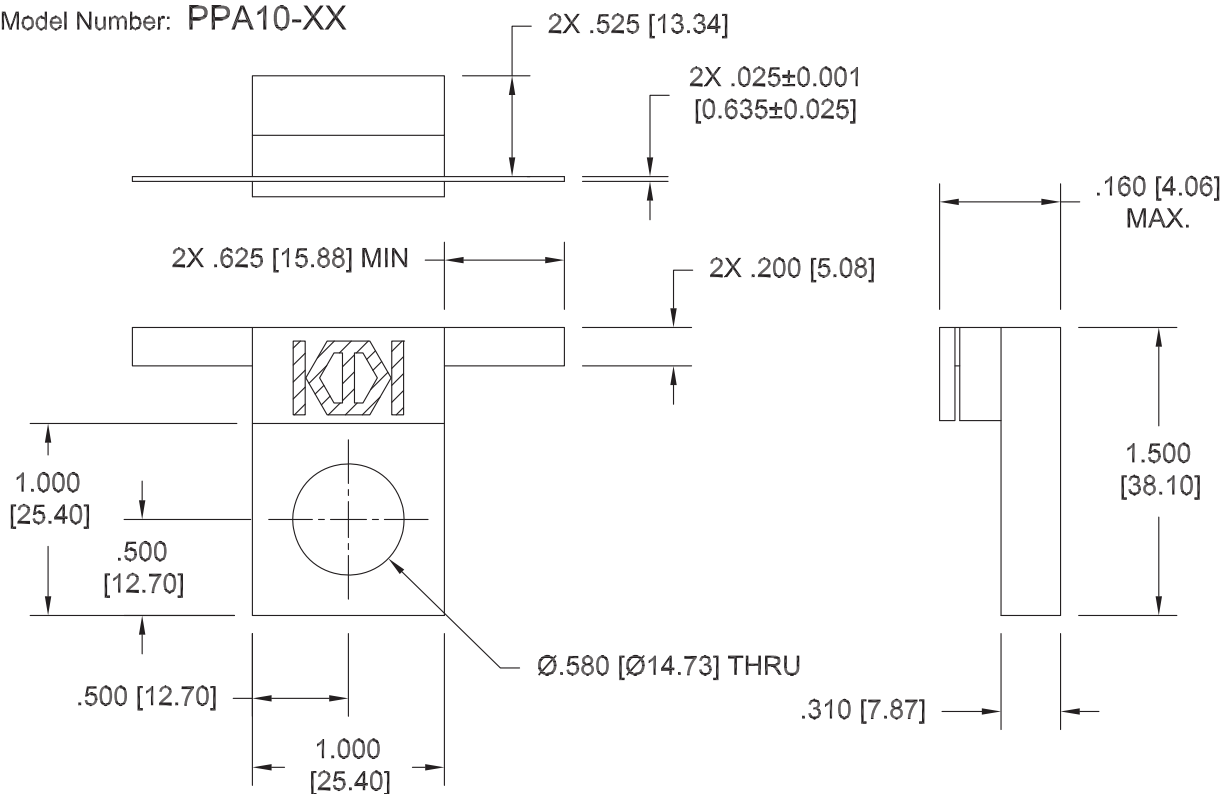

TOLERANCE: .XXX \pm .010

HOW TO ORDER:

Model Number: PPA10-XX
dB Value

Ordering Examples:

Model Number: PPA10-10
10dB

Note: Dimensions in Brackets are Expressed in Millimeters and are for Reference Only.
Design Specifications are subject to change without notice.

OL-PPA10; REV A



Aeroflex / Inmet, Inc. • 300 Dino Drive, Ann Arbor, MI 48103 • U.S.A.
888-244-6638 or 734-426-5553 • FAX: 734-426-5557
www.aeroflex-inmetcorp.com • sales@aeroflex-inmetcorp.com