

TERMINATIONS 7/16 DIN

**DC - 7.5 GHz
5 WATTS**

api 
technologies corp.
> INMET

MODELS: 3073DM, 3073DF, 3073DMC, 3073DFC

SPECIFICATIONS:

Electrical:

Frequency Range _____ DC - 7.5 GHz
VSWR: _____
DC - 4 GHz _____ 1.25:1 Max.
4 - 7.5 GHz _____ 1.45:1 Max.
Impedance _____ 50 Ohms
Input Power _____ 5 Watts Avg. @ +25°C
Derated Linearly to 1 Watt @ +125°C
Peak Power _____ 5 kW Max.
(5uSec Pulse, .05% Duty Cycle)
Operating Temp Range _____ -65°C to +125°C

Mechanical:

7/16 DIN Connectors _____ Silver Plated Brass
Mates with DIN 47 223
Housing _____ Anodized Aluminum
Conductors _____ Silver Plated Beryllium Copper or Brass
Bead Chain _____ Passivated Stainless Steel

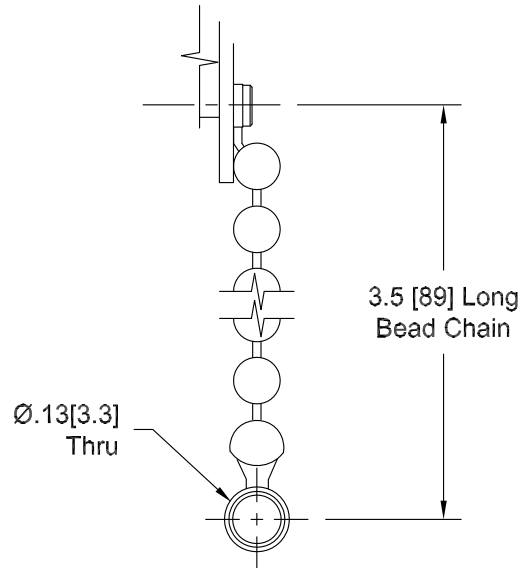

CHAIN DETAIL

Model Number: **3073DF**
7/16-DIN Female Connector

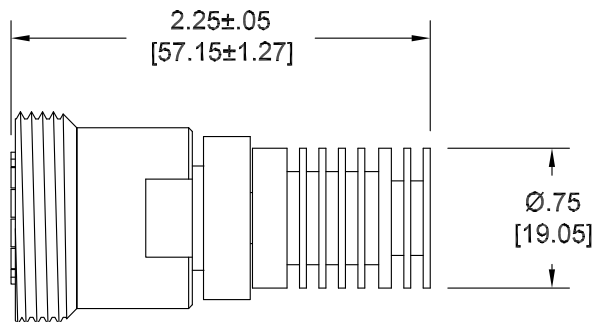

Model Number: **3073DM**
7/16-DIN Male Connector

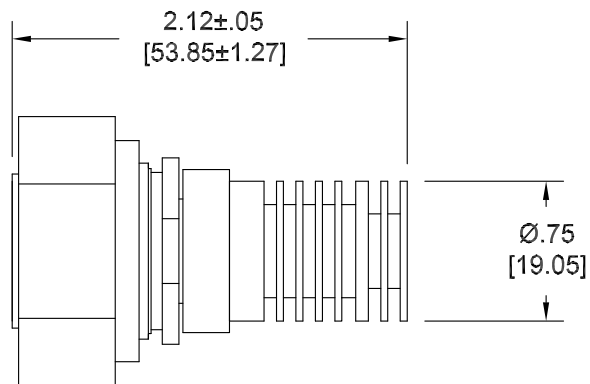

HOW TO ORDER:

Model Number: **3073DXY**

Connector Config. ☐ Style

M = Male = No Chain
F = Female C = Chain Included

Ordering Examples:

Model Number: **3073DMC**
DC - 7.5 GHz; 7/16 DIN Male; Chain Included

Model Number: **3073DF**
DC - 7.5 GHz; 7/16 DIN Female; No Chain

Model Number: **3073DM**
DC - 7.5 GHz; 7/16 DIN Male; No Chain

Note: Dimensions in Brackets are Expressed in Millimeters and are for Reference Only.
Design specifications are subject to change without notice.
Contact factory for technical specifications before purchasing or use.