

1. MATERIALS AND FINISHES:
BODY, OUTER CONTACT & COUPLING NUT- BRASS, NICKEL PLATED .000100 MIN THICK
CONTACT- BRASS, GOLD PLATED .000030 MIN THICK
RETAINING RING- PHOSPHOR BRONZE
FERRULE- COPPER ALLOY, NICKEL PLATED .000100 MIN THICK
INSULATORS- PTFE
GASKET- SILICONE RUBBER
2. ELECTRICAL:
A. IMPEDANCE: 50 OHM
B. FREQUENCY RANGE: DC - 2.2 GHz
C. VSWR(RETURN LOSS): 1.065 (30 dB), MAX.
D. DIELECTRIC WITHSTANDING VOLTAGE: 2,500 VRMS, MIN.
3. MECHANICAL:
B. TEMPERATURE RANGE: -65° C TO +165° C
4. PACKAGING:
A. QUANTITY: SINGLE PACK
B. MARKING: BAG TO BE MARKED
"AMPHENOL, 82-6312-1000, AND DATE CODE"
5. DO NOT SCALE THIS DRAWING.
6. ASTERISK (*) INDICATES CABLE ENTRY DIMENSIONS.
7. CABLE ASSEMBLY INSTRUCTIONS:
TRIM CABLE AS SHOWN
SLIDE DIELECTRIC BUSHING ONTO REAR END OF CONTACT BEFORE SOLDERING
OR CRIMPING TO CABLE CENTER CONDUCTOR
WHEN SOLDERING CONTACT TO CABLE, ROSIN FLOE (60% TIN/ 40% LEAD)
SOFT SOLDER PER QQ-S-571 IS RECOMMENDED. WHEN CRIMPING CONTACT TO CABLE,
CRIMP WITH AMPHENOL TOOL 227-944 & DIE SET 227-1221-57, CAVITY "B"
CRIMP FERRULE OVER BRAID AND BODY WITH AMPHENOL TOOL 227-994
AND DIE SET 227-1221-57, CAVITY "A"

Technical drawing of a mechanical assembly. The drawing shows a cross-section of a component with a mesh-like internal structure. Dimensions are indicated by arrows and numbers:

- Overall length: .633
- Length of the mesh section: .435
- Length of the section to the right of the mesh: .362

RECOMMENDED
STRIPPING DIMENSIONS
SCALE 2.000

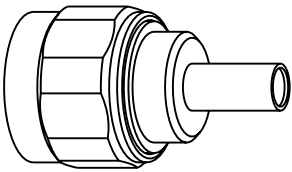

Technical drawing of the front view of a mechanical component. The component features a large outer flange with a reference diameter of $\varnothing.850$ REF. The central part consists of a circular hub with a central hole. The drawing includes a vertical centerline and a horizontal centerline, both represented by dashed lines. Section lines (A-A) are indicated at the top and bottom of the drawing.

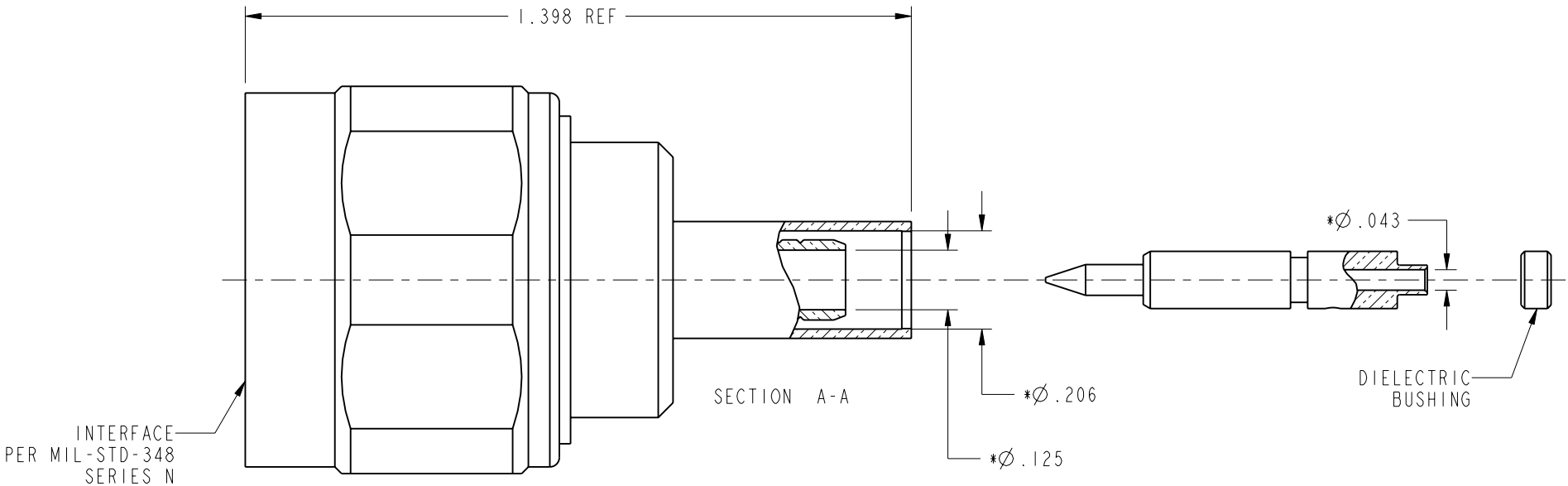

UNLESS OTHERWISE SPECIFIED, DIMENSIONS ARE IN INCHES AND TOLERANCES ARE: 2 PLACE DECIMAL 3 PLACE DECIMAL ANGLES ± 0.015 (0,381 mm) ± 0.005 (0,127 mm) $\pm 1^\circ$			MATERIAL REFERENCE EAR 1113 GEN# ASSYM63_N SIM TO 82-6312		DRAWN C. McGRATH ENGINEER O. BARTHELMES APPROVED O. BARTHELMES CAD FILE I:\N\82-6312-1000		DATE 10/6/03 DATE 10/6/03 DATE 10/9/03		TITLE N PLUG CRIMP/CRIMP FOR RG-58 & RG-58 FOIL TYPE CABLE			Amphenol RF Danbury, CT, USA Tainan, Taiwan Shenzhen, China www.amphenolrf.com			SCALE: 3.0:1 SHEET 2 OF 2		CODE ID 74868		DWG SIZE B		DRAWING NO. 82-6312-1000		REV A	
NOTICE - These drawings, specifications, or other data (1) are, and remain the property of Amphenol Corp. (2) must be returned upon request; and (3) are confidential and not to be disclosed to any person other than those to whom they are given by Amphenol Corp. The furnishing of these drawings, specifications, or other data by Amphenol Corp., or to any other person to anyone for any purpose is not to be regarded by implication or otherwise in any manner licensing, granting rights or permitting such holder or any other person to manufacture, use or sell any product, process or design, patented or otherwise, that may in any way be related to or disclosed by said drawings, specifications, or other data.																								