

MECHANICAL CHARACTERISTICS	
INTERFACE	MIL-STD-348, FIGURE 313-2
IN ACCORDANCE WITH THE INTENT OF SLANT SHEET	N/A
RECOMMENDED MATING TORQUE	20 IN-LBS. NOM.
COUPLING PROOF TORQUE	25 IN-LBS. MIN.
COUPLING NUT RETENTION	100 LBS. MIN.
FORCE TO ENGAGE	2 IN-LBS. MAX.
FORCE TO DISENGAGE	2 IN-LBS. MAX.
DURABILITY	500 CYCLES MIN.
AXIAL CONTACT RETENTION (FROM INTERFACE)	6 LBS. MIN. (BOTH DIRECTIONS)
MASS	12.54 GRAMS NOM.
ELECTRICAL CHARACTERISTICS	
IMPEDANCE	50 Ohms NOM.
MAXIMUM FREQUENCY	12.4 GHz
VSWR DC - 12.4 GHz	1.15:1 MAX
INSERTION LOSS	0.09 √F (GHz) dB MAX.
DIELECTRIC WITHSTANDING VOLTAGE	1500 Vrms MIN.
INSULATION RESISTANCE	5000 MegaOhms MIN.
RF LEAKAGE DC - 12.4 GHz	-90 dB
CORONA	375 Vrms MIN. @ 70,000 FEET
RF HIGH POTENTIAL	1000 Vrms MIN.
CONTACT RESISTANCE (INNER)	1.5 MilliOhms MAX.
CONTACT RESISTANCE (OUTER)	0.2 MilliOhms MAX.
ENVIRONMENTAL CHARACTERISTICS	
OPERATING TEMPERATURE	-100 °C TO 165 °C
VIBRATION	MIL-STD-202, METHOD 204, CONDITION D
MECHANICAL SHOCK	MIL-STD-202, METHOD 213, CONDITION I
THERMAL SHOCK	MIL-STD-202, METHOD 107, CONDITION B
CORROSION	MIL-STD-202, METHOD 101, CONDITION B, 5%
MATERIALS AND FINISH	
CONTACT	BERYLLIUM COPPER PER ASTM-B-196, GOLD PLATE PER MIL-DTL-45204, OVER NICKEL PLATE AMS-QQ-N-290
BODY & BUSHING	STEEL, CORROSION RESISTANT PER ASTM-A-582, PASSIVATE PER ASTM-A-967
INSULATOR	TFE FLUOROCARBON PER ASTM-D-1710
APPLICATION	
INSTALLATION	N/A

THIS DRAWING IS PROPRIETARY AND CONFIDENTIAL.

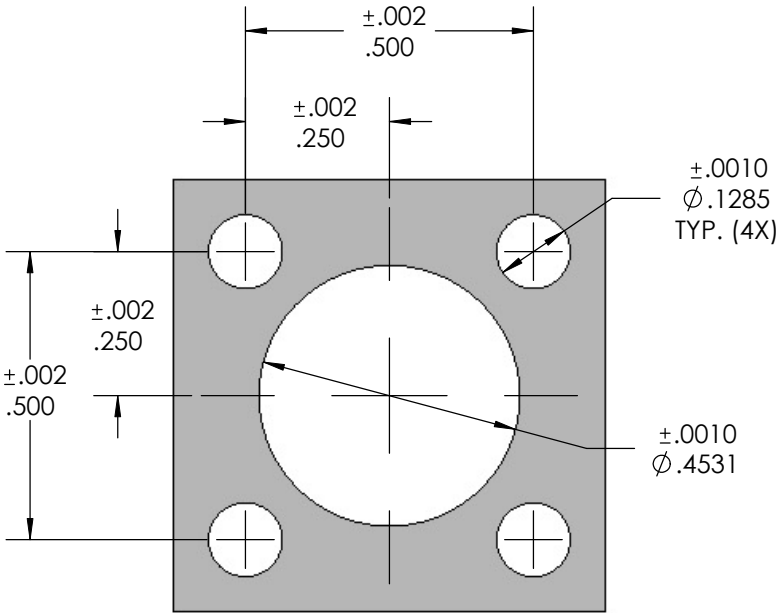
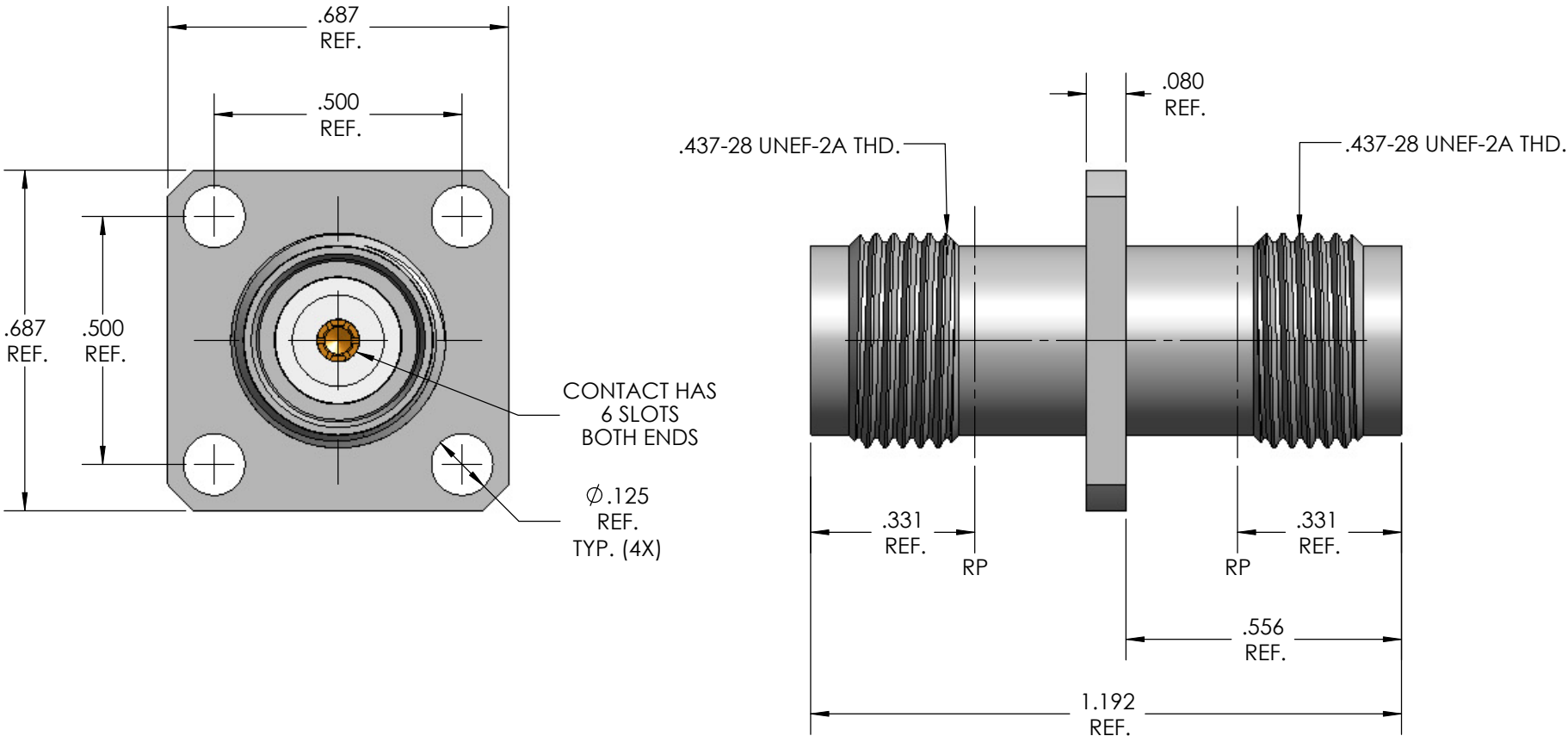

RECOMENDED
PANEL CUT OUT
MAX PANEL THICKNESS: .100"

THIS SPECIFICATION IS THE PROPERTY OF MICRO-COAX, INC. AND MAY NOT BE USED OR COPIED WITHOUT THE EXPRESS WRITTEN PERMISSION OF MICRO-COAX, INC.		INITIALS		DATE		<div>MICRO-COAX</div> <div>PROVEN RELIABLE</div>					
		DWN.	MJM	2/16/07							
		CHKD.	NDS	3/27/14							
		APPVD.									
TOLERANCES UNLESS OTHERWISE SPECIFIED		TITLE									
		ADAPTER, TNC JACK - TNC JACK, 4 HOLE FLANGE, SPACE GRADE									
.XX	± .02	ALL DIMENSIONS IN INCHES UNLESS OTHERWISE SPECIFIED. SCREW THDS. TO BE IN ACCORD WITH ANSI B1.1-1989.				FSCM NO.	SIZE	SCALE	SHEET NO.	DRAWING NO.	REV
.XXX	± .005					64639	B	3:1	1 OF 1	SD904683	B
.XXXX	± .0010										
ANGLES	± 2°										