



QMA Female Bulkhead Connector Crimp/Solder Attachment  
For RG174, RG316, RG188, .268 inch D Hole

TECHNICAL DATA SHEET

PE44507

QMA Female Bulkhead Connector Crimp/Solder Attachment For RG174, RG316, RG188, .268 inch D Hole

**Configuration**

Connector	QMA Female
Connector Interface Type	RG174, RG316, RG188
Cable Attachment Method (Shield/Contact)	Crimp/Solder
Body Style	Straight
Mount Method	Bulkhead

**Electrical Specifications**

Frequency Range, GHz	DC to 18
Impedance, Ohms	50
Maximum Operating Voltage, Volts	350
Dielectric Withstanding Voltage, Vrms	750

**Frequency 1**

Frequency, GHz	DC to 3
VSWR	1.07:1
Return Loss, dB	30
Insertion Loss, dB	0.086

**Frequency 2**

Frequency, GHz	3 to 6
VSWR	1.11:1
Return Loss, dB	26
Insertion Loss, dB	0.12

**Mechanical Specifications**

**Temperature**

Operating Range, deg C	-40 to +85
Storage Range, deg C	-40 to +85

**Size**

Length, in [mm]	0.95 [24.13]
Width/Dia., in [mm]	0.44 [11]
Weight, lbs [g]	0.006 [2.72]

**Connector**

Type	QMA Female
Contact Material and Plating	Beryllium Copper, Gold
Body Material and Plating	Brass, Tri-Metal
Dielectric Type	PTFE

Click the following link (or enter part number in "SEARCH" on website) to obtain additional part information including price, inventory and certifications: [QMA Female Bulkhead Connector Crimp/Solder Attachment For RG174, RG316, RG188, .268 inch D Hole PE44507](#)

The information contained in this document is accurate to the best of our knowledge and representative of the part described herein. It may be necessary to make modifications to the part and/or the documentation of the part, in order to implement improvements. Pasternack reserves the right to make such changes as required. Unless otherwise stated, all specifications are nominal.



QMA Female Bulkhead Connector Crimp/Solder Attachment  
For RG174, RG316, RG188, .268 inch D Hole

TECHNICAL DATA SHEET

PE44507

**Compliance Certifications** (visit [www.Pasternack.com](http://www.Pasternack.com) for current document)

RoHS Compliant

Yes

**Plotted and Other Data**

Notes:

Values at 25 °C, sea level

QMA Female Bulkhead Connector Crimp/Solder Attachment For RG174, RG316, RG188, .268 inch D Hole from Pasternack Enterprises has same day shipment for domestic and International orders. Our RF, microwave and fiber optic products maintain a 99% availability and are part of the broadest selection in the industry.

Click the following link (or enter part number in "SEARCH" on website) to obtain additional part information including price, inventory and certifications: [QMA Female Bulkhead Connector Crimp/Solder Attachment For RG174, RG316, RG188, .268 inch D Hole PE44507](http://www.pasternack.com/qma-female-standard-rg174-rg316-rg188-connector-pe44507-p.aspx)

URL: <http://www.pasternack.com/qma-female-standard-rg174-rg316-rg188-connector-pe44507-p.aspx>

The information contained in this document is accurate to the best of our knowledge and representative of the part described herein. It may be necessary to make modifications to the part and/or the documentation of the part, in order to implement improvements. Pasternack reserves the right to make such changes as required. Unless otherwise stated, all specifications are nominal.

# PE44507 CAD Drawing

QMA Female Bulkhead Connector Crimp/Solder Attachment  
For RG174, RG316, RG188, .268 inch D Hole

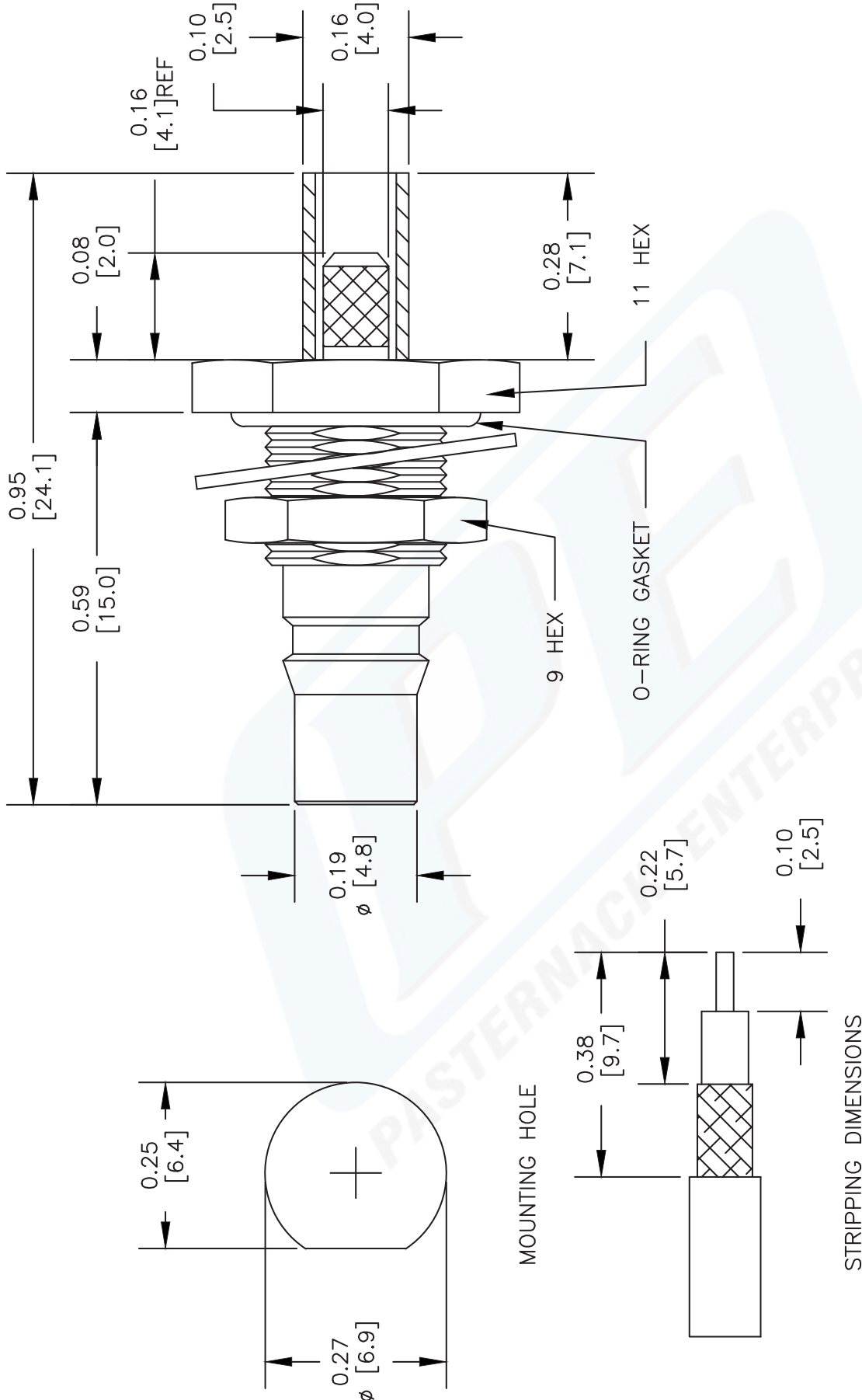

## CRIMP SIZE REQUIRED

CONTACT: SOLDER  
FERRULE: .128" HEX CRIMP TOOL



Pasternack Enterprises, Inc.  
P.O. Box 16759 | Irvine | CA | 92623

Phone: (949) 261-1920 | Fax: (949) 261-7451  
Website: [www.pasternack.com](http://www.pasternack.com) | E-Mail: [sales@pasternack.com](mailto:sales@pasternack.com)

DWG TITLE

**PE44507**

NOTES:  
1. UNLESS OTHERWISE SPECIFIED ALL DIMENSIONS ARE NOMINAL.  
2. ALL SPECIFICATIONS ARE SUBJECT TO CHANGE WITHOUT NOTICE AT ANY TIME.  
3. DIMENSIONS ARE IN INCHES [mm].  
4. FITS MIL-C-17 AND EQUIVALENT CABLES.

REV. E

FSCM NO. 53919

CAD FILE 102111

SCALE N/A

SIZE A

XXXX