

TERMINATIONS BNC

UP TO **4 GHz**
50 WATTS

api 
technologies corp.
> INMET

MODELS: TBXXXM-50W, TBXXXF-50W

SPECIFICATIONS:

Electrical:

Frequency Range _____ DC – 4 GHz
Standard Freq. Values _____ 2.5 & 4 GHz
VSWR _____ 1.25:1 Max.
Impedance _____ 50 Ohms
Input Power _____ 50 Watts Avg. @ +25°C
Derated Linearly to 10 Watts @ +125°C
Peak Power _____ 500 Watts Max.
(5uSec Pulse, .05% Duty Cycle)
Operating Temp Range _____ -65°C to +125°C

Mechanical:

BNC Connectors _____ Nickel Plated Brass
Mates with MIL-STD-348
Housing _____ Anodized Aluminum
Conductors _____ Gold Plated Beryllium Copper or Brass

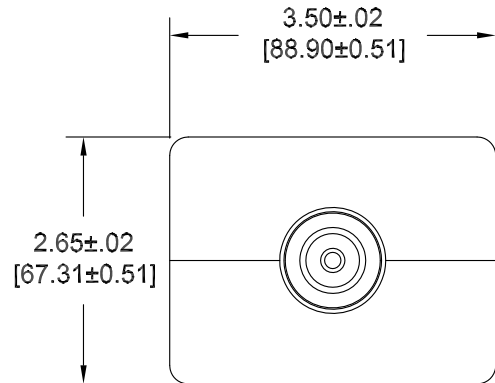

**END VIEW
TYPICAL**

Units must be Mounted in such a way
as to Allow for Free Air Flow Around
fins as to Assure Performance.

Model Number: **TBXXXM-50W**
BNC Male Connector

Model Number: **TBXXXF-50W**
BNC Female Connector

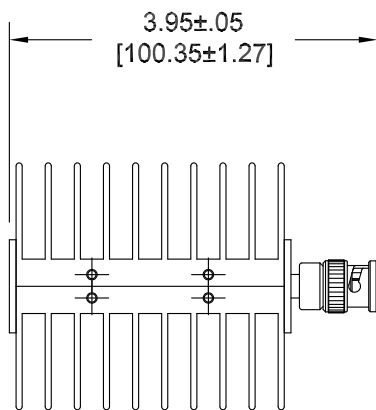

NOTE: Hole Pattern typical for both
Male & Female units

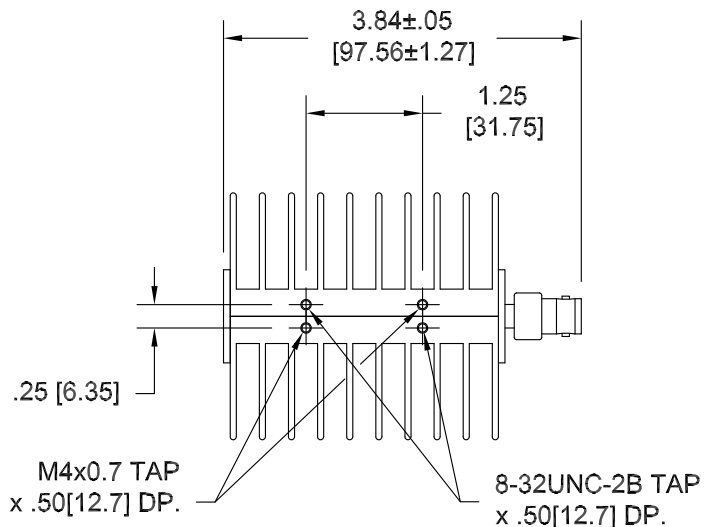

HOW TO ORDER:

Model Number: **TBXXXY-50W**

Freq. Range _____ Connector Config.
020 = DC – 2.5 GHz F = Female
040 = DC – 4 GHz M = Male

Ordering Examples:

Model Number: **TB020M-50W**
DC – 2.5 GHz, BNC Male Conn.

Model Number: **TB040F-50W**
DC – 4 GHz, BNC Female Conn.

Note: Dimensions in Brackets are Expressed in Millimeters and are for Reference Only.
Design specifications are subject to change without notice.
Contact factory for technical specifications before purchasing or use.