



## SMA Female Connector Solder Attachment Surface Mount PCB

### TECHNICAL DATA SHEET

PE4910

#### SMA Female Connector Solder Attachment Surface Mount PCB

##### Configuration

|  |               |
|--|---------------|
| Connector                                | SMA Female    |
| Connector Specification                  | MIL-STD-348A  |
| Connector Interface Type                 | Surface Mount |
| Cable Attachment Method (Shield/Contact) | Solder        |
| Body Style                               | Straight      |

##### Electrical Specifications

|                                  |            |
|----------------------------------|------------|
| Frequency Range, GHz             | DC to 12.4 |
| Impedance, Ohms                  | 50         |
| Maximum VSWR                     | 1.23:1     |
| Maximum Operating Voltage, Volts | 500        |

##### Mechanical Specifications

###### Temperature

|                        |             |
|------------------------|-------------|
| Operating Range, deg C | -65 to +165 |
|------------------------|-------------|

###### Size

|                     |              |
|---------------------|--------------|
| Length, in [mm]     | 0.346 [8.79] |
| Width/Dia., in [mm] | 0.25 [6.35]  |
| Weight, lbs [g]     | 0.006 [2.72] |

###### Connector

|                               |                        |
|-------------------------------|------------------------|
| Type                          | SMA Female             |
| Contact Material and Plating  | Beryllium Copper, Gold |
| Contact Plating Specification | 50µ in. minimum        |
| Body Material and Plating     | Brass, Gold            |
| Body Plating Specification    | 30µ in. minimum        |
| Dielectric Type               | Teflon                 |

##### Compliance Certifications (visit [www.Pasternack.com](http://www.Pasternack.com) for current document)

|                |     |
|----------------|-----|
| RoHS Compliant | Yes |
|----------------|-----|

Click the following link (or enter part number in "SEARCH" on website) to obtain additional part information including price, inventory and certifications: [SMA Female Connector Solder Attachment Surface Mount PCB PE4910](#)

The information contained in this document is accurate to the best of our knowledge and representative of the part described herein. It may be necessary to make modifications to the part and/or the documentation of the part, in order to implement improvements. Pasternack reserves the right to make such changes as required. Unless otherwise stated, all specifications are nominal.



## TECHNICAL DATA SHEET

PE4910

### Plotted and Other Data

Notes:

Values at 25 °C, sea level

SMA Female Connector Solder Attachment Surface Mount PCB from Pasternack Enterprises has same day shipment for domestic and International orders. Our RF, microwave and fiber optic products maintain a 99% availability and are part of the broadest selection in the industry.

Click the following link (or enter part number in "SEARCH" on website) to obtain additional part information including price, inventory and certifications: [SMA Female Connector Solder Attachment Surface Mount PCB PE4910](http://www.pasternack.com/sma-female-standard-surface-mount-pcb-connector-pe4910-p.aspx)

URL: <http://www.pasternack.com/sma-female-standard-surface-mount-pcb-connector-pe4910-p.aspx>

The information contained in this document is accurate to the best of our knowledge and representative of the part described herein. It may be necessary to make modifications to the part and/or the documentation of the part, in order to implement improvements. Pasternack reserves the right to make such changes as required. Unless otherwise stated, all specifications are nominal.



# PE4910 CAD Drawing

SMA Female Connector Solder Attachment Surface Mount PCB

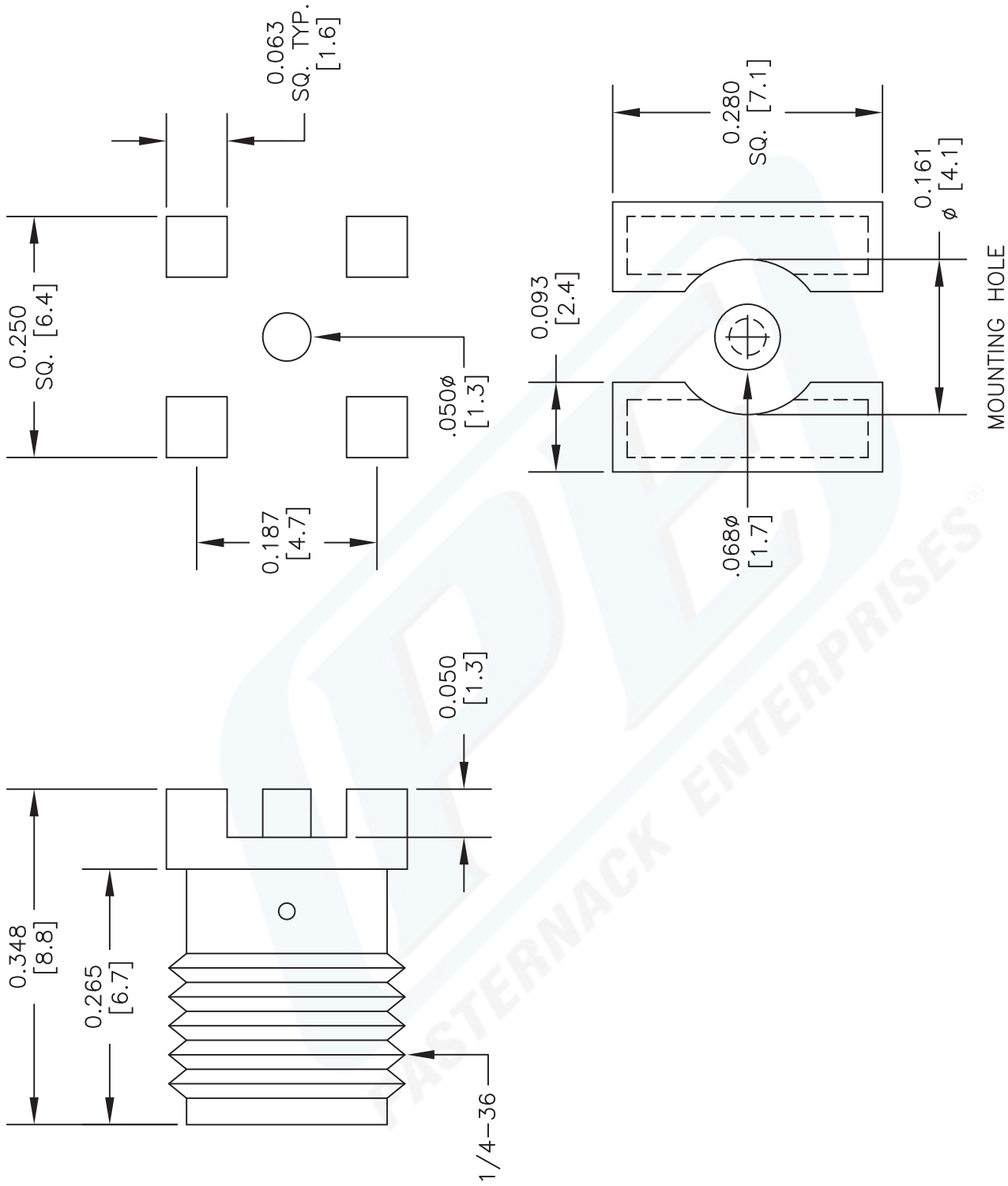

DWG TITLE

**PE4910**

- NOTES:
1. UNLESS OTHERWISE SPECIFIED ALL DIMENSIONS ARE NOMINAL.
  2. ALL SPECIFICATIONS ARE SUBJECT TO CHANGE WITHOUT NOTICE AT ANY TIME.
  3. DIMENSIONS ARE IN INCHES [mm].
  4. FITS MIL-C-17 AND EQUIVALENT CABLES.

FSCM NO. 53919

CAD FILE 020508

SCALE N/A

SIZE A

2233

**PE PASTERNAK®**

Pasternack Enterprises, Inc.  
P.O. Box 16759 | Irvine | CA | 92623  
Phone: (949) 261-1920 | Fax: (949) 261-7451  
Website: www.pasternack.com | E-Mail: sales@pasternack.com