



SMA Female Field Replaceable Connector
2 Hole Flange Mount 0.036 Inch Pin

TECHNICAL DATA SHEET

PE45055

Configuration

Connector	SMA Female
Connector Specification	MIL-STD-348
Connector Interface Type	0.036 Inch Pin
Attachment Method (Shield/Contact)	Field Replaceable
Body Style	Straight
Mount Method	2 Hole Flange

Electrical Specifications

Frequency Range	DC to 26 GHz
Impedance	50 Ohms
Maximum VSWR	1.2:1
Maximum Insertion Loss	0.15 dB
Dielectric Withstanding Voltage	1,000 Vrms

Mechanical Specifications

Temperature

Operating Range	-65 to +125 deg C
-----------------	-------------------

Size

Length	0.625 in [15.88 mm]
Width/Dia.	0.223 in [5.66 mm]
Height	0.375 in [9.53 mm]

Connector

Type	SMA Female
Mating Cycles	500
Contact Material and Plating	Beryllium Copper, Gold
Contact Plating Specification	ASTM B-488
Body Material and Plating	Passivated Stainless Steel
Body Plating Specification	ASTM A-967
Dielectric Type	PTFE

Compliance Certifications (visit www.Pasternack.com for current document)

RoHS Compliant

Click the following link (or enter part number in "SEARCH" on website) to obtain additional part information including price, inventory and certifications: [SMA Female Field Replaceable Connector 2 Hole Flange Mount 0.036 Inch Pin PE45055](#)

PASTER JACK

PE45055

Notes:

- The information contained in this document is accurate to the best of our knowledge and representative of the part described herein. It may be necessary to make modifications to the part and/or the documentation of the part, in order to implement improvements. Pasternack reserves the right to make such changes as required. Unless otherwise stated, all specifications are nominal. Pasternack does not make any representation or warranty regarding the suitability of the part described herein for any particular purpose, and Pasternack does not assume any liability arising out of the use of any part or documentation.

PE45055 CAD Drawing

SMA Female Field Replaceable Connector 2 Hole Flange Mount 0.036 Inch Pin

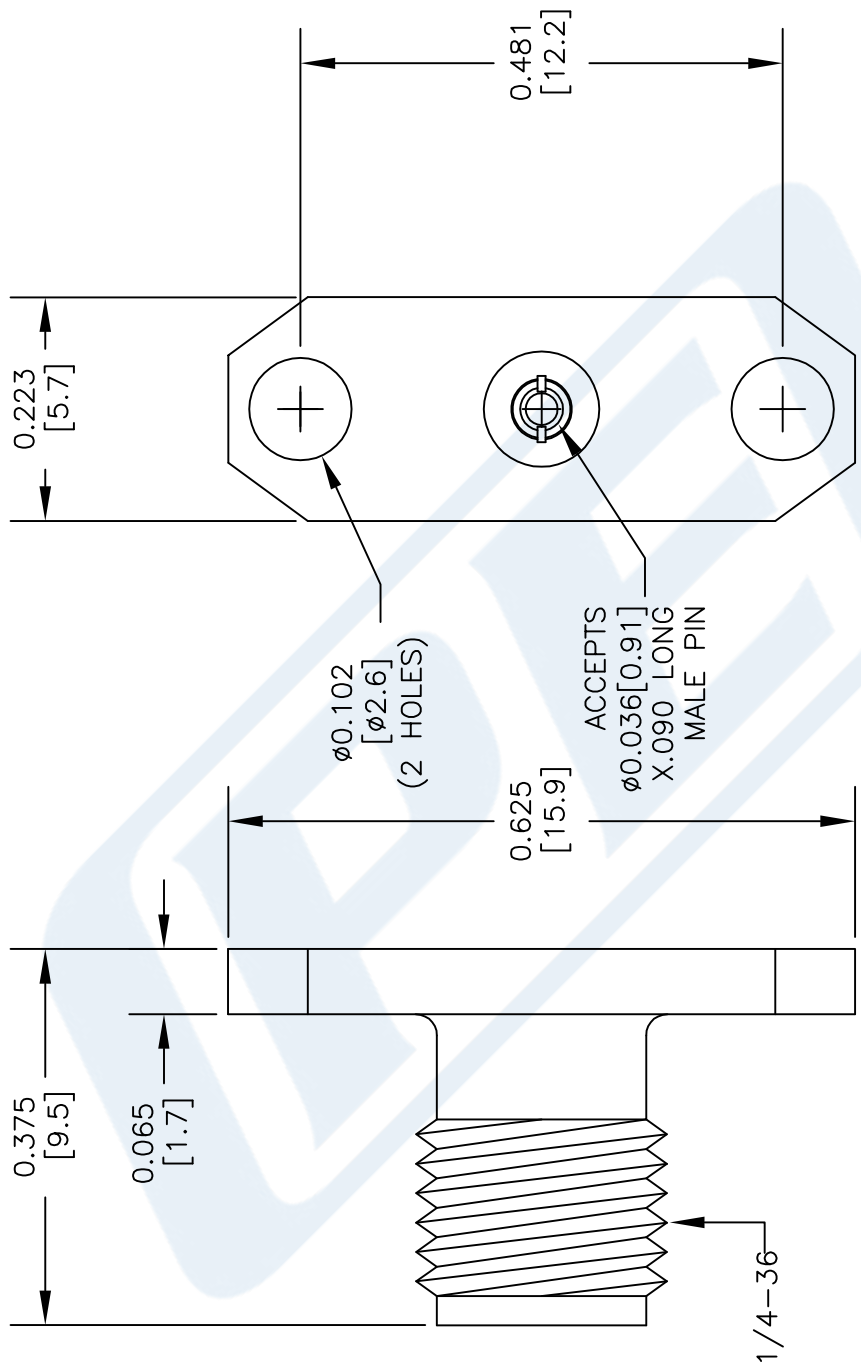

DWG TITLE

PE45055

NOTES:

- 1. UNLESS OTHERWISE SPECIFIED ALL DIMENSIONS ARE NOMINAL.
- 2. ALL SPECIFICATIONS ARE SUBJECT TO CHANGE WITHOUT NOTICE AT ANY TIME.
- 3. DIMENSIONS ARE IN INCHES [mm].

PE PASTERNAK®
THE ENGINEER'S RF SOURCE
Pasternack Enterprises, Inc.
P.O. Box 16759 | Irvine | CA | 92623
Phone: (949) 261-1920 | Fax: (949) 261-7451
Website: www.pasternack.com | E-Mail: sales@pasternack.com

FSCM NO. 53919

CAD FILE 111414

SCALE N/A

SIZE A

150