



QMA Female Bulkhead Connector Crimp/Solder Attachment For RG316-DS, RG188-DS, .268 inch D Hole

TECHNICAL DATA SHEET

PE44508

QMA Female Bulkhead Connector Crimp/Solder Attachment For RG316-DS, RG188-DS, .268 inch D Hole

Configuration

Connector	QMA Female
Connector Interface Type	RG316-DS, RG188-DS
Cable Attachment Method (Shield/Contact)	Crimp/Solder
Body Style	Straight
Mount Method	Bulkhead

Electrical Specifications

Frequency Range, GHz	DC to 18
Impedance, Ohms	50
Maximum Operating Voltage, Volts	350
Dielectric Withstanding Voltage, Vrms	750

Frequency 1

Frequency, GHz	DC to 3
VSWR	1.07:1
Return Loss, dB	30
Insertion Loss, dB	0.087

Frequency 2

Frequency, GHz	3 to 6
VSWR	1.11:1
Return Loss, dB	26
Insertion Loss, dB	0.12

Mechanical Specifications

Temperature

Operating Range, deg C	-40 to +85
Storage Range, deg C	-40 to +85

Size

Length, in [mm]	0.95 [24.13]
Width/Dia., in [mm]	0.43 [10.92]
Weight, lbs [g]	0.006 [2.72]

Connector

Type	QMA Female
Mating Cycles	100
Contact Material and Plating	Beryllium Copper, Gold
Body Material and Plating	Brass, Tri-Metal
Dielectric Type	PTFE

Click the following link (or enter part number in "SEARCH" on website) to obtain additional part information including price, inventory and certifications: [QMA Female Bulkhead Connector Crimp/Solder Attachment For RG316-DS, RG188-DS, .268 inch D Hole PE44508](#)

The information contained in this document is accurate to the best of our knowledge and representative of the part described herein. It may be necessary to make modifications to the part and/or the documentation of the part, in order to implement improvements. Pasternack reserves the right to make such changes as required. Unless otherwise stated, all specifications are nominal.



QMA Female Bulkhead Connector Crimp/Solder Attachment
For RG316-DS, RG188-DS, .268 inch D Hole

TECHNICAL DATA SHEET

PE44508

Compliance Certifications (visit www.Pasternack.com for current document)

RoHS Compliant

Yes

Plotted and Other Data

Notes:

Values at 25 °C, sea level

QMA Female Bulkhead Connector Crimp/Solder Attachment For RG316-DS, RG188-DS, .268 inch D Hole from Pasternack Enterprises has same day shipment for domestic and International orders. Our RF, microwave and fiber optic products maintain a 99% availability and are part of the broadest selection in the industry.

Click the following link (or enter part number in "SEARCH" on website) to obtain additional part information including price, inventory and certifications: [QMA Female Bulkhead Connector Crimp/Solder Attachment For RG316-DS, RG188-DS, .268 inch D Hole PE44508](http://www.pasternack.com/qma-female-standard-rg316-ds-connector-pe44508-p.aspx)

URL: <http://www.pasternack.com/qma-female-standard-rg316-ds-connector-pe44508-p.aspx>

The information contained in this document is accurate to the best of our knowledge and representative of the part described herein. It may be necessary to make modifications to the part and/or the documentation of the part, in order to implement improvements. Pasternack reserves the right to make such changes as required. Unless otherwise stated, all specifications are nominal.

PE44508 CAD Drawing

QMA Female Bulkhead Connector Crimp/Solder Attachment
For RG316-DS, RG188-DS, .268 inch D Hole

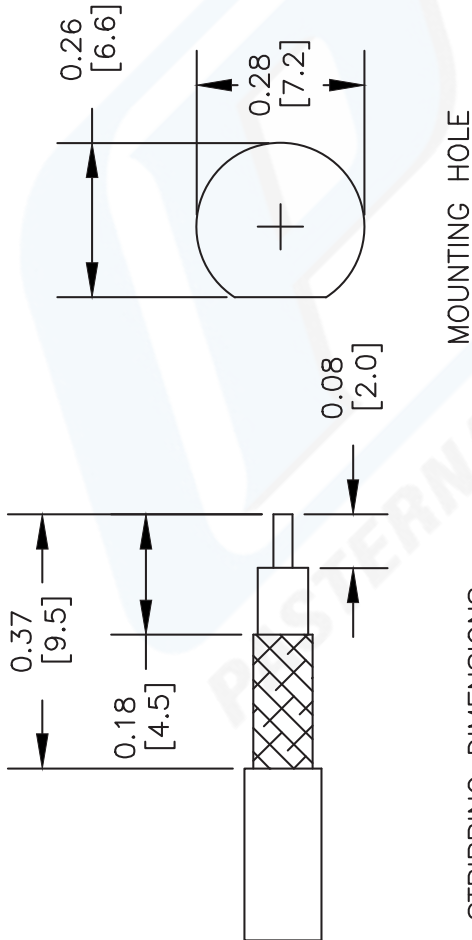
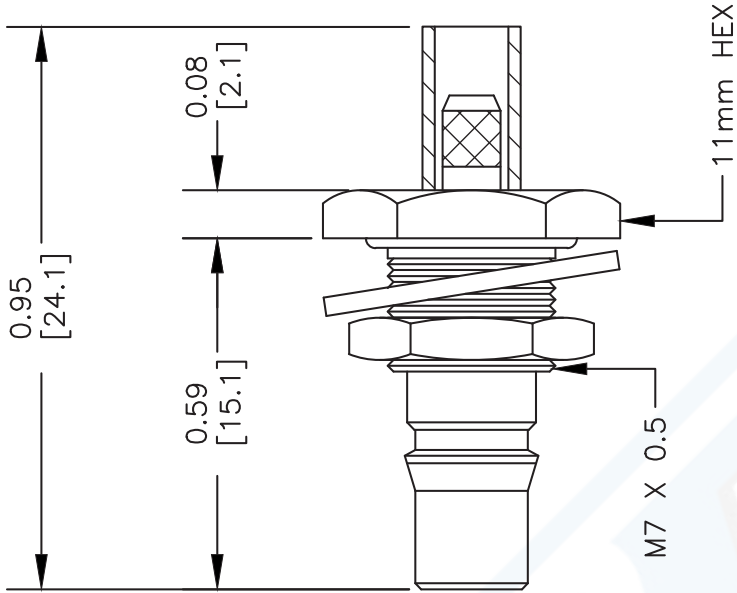

NOTES:
1. UNLESS OTHERWISE SPECIFIED ALL DIMENSIONS ARE NOMINAL.
2. ALL SPECIFICATIONS ARE SUBJECT TO CHANGE WITHOUT NOTICE AT ANY TIME.
3. DIMENSIONS ARE IN INCHES [mm].
4. FITS MIL-C-17 AND EQUIVALENT CABLES.

DWG TITLE
PE44508

FSCM NO. 53919

127

PE PASTERNAK®
Pasternack Enterprises, Inc.
P.O. Box 16759 | Irvine | CA | 92623
Phone: (949) 261-1920 | Fax: (949) 261-7451
Website: www.pasternack.com | E-Mail: sales@pasternack.com