



EUROPEAN ANTENNAS

Excellence through design
Creative in concept



HEMI OMNI ANTENNA

MODEL: HOA2-24L/739

FREQUENCY:	2.3 - 2.6 GHz	GAIN:	2 dBiC
POLARISATION:	Circular (L.H.C)	BEAMWIDTH:	160° Azimuth x 160° Elevation
AXIAL RATIO:	3 dB Typical	VSWR:	1.5:1
POWER RATING:	15 W	FRONT TO BACK:	15 dB
TEMPERATURE:	-20°C to +50°C	MASS:	270 g / 0.59 lbs
FINISH:	Gloss White	WIND LOADING:	1.5 Kg / 3.3 lbs @ 100 mph

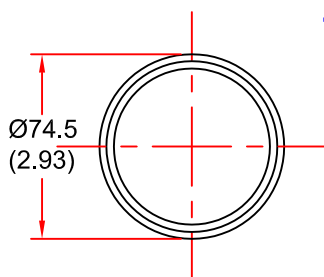

TOP VIEW

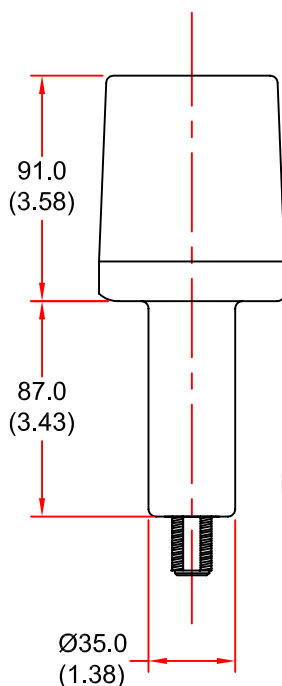

SIDE VIEW

ISOMETRIC VIEW

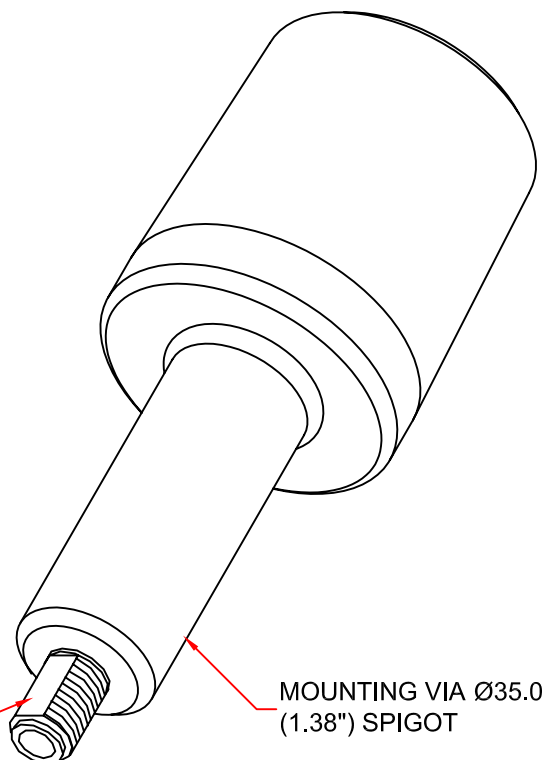

N(F) CONNECTOR

MOUNTING VIA Ø35.0
(1.38") SPIGOT

DIMENSIONS: mm (inches)

GA 739-1 Issued 140900

EUROPEAN ANTENNAS LTD.

LAMBDA HOUSE, CHEVELEY,
NEWMARKET, SUFFOLK, CB8 9RG,
UNITED KINGDOM.

TEL: +44 (0)1638 731888

FAX: +44 (0)1638 731999

E-Mail: sales@european-antennas.co.uk

Website: www.european-antennas.co.uk