



DC Block on Inner and Outer Conductor 50 Ohm 2.92mm Male  
to 2.92mm Female Operating From 10 MHz to 26.5 GHz

## TECHNICAL DATA SHEET

PE8224

### Configuration

Design	Inner/Outer DC Block
Body Style	Straight
Impedance	50 Ohms
Connector 1	2.92mm Male
Connector 2	2.92mm Female

### Electrical Specifications

Frequency Range, GHz	0.01 to 26.5
Impedance, Ohms	50
Maximum VSWR	1.35:1
Maximum Insertion Loss, dB	0.75
Maximum Operating Voltage, Vrms	200

### Mechanical Specifications

#### Size

Length, in [mm]	0.86 [21.84]
Width/Dia., in [mm]	0.5 [12.7]

#### Connector 1

Type	2.92mm Male
------	-------------

#### Connector 2

Type	2.92mm Female
------	---------------

### Compliance Certifications (visit [www.Pasternack.com](http://www.Pasternack.com) for current document)

Not RoHS Compliant

Click the following link (or enter part number in "SEARCH" on website) to obtain additional part information including price, inventory and certifications: [DC Block on Inner and Outer Conductor 50 Ohm 2.92mm Male to 2.92mm Female Operating From 10 MHz to 26.5 GHz PE8224](#)



DC Block on Inner and Outer Conductor 50 Ohm 2.92mm Male  
to 2.92mm Female Operating From 10 MHz to 26.5 GHz

TECHNICAL DATA SHEET

PE8224

**Plotted and Other Data**

Notes:

- Values at +25 °C, sea level

DC Block on Inner and Outer Conductor 50 Ohm 2.92mm Male to 2.92mm Female Operating From 10 MHz to 26.5 GHz from Pasternack Enterprises has same day shipment for domestic and International orders. Our RF, microwave and millimeter wave products maintain a 99% availability and are part of the broadest selection in the industry.

Click the following link (or enter part number in "SEARCH" on website) to obtain additional part information including price, inventory and certifications: [DC Block on Inner and Outer Conductor 50 Ohm 2.92mm Male to 2.92mm Female Operating From 10 MHz to 26.5 GHz PE8224](http://www.pasternack.com/50-ohm-dc-block-292mm-male-to-292mm-female-265-ghz-pe8224-p.aspx)

URL: <http://www.pasternack.com/50-ohm-dc-block-292mm-male-to-292mm-female-265-ghz-pe8224-p.aspx>

The information contained in this document is accurate to the best of our knowledge and representative of the part described herein. It may be necessary to make modifications to the part and/or the documentation of the part, in order to implement improvements. Pasternack reserves the right to make such changes as required. Unless otherwise stated, all specifications are nominal. Pasternack does not make any representation or warranty regarding the suitability of the part described herein for any particular purpose, and Pasternack does not assume any liability arising out of the use of any part or documentation.

PE8224 CAD Drawing

DC Block on Inner and Outer Conductor 50 Ohm 2.92mm Male to  
2.92mm Female Operating From 10 MHz to 26.5 GHz

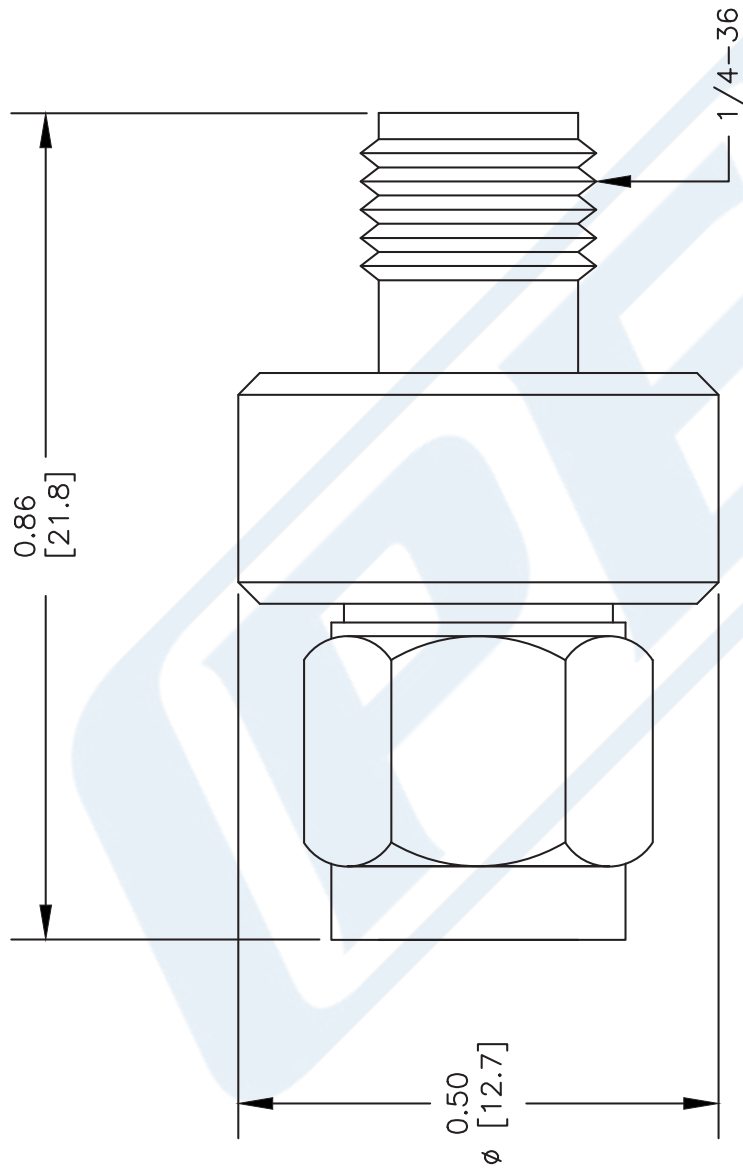

NOTES:  
1. UNLESS OTHERWISE SPECIFIED ALL DIMENSIONS ARE NOMINAL.  
2. ALL SPECIFICATIONS ARE SUBJECT TO CHANGE WITHOUT NOTICE AT ANY TIME.  
3. DIMENSIONS ARE IN INCHES [mm].

DWG TITLE  
**PE8224**

FSCM NO. 53919

CAD FILE 020706

SCALE N/A

SIZE A

127

**PE PASTERNAK®**  
Pasternack Enterprises, Inc.  
P.O. Box 16759 | Irvine | CA | 92623  
Phone: (949) 261-1920 | Fax: (949) 261-7451  
Website: [www.pasternack.com](http://www.pasternack.com) | E-Mail: [sales@pasternack.com](mailto:sales@pasternack.com)