

FAT-PFM5PF5T10G2W2

10 GHz SMP Plug Full Detent To SMP Jack Fixed Attenuator

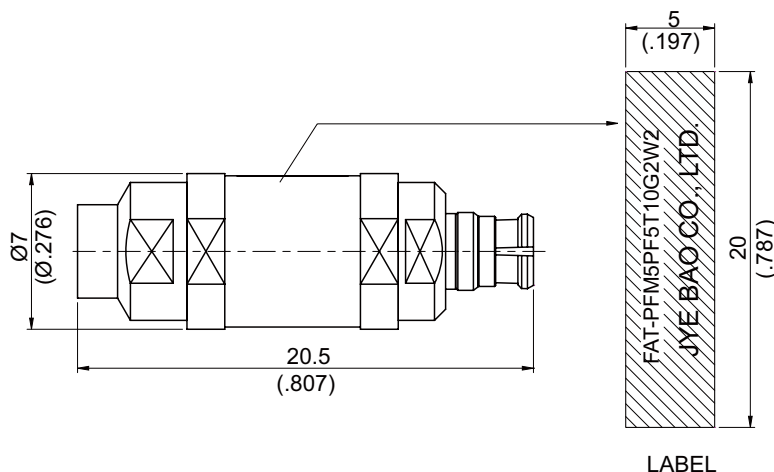

Nominal impedance: 50Ω \pm 0.25Ω over operating temperature range.

Operating temperature range: -50 degrees Celcius to +80 degrees Celcius.

VSWR deviation: \pm 0.1% over operating temperature range.

Power rating: 2W over operating temperature range.

Power Rating (Peak): 100W for 25 Microseconds.

Power Coefficient: 0.001dB/W (change in attenuation with increase in power).

Temperature Coefficient: 0.001dB/Deg. C max., 0.0003dB/Deg.C typ.

Attenuation	VSWR			Attenuation deviation (+/-dB)		
	DC-2GHz	2-5GHz	5-10GHz	DC-2GHz	2-5GHz	5-10GHz
2dB	\leq 1.1	\leq 1.25	\leq 1.35	\pm 0.2dB	\pm 0.3dB	\pm 0.5dB

Parts	Material	Plating (Micro-inch)
Renber Ring	Beryllium Copper	Gold 4 Over Nickel-Phosphorous Alloy 80 Over Copper 20
Female Contact Pin	Beryllium Copper	Gold 4 Over Nickel-Phosphorous Alloy 80 Over Copper 20
Male Contact Pin	Phosphor Bronze	Gold 4 Over Nickel-Phosphorous Alloy 80 Over Copper 20
Insulator	Teflon	
Ferrule	Brass	Tin-Zinc-Copper-Alloy 100 Over Copper 50
Body(Plug Side)	Stainless	Passivated
Body(Jack Side)	Beryllium Copper	Gold 4 Over Nickel-Phosphorous Alloy 80 Over Copper 20

Weight:

This part number complies with RoHS.

Notice: JYEBAO reserves the right to make modifications deemed appropriate.