

75 Ohm F Male Connector Twist Attachment For RG6



TECHNICAL DATA SHEET

PE44314

75 Ohm F Male Connector Twist Attachment For RG6

Configuration

Connector	F Male
Connector Interface Type	RG6
Cable Attachment Method (Shield/Contact)	Twist
Body Style	Straight

Electrical Specifications

Impedance, Ohms	75
-----------------	----

Mechanical Specifications

Size

Length, in [mm]	0.79 [20.07]
Width/Dia., in [mm]	0.438 [11]
Weight, lbs [g]	0.151 [68.49]

Connector

Type	F Male
Coupling Nut Material and Plating	Brass, Nickel
Coupling Nut Plating Specification	100µ in. minimum
Hex Size, in.	7/16
Body Material and Plating	Brass, Nickel
Body Plating Specification	100µ in. minimum

Compliance Certifications (visit www.Pasternack.com for current document)

RoHS Compliant	Yes
----------------	-----

Plotted and Other Data

Notes:	Values at 25 °C, sea level
--------	----------------------------

URL: <http://www.pasternack.com/f-male-standard-rg6-connector-pe44314-p.aspx>

75 Ohm F Male Connector Twist Attachment For RG6 from Pasternack Enterprises has same day shipment for domestic and International orders. We maintain 99% availability of the industry's broadest selection of RF, microwave and fiber optic products.

The information contained in this document is accurate to the best of our knowledge and representative of the part described herein. It may be necessary to make modifications to the part and/or the documentation of the part, in order to implement improvements. Pasternack reserves the right to make such changes as required. Unless otherwise stated, all specifications are nominal.

PE44314 CAD Drawing

75 Ohm F Male Connector Twist Attachment For RG6

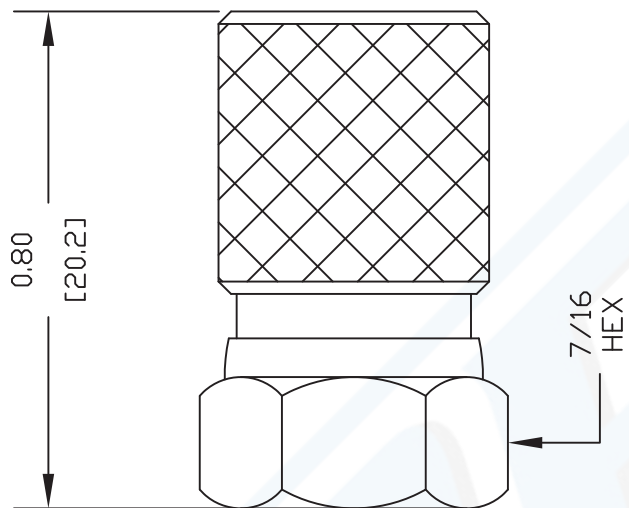

- 1. STRIP CABLE AS SHOWN.
- 2. SCREW CONNECTOR ONTO CABLE UNTIL DIELECTRIC IS FLUSH WITH BODY SHOULDER.

NOTES: 1. UNLESS OTHERWISE SPECIFIED ALL DIMENSIONS ARE NOMINAL. 2. ALL SPECIFICATIONS ARE SUBJECT TO CHANGE WITHOUT NOTICE AT ANY TIME. 3. DIMENSIONS ARE IN INCHES [mm]. 4. FITS MIL-C-17 AND EQUIVALENT CABLES.		DWG TITLE PE44314	
FSCM NO. 53919		CAD FILE 012413-A	SCALE N/A
SIZE A		2231	



PASTERNAK
Pasternack Enterprises, Inc.
P.O. Box 16759 | Irvine | CA | 92623
Phone: (949) 261-1920 | Fax: (949) 261-7451
Website: www.pasternack.com | E-Mail: sales@pasternack.com