

# TECHNICAL DATA SHEET

PE9434

Connector 1	SMA Female
Impedance 1	50 Ohms
Connector Specification 1	MIL-C-39012
Connector 2	N Female
Impedance 2	50 Ohms
Connector Specification 2	MIL-C-39012
Adapter Design	Precision
Body Style	Straight
Mount Method	4 Hole Flange

Frequency Range	DC to 18 GHz
Maximum VSWR	1.15:1

<b>Size</b>	
Length, in [mm]	1.5 [38.1]
Width/Dia., in [mm]	1 [25.4]
Height, in [mm]	1 [25.4]

Type SMA Female

## Type N Female

<b>Temperature</b>	
Operating Range	-65 to +125 deg C

RoHS Compliant  
REACH Compliant

06/18/2012

Pasternack Enterprises, Inc. • P.O. Box 16759, Irvine, CA 92623  
**Phone:** (866) 727-8376 or (949) 261-1920 • **Fax:** (949) 261-7451  
[Sales@Pasternack.com](mailto:Sales@Pasternack.com) • [Techsupport@Pasternack.com](mailto:Techsupport@Pasternack.com)

ISO 9001 : 2008 Registered



# TECHNICAL DATA SHEET

PE9434

Notes:

- The information contained in this document is accurate to the best of our knowledge and representative of the part described herein. It may be necessary to make modifications to the part and/or the documentation of the part, in order to implement improvements. Pasternack reserves the right to make such changes as required. Unless otherwise stated, all specifications are nominal. Pasternack does not make any representation or warranty regarding the suitability of the part described herein for any particular purpose, and Pasternack does not assume any liability arising out of the use of any part or documentation.

PE9434 CAD Drawing

Precision SMA Female to N Female 4 Hole Flange Adapter

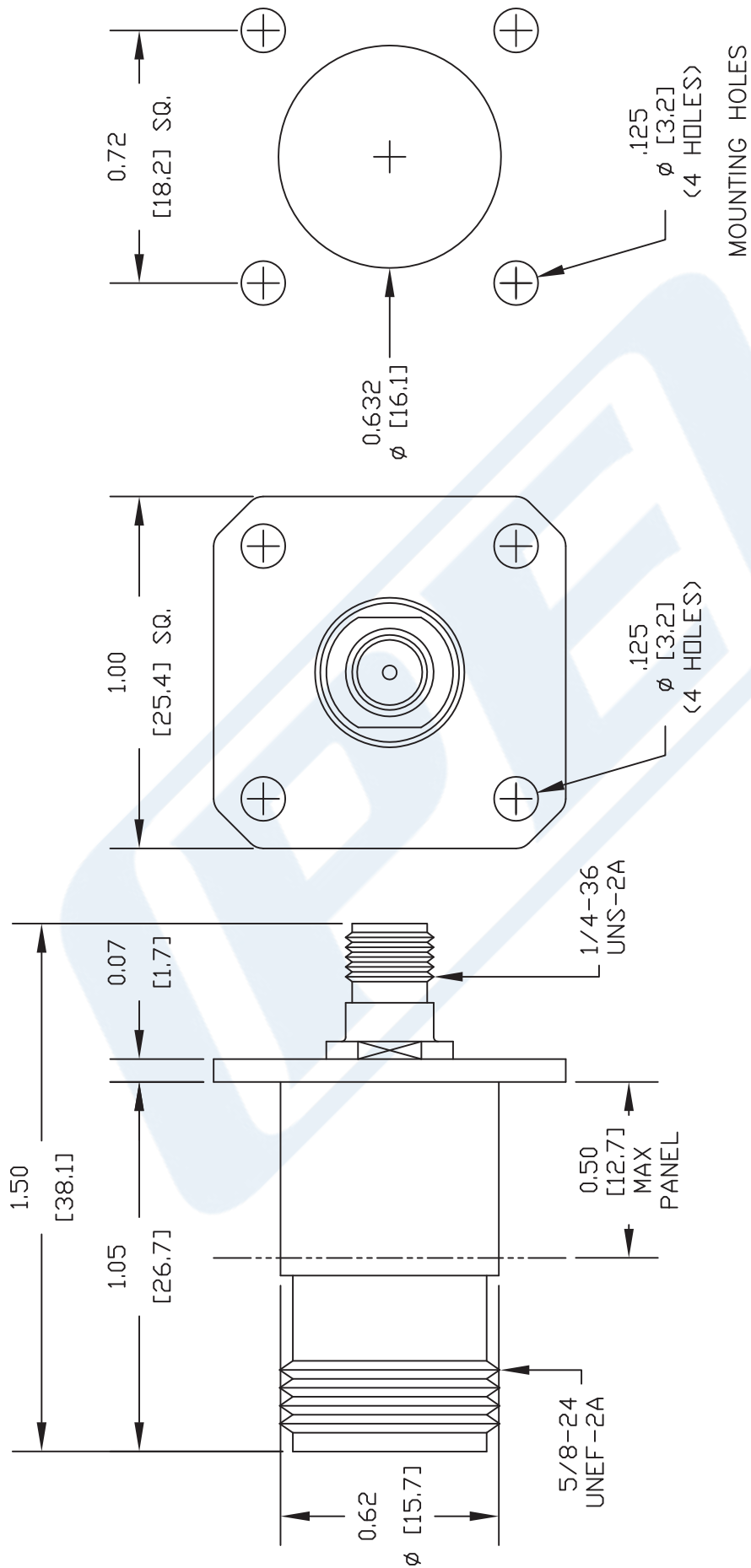

NOTES:  
1. UNLESS OTHERWISE SPECIFIED ALL DIMENSIONS ARE NOMINAL.  
2. ALL SPECIFICATIONS ARE SUBJECT TO CHANGE WITHOUT NOTICE AT ANY TIME.  
3. DIMENSIONS ARE IN INCHES [mm].

DWG TITLE  
**PE9434**

**PE PASTERNAK®**  
Pasternack Enterprises, Inc.  
P.O. Box 16759 | Irvine | CA | 92623  
Phone: (949) 261-1920 | Fax: (949) 261-7451  
Website: [www.pasternack.com](http://www.pasternack.com) | E-Mail: [sales@pasternack.com](mailto:sales@pasternack.com)

REV. B	FSCM NO. 53919	CAD FILE 082911	SCALE N/A	SIZE A	2231
--------	----------------	-----------------	-----------	--------	------