

5000 MHz < Fo < 6000 MHz

Band Pass

Slopes 400 MHz

Bandwidth 500 MHz

WBCQV5-____

Attenuation 30 dB

Specifications

Passband:	____ (Fo) ± 250 MHz = ____ to ____ MHz
Passband Insertion Loss:	0.5 dB max. at Fo (0.75 dB max. at corners)
Passband Return Loss:	14 dB min. (VSWR 1.5:1 max.)
Stopband:	DC to ____ MHz and ____ to 10000 MHz
Stopband Attenuation:	30 dB min.
Operating Temperature:	15 °C to 45 °C
Power Handling:	will be quoted (<i>Please see our warranty in this regard</i>)
Dimensions (L x W x H):	max. 75 x 15 x 35 mm (plus connectors and flanges)
Approx. Weight:	0.1 kg
Mounting Provision:	5 mm flanges on both ends with 2.2 mm holes
Connector 1:	- Please choose -
Connector 2:	- Please choose -

Typical Performance

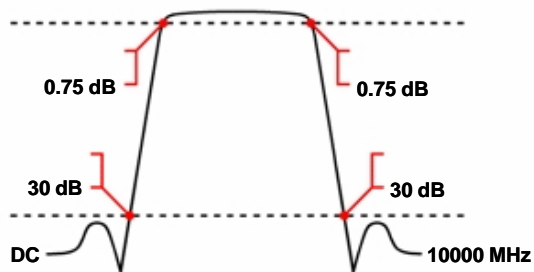

5 Section Cavity Design

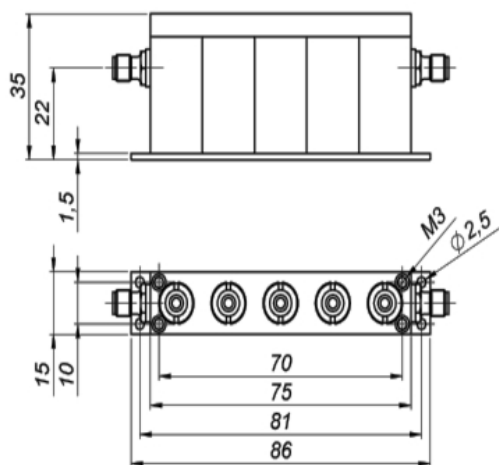

Connector Options

SMA Female
SMA Male
N Female
N Male
Pin
Surface_Mount

Euro Prices

(USD Prices will be quoted for US-based customers only)

1 - 4 pcs:	€ 689
5 - 9 pcs:	€ 637
10 - 24 pcs:	€ 590

Delivery Terms

FCA Andechs (free carrier) according to **Incoterms 2010**
In Deutschland liefern wir frachtfrei gemäß CPT **Incoterms 2010** (unversichert).
Regarding payment terms and warranty see [Terms and Conditions](#).
Delivery time: normally 3 to 4 weeks - depending on quantity ordered and on our work load.

Customer is responsible for observing all applicable export laws in regard to filter application and location of end user



Wainwright Instruments GmbH
www.wainwright-filters.com

Tel: +49 8152 918230
Fax: +49 8152 918255
info@wainwright-filters.com