

5

4

3

2

1

PRODUCTION
RELEASE

REVISIONS
NOTE:
THIS DRAWING INCORPORATES
THIRD ANGLE PROJECTION.
LTR
A
ADDED LENGTH
INTERPRET 1AW ANSI Y14.5-1982

REVISIONS

LTR

DESCRIPTION

DATE

APPROVED

A

ADDED LENGTH

2/17/12

T KUHN

ELECTRICAL
FREQUENCY RANGE

DC-18 GHz

VSWR
DC - 12.4GHz
12.4 - 18GHz

1.20:1 MAX
1.25:1 MAX

INPUT POWER

2 WATTS AVG. @ 25°C
DERATED LINEARLY TO 1 WATT @ 125°C
500 WATTS

PEAK POWER

(50µSec PULSE, .05% DUTY CYCLE)

IMPEDANCE
OPERATING TEMP RANGE

50 OHMS
-65°C TO +125°C

MECHANICAL
TYPE N CONNECTOR
CONDUCTORS

PASSIVATED STAINLESS STEEL
GOLD PLATED BERYLLIUM COPPER

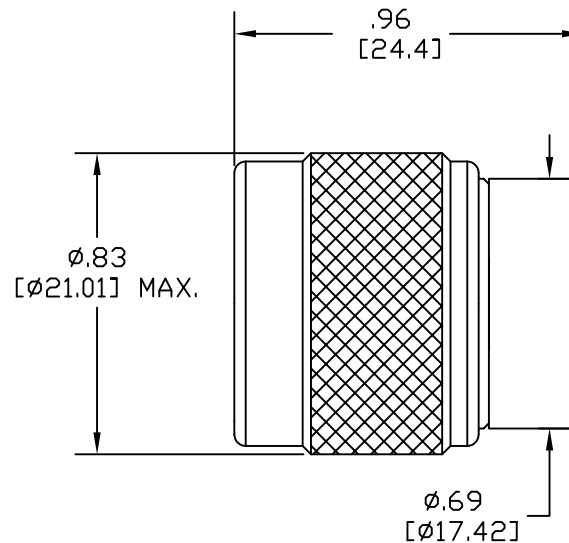

DRAWING PRACTICES PER ANSI-Y-14.5
MIL-STD-100 & 1000

DIMENSIONS ARE IN INCHES AND
APPLY BEFORE/AFTER PROCESSING
SURFACE
63

FINISH
SEE NOTES

MATERIAL
SEE NOTES

UNLESS OTHERWISE SPECIFIED

TOLERANCES IN:

DECIMALS INCH MM

.X" .03" [.76]

.XX" .030" [.25]

.XXX" .005 [.127]

.XXXX" .0005" [.013]

ANGLES ±0°30'

REMOVE ALL BURRS/SHARP W/

BREAK / R OF .003" TO .0005"

UNLESS OTHERWISE NOTED

DIAS CONCENTRIC <.003 T.I.R.

DRAWN

A. Gagne 10/12/10

CHECKED

DATE

ENG.

DATE

THESE DRAWINGS AND

SPECIFICATIONS ARE THE PROPERTY

OF XMA CORP. OR OMNI SPECTRA

AND SHALL NOT BE REPRODUCED,

COPIED NOR USED - IN WHOLE OR IN

PART - AS A BASIS FOR THE

MANUFACTURE OR SALE OF OTHER

ITEMS WITHOUT THE EXPRESS

WRITTEN PERMISSION OF XMA CORP.

NO.

XMA Omni Spectra™

150 Dow Street, Manchester, NH 03101 P:603-222-2256 F:603-222-2259

TITLE
TERMINATION, TYPE N, MALE
2 WATT, DC-18GHz

SIZE B CAGE CODE 3HT76 DRAWING NUMBER 3001-7010-02

SCALE 3:1 PLATED AREA XXX SHEET 1 OF 1

5

4

3

2

1

BCSI