



50 dB Fixed Attenuator, N Female To 7/16 DIN  
Female Rated To 25 Watts Up To 6 GHz

TECHNICAL DATA SHEET

PE7369-50

**50 dB Fixed Attenuator, N Female To 7/16 DIN Female Rated To 25 Watts Up To 6 GHz**

**Configuration**

Design	Fixed, Bidirectional Attenuator
Connector 1	N Female
Connector 2	7/16 DIN Female
Body Material and Plating	Aluminum Heatsink, Black Anodized

**Electrical Specifications**

Frequency Range, GHz	DC to 6
Impedance, Ohms	50
Attenuation Value, dB	50 to 50
Maximum Input Power, Watts	25
Maximum VSWR	1.3:1

**Frequency 1**

Range, GHz	DC to 6
Insertion Loss, dB	50
VSWR	1.3:1
Attenuation Accuracy, dB	1.25
Maximum Input Power, Watts	25

**Frequency 2**

**Mechanical Specifications**

**Temperature**

Operating Range, deg C	-55 to +125
------------------------	-------------

**Size**

Length, in [mm]	4.5 [114.3]
Width, in [mm]	2.41 [61.21]
Weight, lbs [g]	0.8 [362.87]

**Connector 1**

Type	N Female
Contact Material and Plating	Brass, Gold
Contact Plating Specification	Silver
Hex Size, In.	11/16
Body Material and Plating	Stainless Steel, Passivated
Body Plating Specification	Passivated

Click the following link (or enter part number in "SEARCH" on website) to obtain additional part information including price, inventory and certifications: [50 dB Fixed Attenuator, N Female To 7/16 DIN Female Rated To 25 Watts Up To 6 GHz PE7369-50](#)

The information contained in this document is accurate to the best of our knowledge and representative of the part described herein. It may be necessary to make modifications to the part and/or the documentation of the part, in order to implement improvements. Pasternack reserves the right to make such changes as required. Unless otherwise stated, all specifications are nominal.



50 dB Fixed Attenuator, N Female To 7/16 DIN  
Female Rated To 25 Watts Up To 6 GHz

TECHNICAL DATA SHEET

PE7369-50

**Connector 2**

Type	7/16 DIN Female
Contact Material and Plating	Brass, Silver
Outer Conductor Material and Plating	Brass, Silver
Hex Size, In.	11/16
Body Material and Plating	Brass, Silver

**Compliance Certifications** (visit [www.Pasternack.com](http://www.Pasternack.com) for current document)

RoHS Compliant	Yes
----------------	-----

**Plotted and Other Data**

Notes: Values at 25 °C, sea level

URL: <http://www.pasternack.com/50db-fixed-n-female-7-16-female-25-watts-attenuator-pe7369-50-p.aspx>

50 dB Fixed Attenuator, N Female To 7/16 DIN Female Rated To 25 Watts Up To 6 GHz from Pasternack Enterprises has same day shipment for domestic and International orders. Our RF, microwave and fiber optic products maintain a 99% availability and are part of the broadest selection in the industry.

The information contained in this document is accurate to the best of our knowledge and representative of the part described herein. It may be necessary to make modifications to the part and/or the documentation of the part, in order to implement improvements. Pasternack reserves the right to make such changes as required. Unless otherwise stated, all specifications are nominal.

# PE7369-50 CAD Drawing

50 dB Fixed Attenuator, N Female To 7/16 DIN Female Rated To 25 Watts Up To 6 GHz

Table of Information	
Connector Type	DIM "A" (REF.)
SMA Male	0.68
SMA Female	0.54
TNC Male	0.98
TNC Female	0.94
N Female	0.95
N Male	0.98
7/16 Male	1.12
7/16 Female	1.16

Part Number Configuration		
xx	Input Connector	Output Connector
55	SMA Male	7/16 Female
56	SMA Male	N Female
57	SMA Male	SMA Female
58	SMA Male	TNC Female
59	SMA Female	7/16 Female
60	SMA Female	7/16 Male
61	SMA Female	N Female
62	SMA Female	N Male
63	SMA Female	SMA Female
64	SMA Female	TNC Female
65	SMA Female	TNC Male
66	N Male	7/16 Female
67	N Male	N Female
68	N Male	TNC Female
69	N Female	7/16 Female
70	N Female	7/16 Male
71	N Female	N Female
72	N Female	TNC Female
73	N Female	TNC Male
74	TNC Male	TNC Female
75	TNC Male	SMA Male
76	TNC Female	7/16 Female
77	TNC Female	7/16 Male
78	TNC Female	TNC Female
79	7/16 Male	7/16 Female
80	7/16 Female	7/16 Female
-yy	Indicates Attenuation Level	

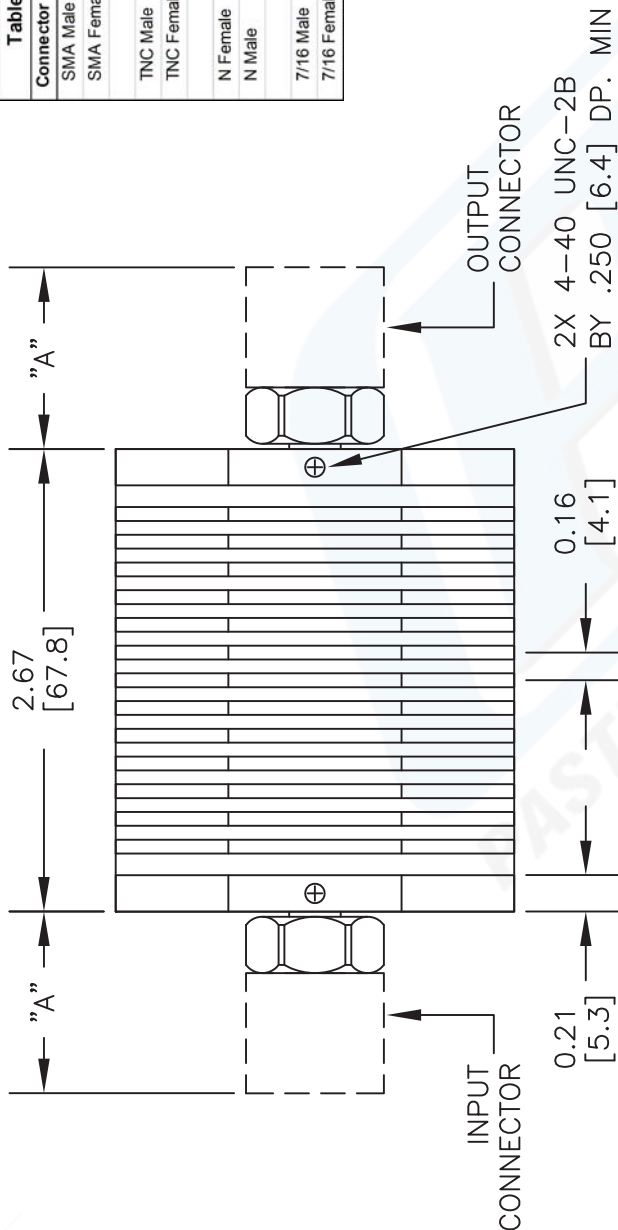

SIDE VIEW

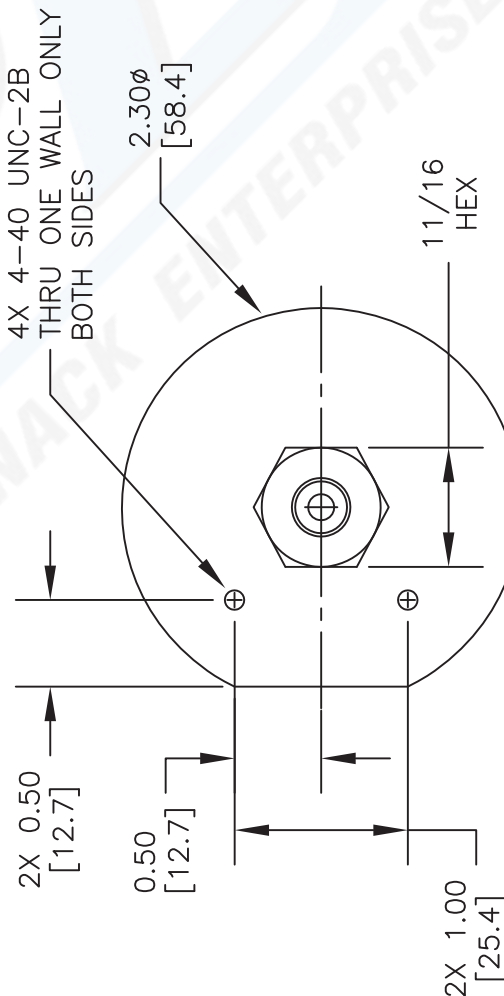

RIGHT VIEW



Pasternack Enterprises, Inc.  
P.O. Box 16759 | Irvine | CA | 92623  
Phone: (949) 261-1920 | Fax: (949) 261-7451  
Website: www.pasternack.com | E-Mail: sales@pasternack.com

DWG TITLE

**PE73xx-yy**

NOTES:  
1. UNLESS OTHERWISE SPECIFIED ALL DIMENSIONS ARE NOMINAL.  
2. ALL SPECIFICATIONS ARE SUBJECT TO CHANGE WITHOUT NOTICE AT ANY TIME.  
3. DIMENSIONS ARE IN INCHES [mm].

FSCM NO. 53919

CAD FILE 102512

SCALE N/A

SIZE A

2233