

MECHANICAL CHARACTERISTICS	
INTERFACE	MIL-STD-348, FIG. 310-1
IN ACCORDANCE WITH THE INTENT OF SLANT SHEET	MIL-PRF-39012/56 REF.
RECOMMENDED MATING TORQUE	9 IN-LBS. NOM.
COUPLING PROOF TORQUE	15 IN-LBS. MIN.
COUPLING NUT RETENTION	60 LBS. MIN.
FORCE TO ENGAGE	2 IN-LBS. MAX.
FORCE TO DISENGAGE	2 IN-LBS. MAX.
DURABILITY	500 CYCLES MIN.
AXIAL CONTACT RETENTION (FROM INTERFACE)	6 LBS. MIN.
CABLE RETENTION	10 LBS. MIN.
MASS	6.70 GRAMS NOM.
ELECTRICAL CHARACTERISTICS	
IMPEDANCE	50 Ohms NOM.
MAXIMUM FREQUENCY	18 GHz
VSWR DC - 12.4 GHz	1.12:1 MAX.
12.4 - 18.0 GHz	1.16:1 MAX
INSERTION LOSS	0.04 √F (GHz) dB MAX.
DIELECTRIC WITHSTANDING VOLTAGE	750 Vrms MIN.
INSULATION RESISTANCE	5000 MegaOhms MIN.
RF LEAKAGE DC - 18 GHz	-90 dB MIN.
CORONA	200 Vrms MIN. @ 70,000 FEET
RF HIGH POTENTIAL	500 Vrms MIN.
CONTACT RESISTANCE (INNER)	4.0 MilliOhms MAX.
CONTACT RESISTANCE (OUTER)	2.0 MilliOhms MAX.
ENVIRONMENTAL CHARACTERISTICS	
OPERATING TEMPERATURE	-62 °C TO 165 °C
VIBRATION	MIL-STD-202, METHOD 204, CONDITION D
MECHANICAL SHOCK	MIL-STD-202, METHOD 213, CONDITION I
THERMAL SHOCK	MIL-STD-202, METHOD 107, CONDITION B
MOISTURE RESISTANCE	MIL-STD-202, METHOD 106, CONDITION (NO VIBRATION)
CORROSION	MIL-STD-202, METHOD 101, CONDITION B, 5%
MATERIALS AND FINISH	
BODY, COUPLING NUT	STEEL, CORROSION RESISTANT, ASTM-A-582, UNS NO. S30300, PASSIVATED PER ASTM-A-967
CONTACTS, CLAMP NUT	BERYLLIUM COPPER, ASTM-B-196 GOLD PLATED PER MIL-DTL-45204, OVER NICKEL PLATE PER AMS-QQ-N-290.
DIELECTRIC STOP	POLYETHERIMIDE THERMOPLASTIC PER ASTM-D-5205
DIELECTRIC BEAD	POLYPHENYLENE SULFIDE (PPS), PERASTM-D-6358
SNAP RING	BERYLLIUM COPPER, PER ASTM-B-197
INSULATORS	TFE FLUOROCARBON PER ASTM-D-1710
GASKET	SILICONE RUBBER PER ZZ-R-765
APPLICATION	
CABLE(S)	UFB147B
INSTALLATION	PER CONFIGURATOR

THIS DRAWING IS PROPRIETARY AND CONFIDENTIAL.

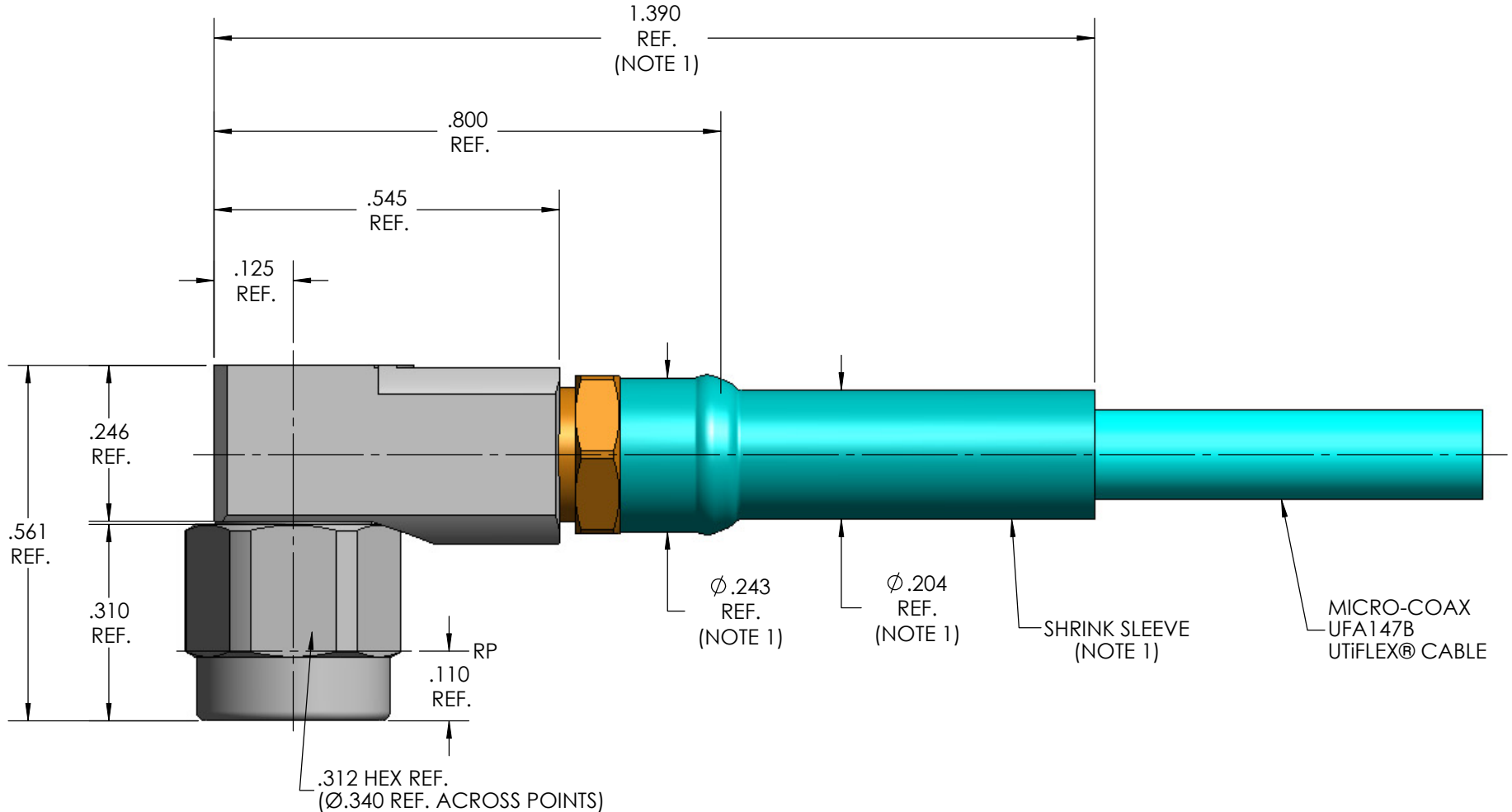
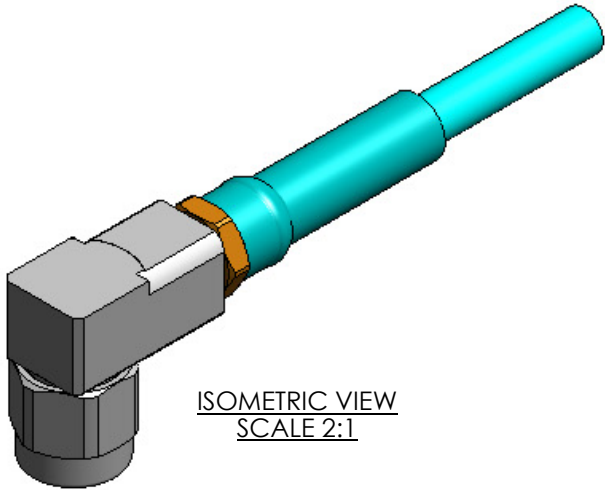

NOTE:

1. MARKER LOCATION ON THIS DRAWING IS FOR REFERENCE ONLY AND IS SUBJECT TO CHANGE WITHOUT NOTICE.

REV	DESCRIPTION	DATE	BY	APPVD	CHKD
A	ECO 85387	7/1/2008	MJM	NDS	NDS
B	ECO 135237	4/30/2013	MJM	RS	CCF

SPECIFICATION DRAWING

THIS SPECIFICATION IS THE PROPERTY OF MICRO-COAX, INC. AND MAY NOT BE USED OR COPIED WITHOUT THE EXPRESS WRITTEN PERMISSION OF MICRO-COAX, INC.		INITIALS		DATE		<div>MICRO-COAX[®] <i>Leading the way in transmission line solutions.</i> <i>Copyright Micro-Coax, Inc.</i></div>													
		DWN.	MJM	6/13/08															
		CHKD.	CCF	5/3/13															
		APPVD.																	
TOLERANCES UNLESS OTHERWISE SPECIFIED		TITLE								SMA PLUG, MITER RIGHT ANGLE, UFA147B									
.XX		± .02		ALL DIMENSIONS IN INCHES UNLESS OTHERWISE SPECIFIED. SCREW THDS. TO BE IN ACCORD WITH ANSI B1.1-1989.				FSCM NO. 64639		SIZE B		SCALE 4:1		SHEET NO. 1 OF 1		DRAWING NO. SD904882		REV B	
.XXX		± .005																	
.XXXX		± .0010																	
ANGLES		± 2°																	