



Low PIM 7/16 DIN Female to 7/16 DIN Female Bulkhead Adapter Low VSWR

TECHNICAL DATA SHEET

PE91038

Low PIM 7/16 DIN Female to 7/16 DIN Female Bulkhead Adapter Low VSWR

- PIM levels <-165 dBc
- Low VSWR levels up to 8GHz
- Tri-metal coating provides a durable surface with good corrosion protection abrasion resistance and superior electrical contact properties.
- Available in various connector combinations including 7/16 DIN in-series, Type N in-series, and 7/16 DIN to Type N and SMA between series
- 4-hole flange and bulkhead mount styles available
- Ideal choice for use in portable PIM testing applications

Configuration

Connector 1	7/16 DIN Female
Impedance 1	50 Ohms
Connector Specification 1	IEC 169-4 (0.232 dia. Enhancement)
Connector 2	7/16 DIN Female
Impedance 2	50 Ohms
Connector Specification 2	IEC 169-4 (0.232 dia. Enhancement)
Adapter Design	Low PIM
Body Style	Straight
Mount Method	Bulkhead

Electrical Specifications

Frequency Range, GHz	DC to 8
Maximum VSWR	1.2:1
Dielectric Withstanding Voltage, Vrms	3,500
Maximum Passive Intermodulation (2 x 20 Watts), dBc	-165

Frequency 1

Frequency, MHz	DC to 1,000
VSWR	1.03:1
Return Loss, dB	38

Frequency 2

Frequency, GHz	1 to 5
VSWR	1.08:1
Return Loss, dB	28

Frequency 3

Frequency, GHz	5 to 8
VSWR	1.2:1
Return Loss, dB	21

Click the following link (or enter part number in "SEARCH" on website) to obtain additional part information including price, inventory and certifications: [Low PIM 7/16 DIN Female to 7/16 DIN Female Bulkhead Adapter Low VSWR PE91038](#)

The information contained in this document is accurate to the best of our knowledge and representative of the part described herein. It may be necessary to make modifications to the part and/or the documentation of the part, in order to implement improvements. Pasternack reserves the right to make such changes as required. Unless otherwise stated, all specifications are nominal.



Low PIM 7/16 DIN Female to 7/16 DIN Female Bulkhead Adapter Low VSWR

TECHNICAL DATA SHEET

PE91038

Mechanical Specifications

Temperature

Operating Range, deg C -40 to +125

Size

Length, in [mm] 1.99 [50.55]
 Width/Dia., in [mm] 1.57 [39.88]
 Weight, lbs [g] 0.51 [231.33]

Connector 1

Type 7/16 DIN Female
 Mating Cycles 500
 Inner Conductor Material and Plating Phosphor Bronze, Silver
 Inner Conductor Plating Specification 200 [5] μ in. [μ m] minimum
 Body Material and Plating Brass, Tri-Metal
 Body Plating Specification 100 [2.54] μ in. [μ m] minimum
 Dielectric Type PTFE

Connector 2

Type 7/16 DIN Female
 Mating Cycles 500
 Inner Conductor Material and Plating Phosphor Bronze, Silver
 Inner Conductor Plating Specification 200 [5] μ in. [μ m] minimum
 Body Material and Plating Brass, Tri-Metal
 Body Plating Specification 100 [2.54] μ in. [μ m] minimum
 Dielectric Type PTFE

Compliance Certifications (visit www.Pasternack.com for current document)

RoHS Compliant Yes

Plotted and Other Data

Notes: Values at 25 °C, sea level

Low PIM 7/16 DIN Female to 7/16 DIN Female Bulkhead Adapter Low VSWR from Pasternack Enterprises has same day shipment for domestic and International orders. Our RF, microwave and fiber optic products maintain a 99% availability and are part of the broadest selection in the industry.

Click the following link (or enter part number in "SEARCH" on website) to obtain additional part information including price, inventory and certifications: [Low PIM 7/16 DIN Female to 7/16 DIN Female Bulkhead Adapter Low VSWR PE91038](http://www.pasternack.com/7-16-female-7-16-female-straight-adapter-pe91038-p.aspx)

URL: <http://www.pasternack.com/7-16-female-7-16-female-straight-adapter-pe91038-p.aspx>

The information contained in this document is accurate to the best of our knowledge and representative of the part described herein. It may be necessary to make modifications to the part and/or the documentation of the part, in order to implement improvements. Pasternack reserves the right to make such changes as required. Unless otherwise stated, all specifications are nominal.

PE91038 CAD Drawing

Low PIM 7/16 DIN Female to 7/16 DIN Female Bulkhead Adapter Low VSWR

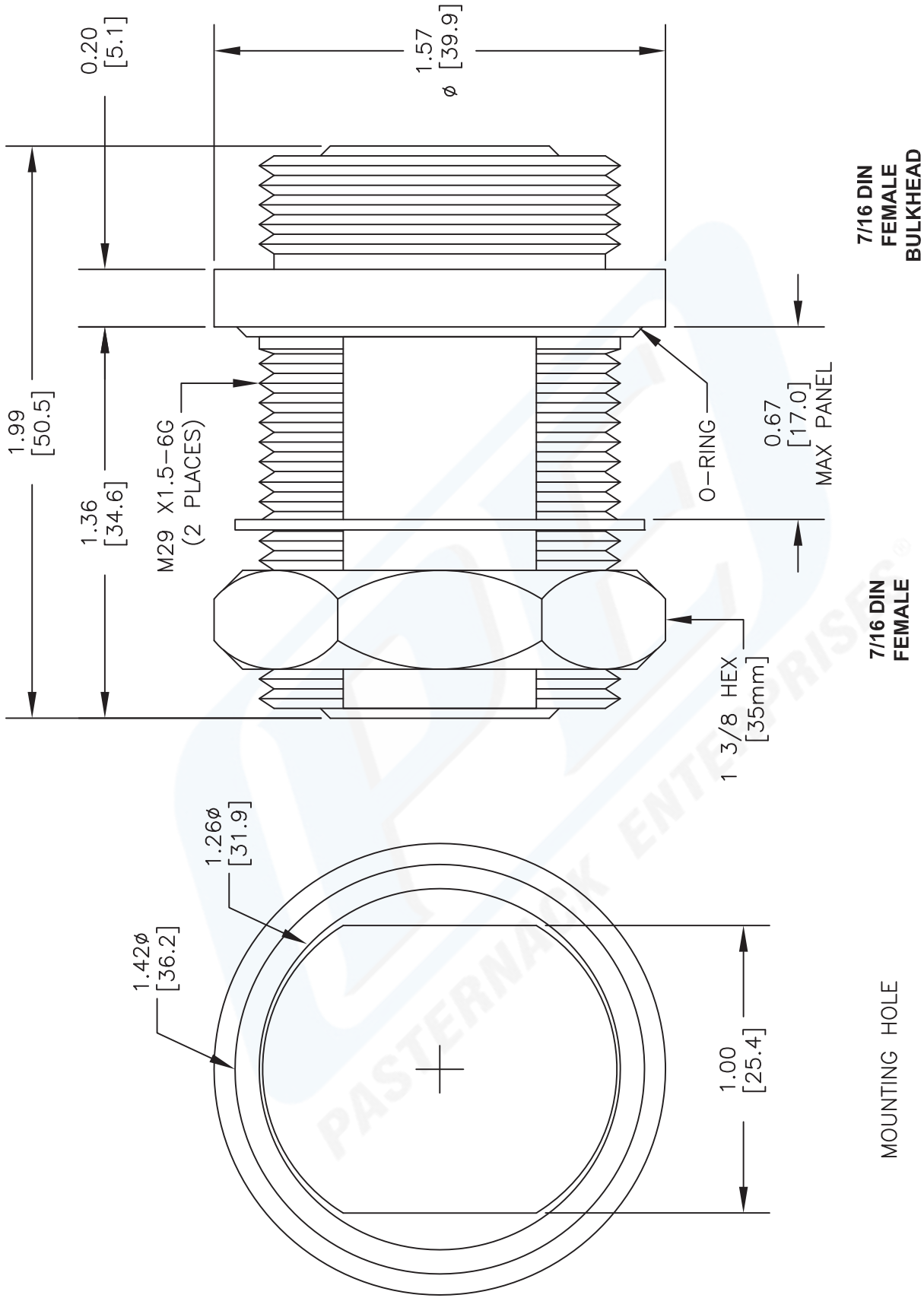

NOTES:
1. UNLESS OTHERWISE SPECIFIED ALL DIMENSIONS ARE NOMINAL.
2. ALL SPECIFICATIONS ARE SUBJECT TO CHANGE WITHOUT NOTICE AT ANY TIME.
3. DIMENSIONS ARE IN INCHES [mm].

DWG TITLE
PE91038

PASTERNAK ENTERPRISES, INC.
P.O. BOX 16759, IRVINE, CA 92623
PHONE (949) 261-1920 FAX (949) 261-7451
WEB ADDRESS: www.pasternack.com
E-MAIL ADDRESS: sales@pasternack.com
COAXIAL & FIBER OPTICS



2233

SIZE A

SCALE N/A

CAD FILE 050312

FSCM NO. 53919

REV. -