

# ADAPTERS, BETWEEN SERIES 2.4mm / 2.9mm

DC - 40 GHz

**api**   
technologies corp.  
> INMET

MODELS: 5151, 5152, 5153, 5154

## SPECIFICATIONS:

### Electrical:

Frequency Range \_\_\_\_\_ DC - 40 GHz

VSWR

DC - 18 GHz \_\_\_\_\_ 1.10:1 Max.

18 - 26.5 GHz \_\_\_\_\_ 1.20:1 Max.

26.5 - 40 GHz \_\_\_\_\_ 1.30:1 Max.

Impedance \_\_\_\_\_ 50 Ohms

Operating Temp. Range \_\_\_\_\_ -65°C to +125°C

### Mechanical:

2.4mm Connectors \_\_\_\_\_ Passivated Stainless Steel

Mates with MIL-STD-348

2.9mm Connectors \_\_\_\_\_ Passivated Stainless Steel

Mates both Mechanically & Electrically with  
all SMA, K\* & 3.5mm Series Connectors.

Conductors \_\_\_\_\_ Gold Plated Beryllium Copper

K\* is a trademark of Wiltron Corp.

Model Number: **5154**

2.4mm Male / 2.9mm Male

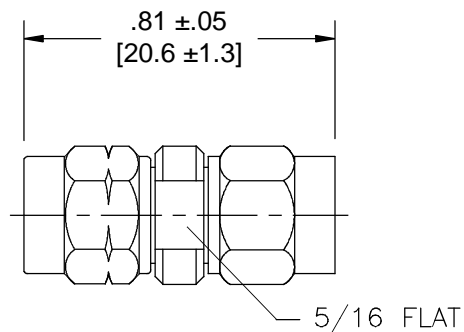

Model Number: **5153**

2.4mm Male / 2.9mm Female

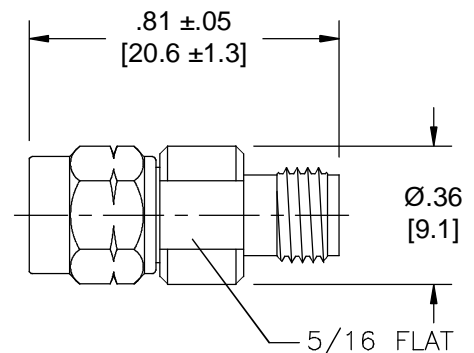

Model Number: **5152**

2.4mm Female / 2.9mm Male

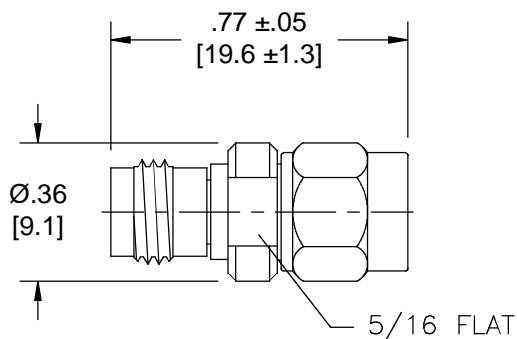

Model Number: **5151**

2.4mm Female / 2.9mm Female

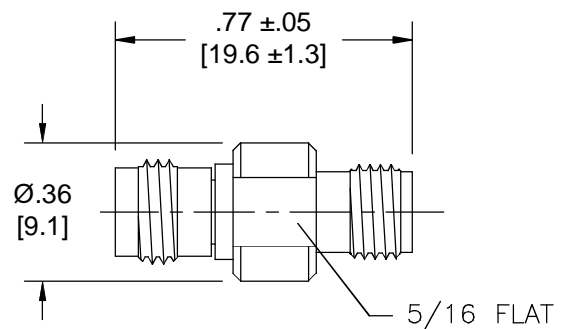

Note: Dimensions in Brackets are Expressed in Millimeters and are for Reference Only.

Design specifications are subject to change without notice.

Contact factory for technical specifications before purchasing or use.

5154; REV C

300 Dino Drive • Ann Arbor, MI 48103-9457 U.S.A. • 888-244-6638 or 734-426-5553 • FAX 734-426-5557 • inmet.apitech.com