

# ADAPTER, BETWEEN SERIES 2.4mm / SMA

## DC - 26.5 GHz

**api**   
technologies corp.  
> INMET

MODELS: 5080, 5081, 5082, 5083

### SPECIFICATIONS:

#### Electrical:

Frequency Range \_\_\_\_\_ DC — 26.5 GHz  
VSWR \_\_\_\_\_ 1.20:1 Max.  
Impedance \_\_\_\_\_ 50 Ohms  
Operating Temp. Range \_\_\_\_\_ -65°C to +125°C

#### Mechanical:

2.4mm Connectors \_\_\_\_\_ Passivated Stainless Steel  
(Mates with 1.85mm & V\* Connectors)  
SMA Connectors \_\_\_\_\_ Passivated Stainless Steel  
(Mates with MIL-STD-348)  
Conductors \_\_\_\_\_ Gold Plated Beryllium Copper

\*V is a trademark of Anritsu Corp.

Model Number: **5080**  
2.4mm MALE / SMA MALE

Model Number: **5082**  
2.4mm MALE / SMA FEMALE

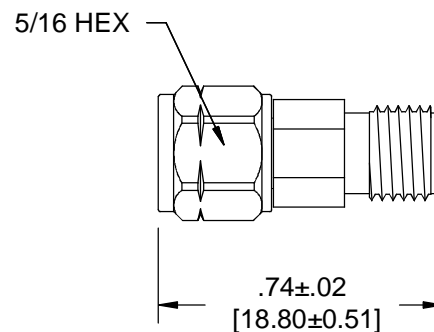
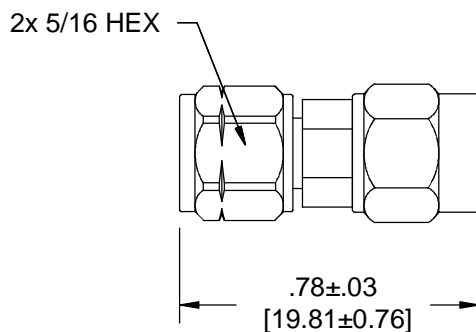

Model Number: **5081**  
2.4mm FEMALE / SMA MALE

Model Number: **5083**  
2.4mm FEMALE / SMA FEMALE

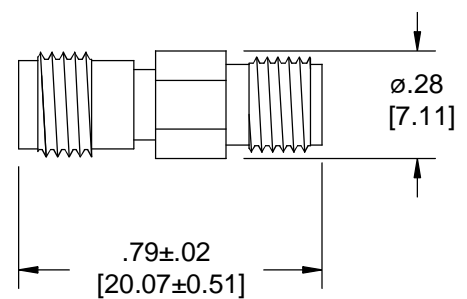
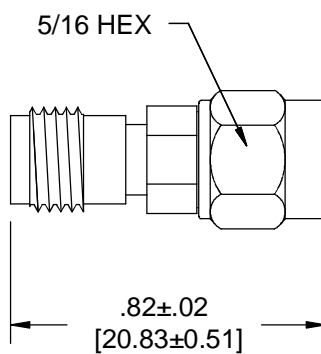

Note: Dimensions in Brackets are Expressed in Millimeters and are for Reference Only.  
Design specifications are subject to change without notice.  
Contact factory for technical specifications before purchasing or use.