

MECHANICAL CHARACTERISTICS	
INTERFACE	MIL-STD-348, FIGURE 310-1
RECOMMENDED MATING TORQUE	9 IN-LBS. NOM.
COUPLING PROOF TORQUE	15 IN-LBS. MIN.
COUPLING NUT RETENTION	60 LBS. MIN.
FORCE TO ENGAGE	2 IN-LBS. MIN.
FORCE TO DISENGAGE	2 IN-LBS. MIN.
DURABILITY	500 CYCLES MIN.
AXIAL CONTACT RETENTION (FROM INTERFACE)	6 LBS. MIN.
AXIAL CONTACT RETENTION (FROM CABLE)	6 LBS. MIN.
CENTER CONTACT INSERTION (FROM CABLE)	TBS
CENTER CONTACT WITHDRAWL (FROM CABLE)	TBS
CABLE RETENTION	20 LBS. MIN.
MASS	12.8 GRAMS NOM.
ELECTRICAL CHARACTERISTICS	
IMPEDANCE	50 Ohms. NOM.
MAXIMUM FREQUENCY	18 GHz
VSWR DC - 18 GHz	1.16:1 MAX.
INSERTION LOSS	0.03 √F (GHz) dB MAX.
DIELECTRIC WITHSTANDING VOLTAGE	1500 Vrms MIN.
INSULATION RESISTANCE	5000 MegaOhms MIN.
RF LEAKAGE DC - 18 GHz	-90 dB
CORONA	375 Vrms. MIN. @ 70,000 FEET
RF HIGH POTENTIAL	1000 Vrms. MIN.
CONTACT RESISTANCE (INNER)	3.0 MilliOhms MAX.
CONTACT RESISTANCE (OUTER)	2.0 MilliOhms MAX.
ENVIRONMENTAL CHARACTERISTICS	
OPERATING TEMPERATURE	-65°C TO +165°C
VIBRATION	MIL-STD-202, METHOD 204, CONDITION D
MECHANICAL SHOCK	MIL-STD-202, METHOD 213, CONDITION I
THERMAL SHOCK	MIL-STD-202, METHOD 107, CONDITION B
MOISTURE RESISTANCE	MIL-STD-202, METHOD 106, CONDITION (NO VIBRATION)
CORROSION	MIL-STD-202, METHOD 101, CONDITION B, 5%
MATERIAL AND FINISH	
CONTACT	BERYLLIUM COPPER, UNS NO. C17300, PER ASTM-B-196 GOLD PLATE PER MIL-G-45204, 50 MICROINCH MIN., OVER NICKEL PLATE PER QQ-N-290, 50 MICROINCHES THK. MIN.
BODY, COUPLING NUT, CLAMP NUT	STEEL, CORROSION RESISTANT, CONDITION A, NON-MAGNETIC PER ASTM-A-582, UNS NO. S30300 PASSIVATE PER ASTM-A-967
CONTACT RING	BRASS, UNS NO. C36000, PER ASTM-B-16
SNAP RING	BERYLLIUM COPPER, UNS NO. C17200, PER ASTM-B-197
DIELECTRIC BEAD	(ULTEM 1000) PER ASTM-D-5205
GASKET	SILICON RUBBER PER ZZ-R-765
INSULATOR	TFE FLUOROCARBON PER ASTM-D-1710
APPLICATION	
CABLE(S)	300 SERIES
INSTALLATION	PER CONFIGURATOR

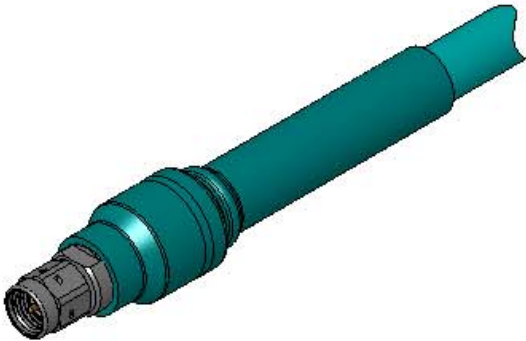

ISOMETRIC VIEW
SCALE 1:1

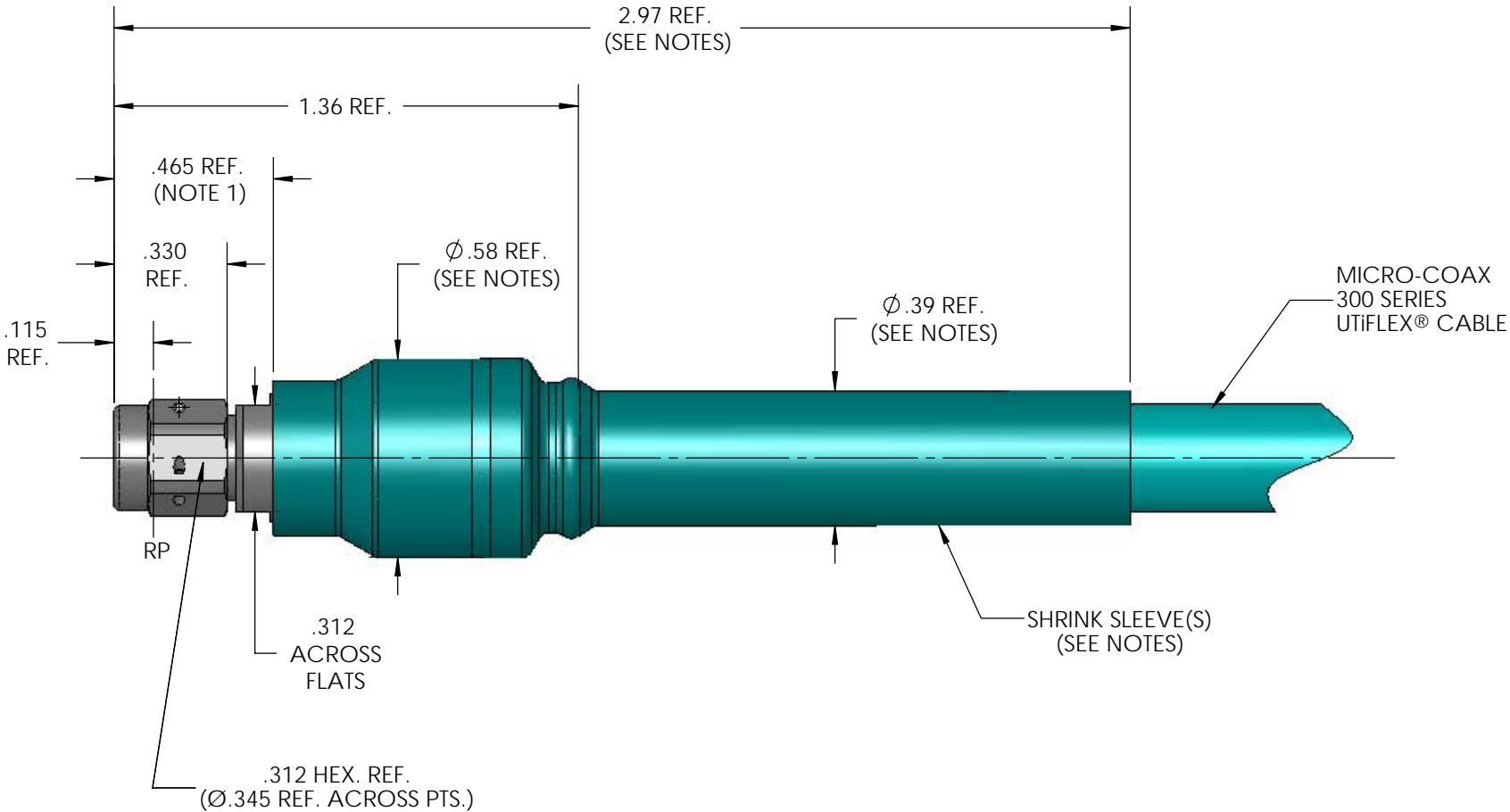

NOTE:

1. HEAT SHRINK CONFIGURATION OPTIONAL.
2. MARKER LOCATION ON THIS DRAWING IS FOR REFERENCE ONLY AND IS SUBJECT TO CHANGE WITHOUT NOTICE.

THIS SPECIFICATION IS THE PROPERTY OF MICRO-COAX, INC. AND MAY NOT BE USED OR COPIED WITHOUT THE EXPRESS WRITTEN PERMISSION OF MICRO-COAX, INC.		INITIALS		DATE		<div>MICRO-COAX[®] <i>Leading the way in transmission line solutions.</i> Copyright Micro-Coax, Inc.</div>				
		DWN.	SRS	06/01/05						
		CHKD.								
		APPVD.								
TOLERANCES UNLESS OTHERWISE SPECIFIED		TITLE								
		SMA PLUG, 300 SERIES CABLE, WIRE HOLES								
.XX	± .02	ALL DIMENSIONS IN INCHES UNLESS OTHERWISE SPECIFIED. SCREW THDS. TO BE IN ACCORD WITH ANSI B1.1-1989.		FSCM NO. 64639	SIZE B	SCALE 2:1	SHEET NO. 1 OF 1	DRAWING NO. SD904383	REV A	
.XXX	± .005									
.XXXX	± .0010									
ANGLES	± 2°									

SPECIFICATION DRAWING