

# MMCX TERMINATION

ST6022

## SPECIFICATIONS

### ELECTRICAL

FREQUENCY: 0-6 GHZ

IMPEDANCE: 50 OHMS

VSWR: 1.30:1 MAX @ 6GHZ

### MECHANICAL

MATERIAL BODY: BRASS, Au PLATED

CONTACTS FEMALE: BRASS, Au PLATED

CONTACTS, MALE: BeCu, Au PLATED

INSULATOR: TEFLON

-55 TO +120°C

ROHS COMPLIANT

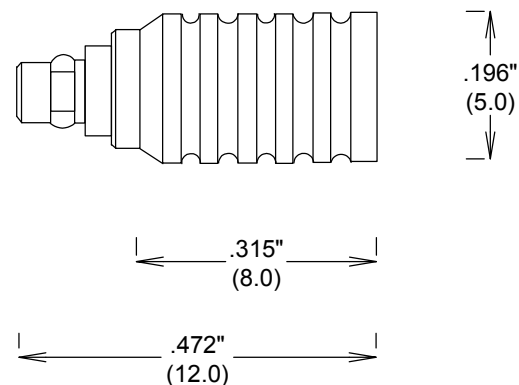

ST6022 PLUG

MEASUREMENTS BELOW ARE TYPICAL

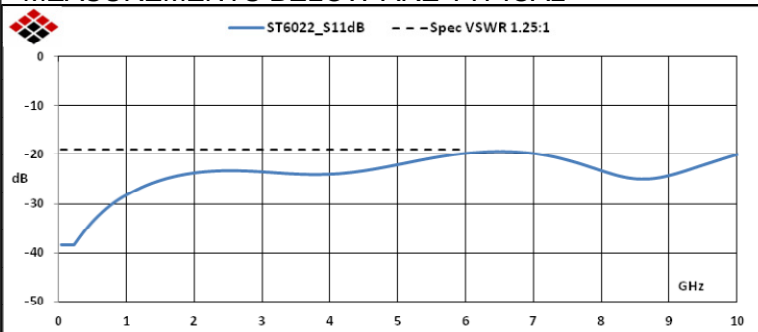

ALL DIMENSIONS IN inches(MM) Typical

**FAIRVIEW MICROWAVE INC.**

ALLEN, TX 75013 [WWW.FAIRVIEWMICROWAVE.COM](http://WWW.FAIRVIEWMICROWAVE.COM)

TITLE

**MMCX TERMINATIONS**

SIZE

**A**

CAGE CODE

**3FKR5**

DWG NO

**ST6022**

REV

**A**

SCALE

SHEET