

DC BLOCKING TERMINATIONS 30 KHz - 18 GHz SMA INNER ONLY



MODELS: 8530SM & 8530SF

SPECIFICATIONS:

Electrical:

Frequency Range _____ 30 KHz – 18 GHz
VSWR _____ 1.35:1 Max.
Impedance _____ 50 Ohms
Voltage Rating _____ 100 Volts Max DC
Operating Temp. Range _____ +10°C to +85°C

Mechanical:

Connectors _____ Passivated Stainless Steel
Mates with MIL-STD-348
Conductors _____ Gold Plated Beryllium Copper

Model Number: **8530SM**
SMA Male Connector

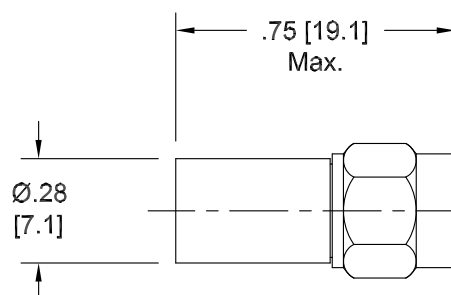

Model Number: **8530SF**
SMA Female Connector

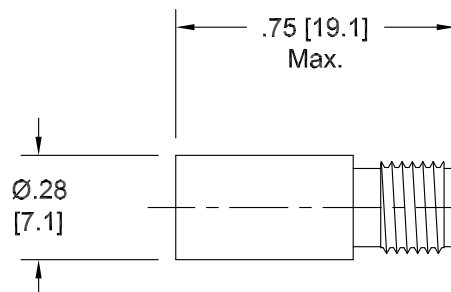

Note: Dimensions in Brackets are Expressed in Millimeters and are for Reference Only.
Design specifications are subject to change without notice.
Contact factory for technical specifications before purchasing or use.