

# TERMINATION 6GHZ SMA-MALE

ST0645

## SPECIFICATIONS

### ELECTRICAL:

FREQUENCY: 0-6 GHZ  
VSWR @ 6 GHZ: 1.15:1 MAX  
POWER (AVG) 1.0 WATTS @ 25 DEG C;  
1/2 WATT @ 125 DEG C  
POWER (PEAK) 1KW/50 MICRO-S  
IMPEDANCE: 50 OHMS  
OP. TEMP RANGE: -55C- +125C

### MECHANICAL:

MATERIAL COUPLING NUT: TRIMETAL PLATED BRASS  
MATERIAL BODY: GOLD PLATED BRASS  
CENTER CONTACT: GOLD PLATED PER MIL-G-45204  
RESISTIVE ELEMENT: THIN FILM ON ALUMINA SUBSTRATE  
RECOMMENDED TORQUE: 5-7 IN-LBS

ROHS COMPLIANT

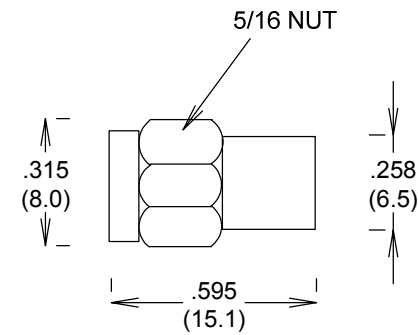

### MEASUREMENTS BELOW ARE TYPICAL

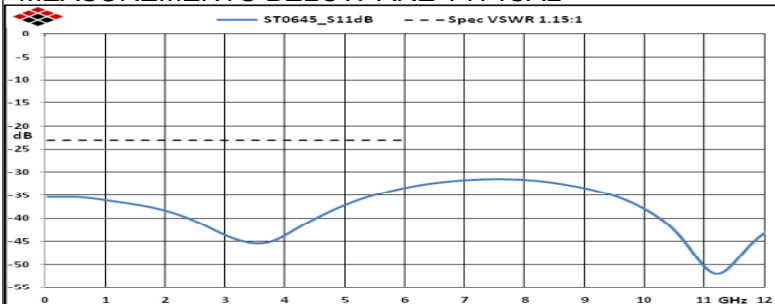

ALL DIMENSIONS IN inches(MM) Typical

**FAIRVIEW MICROWAVE INC.**

ALLEN, TX 75013 WWW.FAIRVIEWMICROWAVE.COM

TITLE

**TERMINATION 6GHZ SMA-MALE**

SIZE	CAGE CODE	DWG NO	REV
<b>A</b>	<b>3FKR5</b>	<b>ST0645</b>	<b>A</b>
SCALE	SHEET		