

5000 MHz < Fo < 6000 MHz

Band Pass

Slopes 1000 MHz

Bandwidth 50 MHz

WBCJV2-\_\_\_

Attenuation 30 dB

## Specifications

Passband:	___ (Fo) ± 25 MHz = ___ to ___ MHz
Passband Insertion Loss:	0.75 dB max. at Fo (0.75 dB max. at corners)
Passband Return Loss:	14 dB min. (VSWR 1.5:1 max.)
Stopband:	DC to ___ MHz and ___ to 9000 MHz
Stopband Attenuation:	30 dB min.
Operating Temperature:	15 °C to 45 °C
Power Handling:	will be quoted ( <i>Please see our <a href="#">warranty</a> in this regard</i> )
Dimensions (L x W x H):	max. 45 x 20 x 30 mm (plus connectors and flanges)
Approx. Weight:	0.1 kg
Mounting Provision:	7.5 mm flanges on both ends with 3.3 mm holes
Connector 1:	- Please choose -
Connector 2:	- Please choose -

## Typical Performance

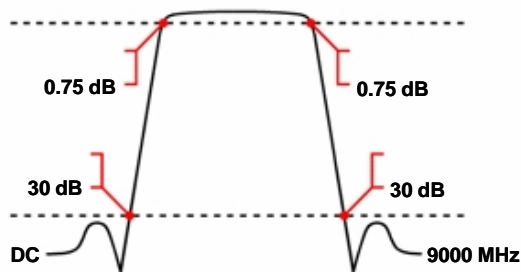

## 2 Section Cavity Design



## Connector Options

SMA Female  
SMA Male  
N Female  
N Male  
BNC Female  
BNC Male

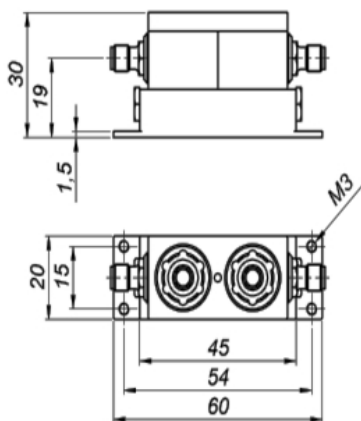

## Euro Prices

(USD Prices will be quoted for US-based customers only)

1 - 4 pcs:	€ 468
5 - 9 pcs:	€ 433
10 - 24 pcs:	€ 400

## Delivery Terms

FCA Andechs (free carrier) according to **Incoterms 2010**  
In Deutschland liefern wir frachtfrei gemäß CPT **Incoterms 2010** (unversichert).  
Regarding payment terms and warranty see [Terms and Conditions](#).  
**Delivery time:** normally 3 to 4 weeks - depending on quantity ordered and on our work load.

Customer is responsible for observing all applicable export laws in regard to filter application and location of end user



**Wainwright Instruments GmbH**  
www.wainwright-filters.com

Tel: +49 8152 918230  
Fax: +49 8152 918255  
info@wainwright-filters.com