



2 Watt RF Load Up To 3 GHz With 7/16 DIN
Male Input Silver Plated Brass

RF Terminations Technical Data Sheet

PE6TR1013

Configuration

Connector	7/16 DIN Male
Heat Sink	Brass, Silver
Connection Method	Standard
Body Style	Straight

Electrical Specifications (Values at 25°C, sea level)

Description	Minimum	Typical	Maximum	Units
Frequency Range	DC		3	GHz
Impedance		50		Ohms
VSWR			1.1:1	
Input Power			2	Watts
Peak Power			1	KWatts

Mechanical Specifications

Connector

Type	7/16 DIN Male
Inner Conductor Material and Plating	Brass, Silver
Outer Conductor Material and Plating	Brass, Silver
Coupling Nut Material and Plating	Brass, Silver
Hex Size	7/16 Inch
Body Material and Plating	Brass, Silver

Compliance Certifications (visit www.Pasternack.com for current document)

RoHS Compliant

Plotted and Other Data

Notes:

- Values at +25 °C, sea level

Click the following link (or enter part number in "SEARCH" on website) to obtain additional part information including price, inventory and certifications: [2 Watt RF Load Up To 3 GHz With 7/16 DIN Male Input Silver Plated Brass PE6TR1013](#)

RF Terminations Technical Data Sheet

PE6TR1013

The information contained in this document is accurate to the best of our knowledge and representative of the part described herein. It may be necessary to make modifications to the part and/or the documentation of the part, in order to implement improvements. Pasternack reserves the right to make such changes as required. Unless otherwise stated, all specifications are nominal. Pasternack does not make any representation or warranty regarding the suitability of the part described herein for any particular purpose, and Pasternack does not assume any liability arising out of the use of any part or documentation.

PE6TR1013 CAD Drawing

2 Watt RF Load Up To 3 GHz With 7/16 DIN Male Input Silver Plated Brass

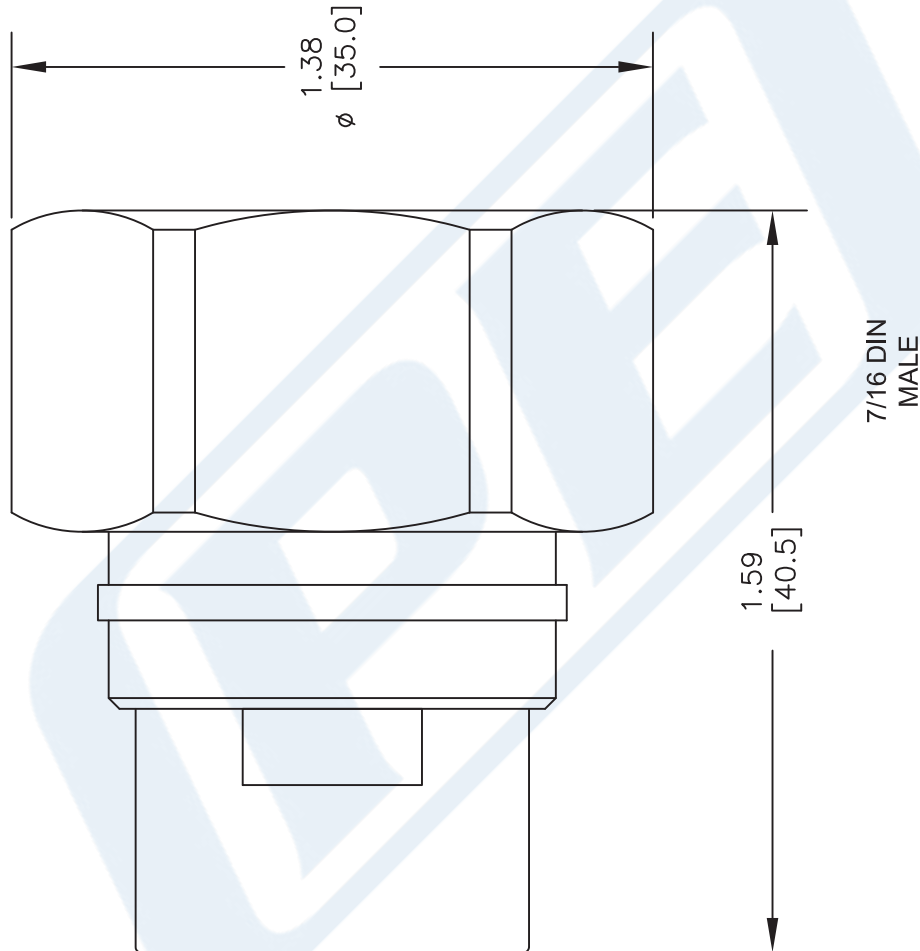

NOTES:

1. UNLESS OTHERWISE SPECIFIED ALL DIMENSIONS ARE NOMINAL.
2. ALL SPECIFICATIONS ARE SUBJECT TO CHANGE WITHOUT NOTICE AT ANY TIME.
3. DIMENSIONS ARE IN INCHES [mm].

DWG TITLE

PE6TR1013

FSCM NO. 53919

2233

SIZE A

SCALE N/A

CAD FILE 062415

PE PASTERNACK®
THE ENGINEER'S RF SOURCE

Pasternack Enterprises, Inc.
P.O. Box 16759 | Irvine | CA | 92623

Phone: (949) 261-1920 | Fax: (949) 261-7451

Website: www.pasternack.com | E-Mail: sales@pasternack.com