

TERMINATIONS 7/16 - DIN

UP TO **7.5 GHz**
25 WATTS

api 
technologies corp.
> INMET

MODELS: TDXXXM-25W, TNXXF-25W

SPECIFICATIONS:

Electrical:

Frequency Range _____ DC - 7.5 GHz
Standard Freq. Values _____ 2.5, 4 & 7.5 GHz
VSWR _____
DC - 6 GHz _____ 1.20:1 Max.
6 - 7.5 GHz _____ 1.30:1 Max.
Impedance _____ 50 Ohms
Input Power _____ 25 Watts Avg. @ +25°C
Derated Linearly to 5 Watts @ +125°C
Peak Power _____ 500 Watts Max.
(5uSec Pulse, .05% Duty Cycle)
Operating Temp Range _____ -65°C to +125°C

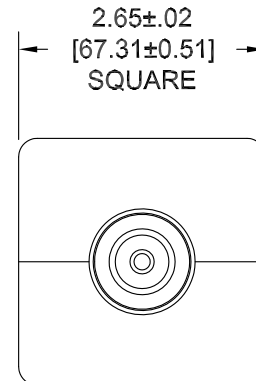

END VIEW TYPICAL

Units must be Mounted in such a way as to Allow for Free Air Flow Around fins as to Assure Performance.

Mechanical:

7/16 DIN Connectors _____ Silver or White Bronze
Mates with DIN 47 223 _____ Plated Brass
Conductors _____ Silver or White Bronze
Plated Beryllium Copper
Housing _____ Anodized Aluminum

Model Number: **TD075M-25W**
7/16 - DIN Male Connector

Model Number: **TD075F-25W**
7/16 - DIN Female Connector

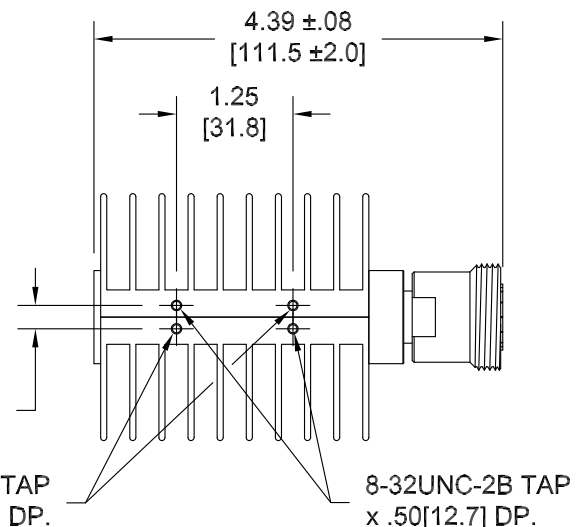
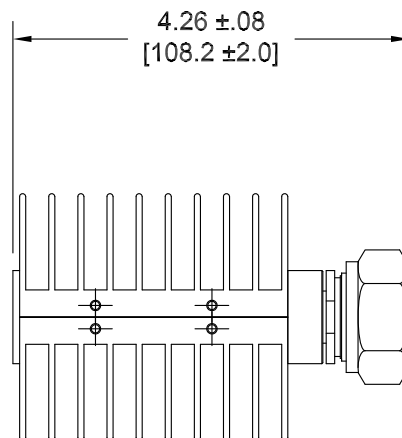

NOTE: Hole Pattern typical for both Male & Female units

HOW TO ORDER:

Model Number: **TDXXXY-25W**

Connector Config.
Freq. Range _____ F = Female
M = Male
020 = DC - 2.5 GHz
040 = DC - 4 GHz
075 = DC - 7.5 GHz

Ordering Examples:

Model Number: **TD040M-25W**
DC - 4 GHz, DIN 7/16 Male

Model Number: **TD075F-25W**
DC - 7.5 GHz, DIN 7/16 Female

Note: Dimensions in Brackets are Expressed in Millimeters and are for Reference Only.
Design specifications are subject to change without notice.
Contact factory for technical specifications before purchasing or use.