

REVISIONS				
ZONE	REV	DESCRIPTION	DATE	APPROVED

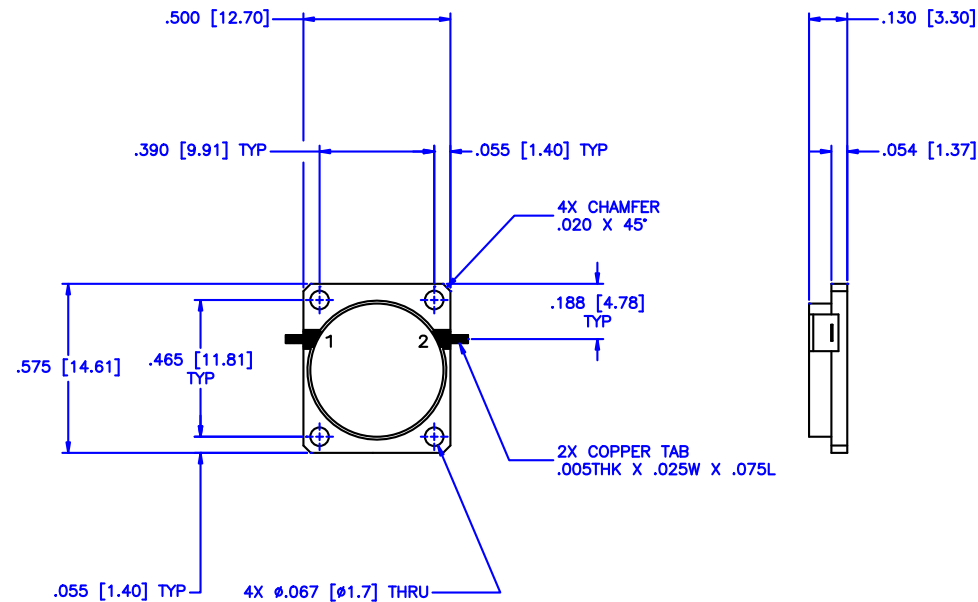

SPECIFICATIONS

Frequency Range: 4.40–4.48GHz
 Insertion Loss: 0.25dB Max.
 Isolation: 20dB Min.
 VSWR: 1.22:1 Max.
 Impedance Nominal: 50 Ohms
 Power Rating: 1 Watt
 Operating Temperature: –30°C to +85°C
 Storage Temperature: –55°C to +100°C

MATERIAL: <div style="border: 1px solid black; height: 100px; width: 100%;"></div>		MCLI MICROWAVE COMMUNICATIONS LABORATORIES INC. 7255 30TH AVE. N. SAINT PETERSBURG, FL 33710 TEL: (727) 344–6254 FAX: (727) 381–6116 http://WWW.MCLI.COM		SCALE:		N/A		
				SHEET:		N/A		
UNLESS OTHERWISE SPECIFIED: TOLERANCES IN (INCHES) OR [mm] (MILLIMETERS) FRACTIONS: $\pm 1/64$ DECIMALS: $\pm 0.01 \pm 0.005$ ANGLE: $\pm 1/2^\circ$		DRAWING TITLE:					DROP-IN ISOLATOR	
		PART NO.					DI-19	
DRAWN: Paiboon Luekhamhan		DATE: 01-05-2005		CAGE CODE: OD2L5		SIZE: N/A	REV: N/A	DWG NO. 82151
APPROVED: T. Nguyen		DATE: 01-05-2005		THIRD ANGLE PROJECTION 		DO NOT SCALE THE DRAWING		