

# HIGH POWER WAVEGUIDE CIRCULATOR

## – RFWC112B

1.0	Mechanical Specifications	
1.1	Waveguide type	Rectangular Waveguide WR112
1.2	Flange type	CPR112-F mating
1.3	Flange Holes	Through
1.4	External Body Finish	Conductive metal oxide

2.0	Environment specifications	
2.1	Operation Temp.	-20°C~+60°C
2.2	Storage Temp.	-45°C~+125°C
2.3	Altitude	15000 ft
2.4	Vibration	10g rms (15 degree 2KHz)
2.5	Humidity	100% RH at 35c, 95%RH at 40 deg c
2.6	Shock	20G for 11msc

3.0	Electrical Specifications	
3.1	Frequency Range	7.05 ~ 10.0 GHz
3.2	Bandwidth	Full
3.3	Max. VSWR	1.25:1
3.4	Insertion Loss	0.5dB (max.)
3.5	Isolation	23dB
3.6	Forward Power	250W (CW)
3.7	Reverse Power	250W (CW)
3.8	Peak Power	4KW (8% duty cycle)

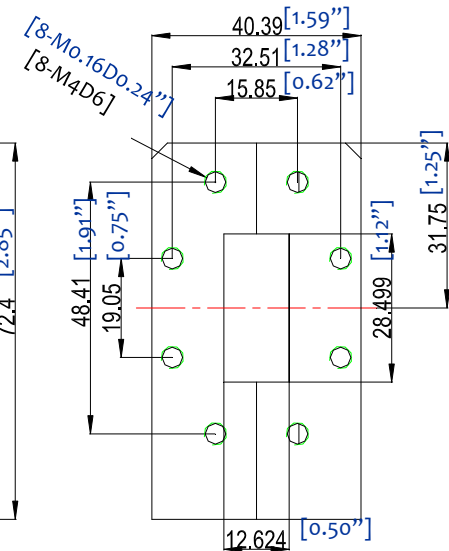
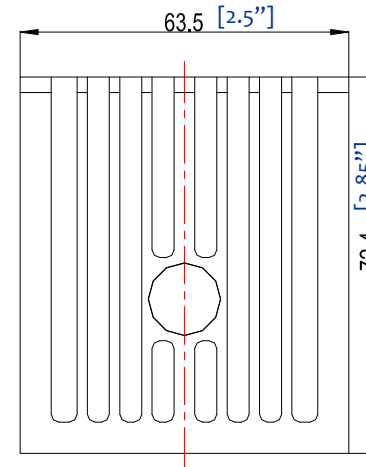
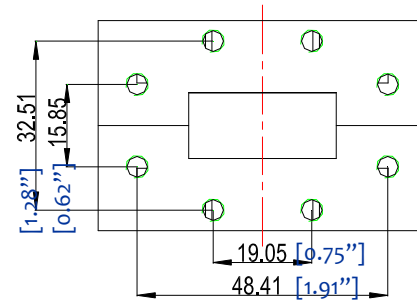

PAGE 1 OF 1	DATE Jun 15 <sup>th</sup> 2006
PROPRIETARY INFORMATION THE INFORMATION CONTAINED IN THIS DOCUMENT IS THE PROPERTY OF RF-LAMBDA EXCEPT AS SPECIFICALLY AUTHORIZED IN WRITINGS BY RF-LAMBDA. THE HOLDER OF THIS DOCUMENT SHALL KEEP ALL INFORMATION CONTAINED HEREIN CONFIDENTIAL AND SHALL PROTECT SAME IN THE WHOLE OR IN PART FROM DISCLOSURE AND DISSEMINATION OF ALL THIRD PARTIES AND SHALL USE SAME FOR OPERATING AND MAINTENANCE PURPOSES ONLY	DESIGN RFWC
RF-LAMBDA	RFPC
CAD MODEL REVISION 19	ASSEMBLY REVISION VS22
ASSEMBLY NAME RFLVR17	DRAWING NUMBER D05-1
www.rflambda.com	RF-LAMBDA
SIZE LT	SHEETS 1 OF 1