

ADAPTERS, BETWEEN-SERIES

SMA / 3.5mm , DC - 18 GHz

SPECIFICATIONS:

Models: 5246, 5247, 5248, 5249

RoHS
Compliant

AEROFLEX
A passion for performance.

Electrical:

Frequency Range _____ DC - 18.0 GHz
VSWR _____ 1.25:1 Max.
Impedance _____ 50 Ohms
Operating Temp Range _____ -65°C to +125°C

Mechanical:

SMA Connectors _____ Passivated Stainless Steel
Mates with MIL-STD-348
3.5mm Connectors _____ Passivated Stainless Steel
Mates both Mechanically and Electrically with
all SMA, and K* Series Connectors
Conductors _____ Gold Plated Beryllium Copper

* K is a Trademark of Anritsu Corp.

Model Number: **5246**
SMA Male to 3.5mm Male

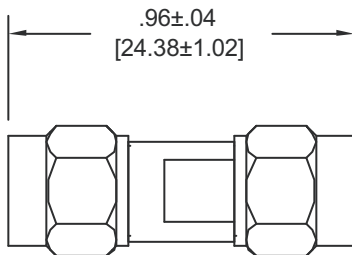

Model Number: **5248**
SMA Female to 3.5mm Male

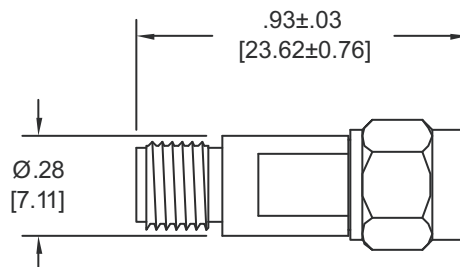

Model Number: **5247**
SMA Male to 3.5mm Female

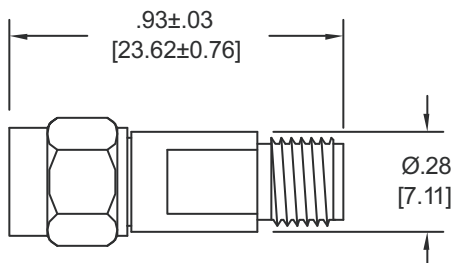

Model Number: **5249**
SMA Female to 3.5mm Female

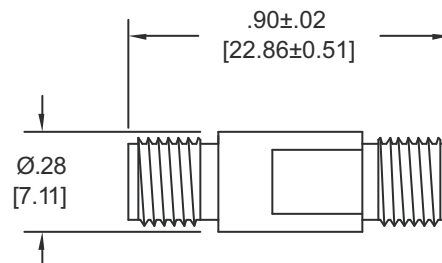

Note: Dimensions in Brackets are Expressed in Millimeters and are for Reference Only.

5246: REV -

AEROFLEX
INMET

Aeroflex / Inmet, Inc. • 300 Dino Drive, Ann Arbor, MI 48103 • U.S.A.
888-244-6638 or 734-426-5553 • FAX: 734-426-5557
www.aeroflex.com/inmet • inmet@aeroflex.com