

## Directional Couplers, Low-Loss Stripline Coupler 120-240MHZ, 6 & 10dB N-Connectors

**KorinWell™**

- 200Watt Average Main Line Power
- 20dB Isolation, Min
- Minimal RF Insertion Loss
- High Reliability
- Environment IP65
- N Female Connectors

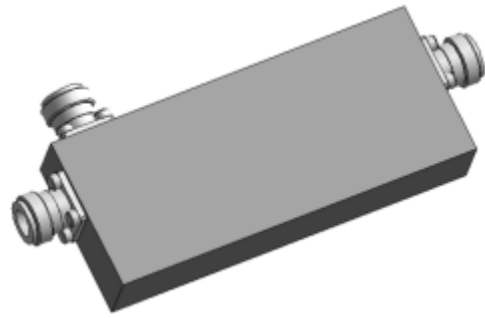

The BXDC series of Directional Couplers is a stripline design for indoor/outdoor applications. Units couple off a defined fraction of signal with minimal reflections or loss. All of them are conformance to IP65 specification. Its mechanical shape allows to be fixed on the wall or the pole easily.

These devices allow use with antennas and leaky cable systems and wireless base stations.

VSWR:	1.20:1 Max., All Ports
Isolation:	20dB Min.
Power Rating:	200W, avg.; 1.5KW peak
Impedance:	50 ohm, nominal
Temperature Range, C	-25° to +75°
Environment:	IP65, RoHS compliant
Housing:	Passivated Aluminum or powder paint
Connectors:	N (f), tri-plate
DC capability: DC transmission only between input and output	

PN.	Frequency Band, MHz	Coupling, dB	Mainline Loss dB Max.	Insertion Loss dB Max.	Reflected Power W Max.	Weight g
BXDC-6-NFB	120~240	-6±1.0	1.7	0.20	40	430
BXDC-10-NFB	120~240	-10±1.0	0.8	0.20	100	430

### Dimensions, mm

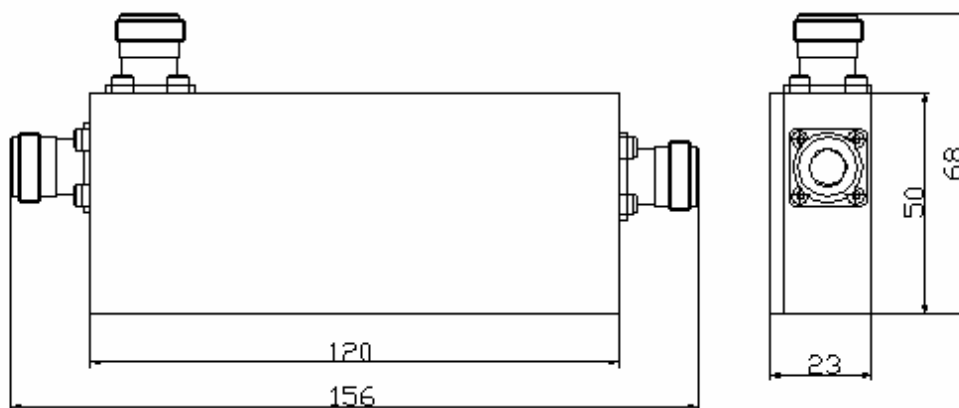

BXDC- (6-10)-NFB

All Specifications are subject to change without prior notice

KorinWell Electronics, Inc, 1-111, 52 MUXUYUAN Road, NANJING, 210007 CHINA  
TEL: +86 25 8485 2620 FAX: +86 25 8485 2630 [www.korinwell.com](http://www.korinwell.com) [sales@korinwell.com](mailto:sales@korinwell.com)