

# Fixed Coaxial Attenuators



## Model 75A

### Bi-directional Design, SMK Connectors

dc to 40.0 GHz

5 Watts



### Features

- Usable to 42 GHz
- Compact Construction - Lowest size/power ratio.
- Precision Injection Molded Connectors
- Designed to meet environmental requirements of MIL-DTL-3933.
- Flat Response & Low SWR

### Specifications

NOMINAL IMPEDANCE: 50  $\Omega$

FREQUENCY RANGE: dc to 40.0 GHz

#### MAXIMUM DEVIATION OVER FREQUENCY:

Nominal ATTN (dB)	Deviation (dB)	
	dc-26.5 GHz	26.5-40 GHz
3, 6	$\pm 0.50$	$\pm 1.00$
10, 20, 30	$\pm 0.80$	$\pm 1.50$

#### MAXIMUM SWR:

Frequency (GHz)	SWR
dc - 26.5	1.25
26.5 - 40	1.45

**POWER RATING (mounted horizontally):** 5 watts **average (bi-directional)** to 25°C ambient temperature, derated linearly to 0.5 Watt @ 125°C. 200 watts **peak** (5  $\mu$ sec pulse width; 1.25% duty cycle).

**POWER COEFFICIENT:** <0.002 dB/dB/watt

**TEMPERATURE COEFFICIENT:** <0.0004 dB/dB/°C

**TEMPERATURE RANGE:** -55 °C to 125 °C

**TEST DATA:** Swept data plots of attenuation and SWR from 50 MHz to 40 GHz.

**CONNECTORS:** SMK (2.92mm) Male/Female connectors - mate nondestructively with SMA, 3.5mm and SMK (2.92mm) connectors.

Connector Options	Type/Description
1	2.92mm, Female
2	2.92mm, Male

**CONSTRUCTION:** Black, finned aluminum body, gold plated beryllium copper contacts.

**WEIGHT:** 200 g (7.0 oz.) maximum

#### PHYSICAL DIMENSIONS:

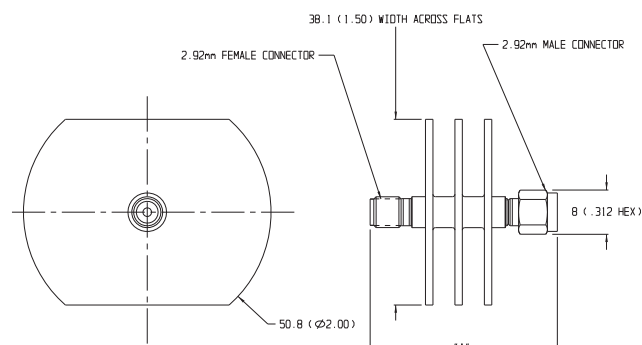

Dash No.	Connector Type	DIM A
11	2.92mm Female/Female	39.9 (1.56)
12	2.92mm Male/Female	44.1 (1.74)
22	2.92mm Male/Male	48.8 (1.92)

NOTE: All dimensions are given in mm (inches) and are nominal, unless otherwise specified.

#### MODEL NUMBER DESCRIPTION:

Example:

<b>75A</b>	<b>- XX</b>	<b>- XX*</b>
Basic Model Number	Attenuation Value (dB)	Connector Options
		-11 Female/Female
		-12 Female/Male
		-22 Male/Male

\*Unit is bi-directional and full power may be applied to either connector.