



Precision SMP Female to SMP Female Adapter

TECHNICAL DATA SHEET

PE91065

Precision SMP Female to SMP Female Adapter

Configuration

Connector 1	SMP Female
Impedance 1	50 Ohms
Connector Specification 1	MIL-STD-348
Connector 2	SMP Female
Impedance 2	50 Ohms
Connector Specification 2	MIL-STD-348
Adapter Design	Precision
Body Style	Straight

Electrical Specifications

Frequency Range, GHz	DC to 40
Maximum VSWR	1.2:1
Maximum Insertion Loss, dB	0.43
Dielectric Withstanding Voltage, Vrms	500

Frequency 1

Frequency, GHz	DC to 26.5
VSWR	1.2:1

Mechanical Specifications

Temperature

Operating Range, deg C	-55 to +125
------------------------	-------------

Size

Length, in [mm]	0.254 [6.45]
Width/Dia., in [mm]	0.131 [3.33]

Connector 1

Type	SMP Female
Inner Conductor Material and Plating	Beryllium Copper, Gold
Inner Conductor Plating Specification	MIL-G-45204, Type I, Grade 1, Class A
Body Material and Plating	Beryllium Copper, Gold
Body Plating Specification	MIL-G-45204, Type I, Grade 1, Class A
Dielectric Type	PTFE

Connector 2

Type	SMP Female
Inner Conductor Material and Plating	Beryllium Copper, Gold
Inner Conductor Plating Specification	MIL-G-45204, Type I, Grade 1, Class A
Body Material and Plating	Beryllium Copper, Gold
Body Plating Specification	MIL-G-45204, Type I, Grade 1, Class A

Click the following link (or enter part number in "SEARCH" on website) to obtain additional part information including price, inventory and certifications: [Precision SMP Female to SMP Female Adapter PE91065](#)

The information contained in this document is accurate to the best of our knowledge and representative of the part described herein. It may be necessary to make modifications to the part and/or the documentation of the part, in order to implement improvements. Pasternack reserves the right to make such changes as required. Unless otherwise stated, all specifications are nominal.

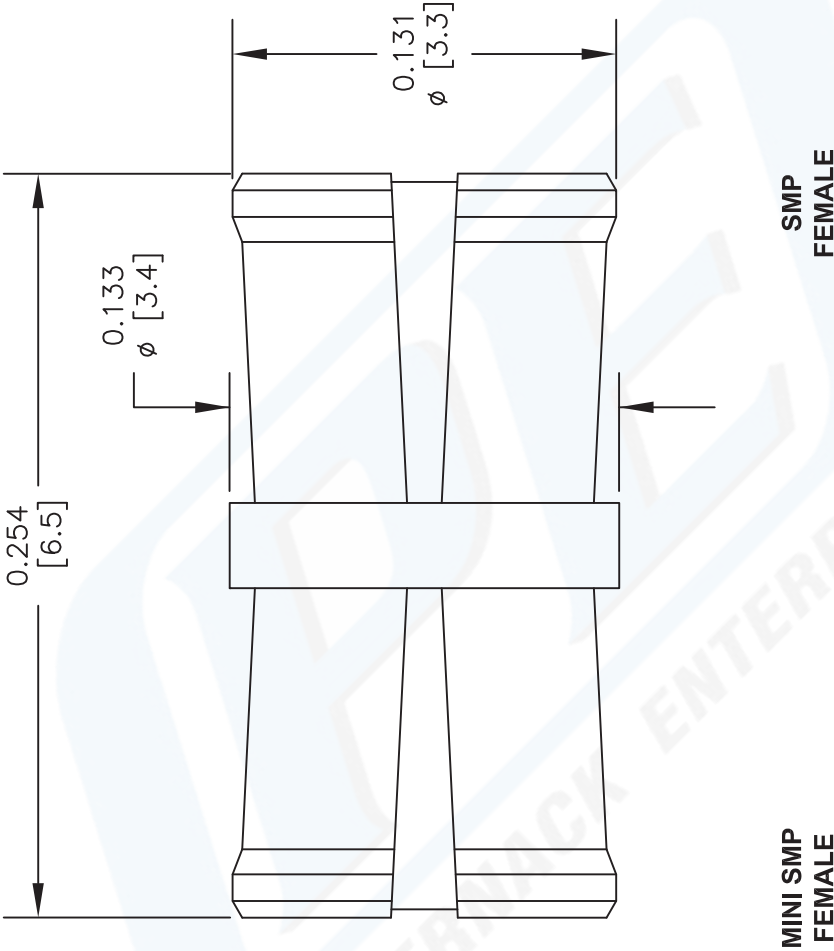

NOTES:
1. UNLESS OTHERWISE SPECIFIED ALL DIMENSIONS ARE NOMINAL.
2. ALL SPECIFICATIONS ARE SUBJECT TO CHANGE WITHOUT NOTICE AT ANY TIME.
3. DIMENSIONS ARE IN INCHES [mm].

DWG TITLE
PE91065

FSCM NO. 53919

CAD FILE 020813

SCALE N/A

SIZE A

2233

PE PASTERNAK®
Pasternack Enterprises, Inc.
P.O. Box 16759 | Irvine | CA | 92623
Phone: (949) 261-1920 | **Fax:** (949) 261-7451
Website: www.pasternack.com | **E-Mail:** sales@pasternack.com