

TERMINATIONS

7/16 - DIN, up to 6 GHz, 100 Watts

SPECIFICATIONS:

Models: TDXXXM-100W & TDXXXF-100W

RoHS
Compliant

AEROFLEX
A passion for performance.

Electrical:

Frequency Range _____ DC - 6.0 GHz
Standard Freq. Values _____ 2.5 & 6 GHz
VSWR
DC - 1.5 GHz _____ 1.25:1 Max.
1.5 - 2.5 GHz _____ 1.35:1 Max.
2.5 - 6.0 GHz _____ 1.45:1 Max.
Input Power _____ 100 Watts Avg.
Derated Linearly to 20 Watts @ +125°C
Peak Power _____ 1 kW Max.
(5uSec Pulse, .05% Duty Cycle)
Impedance _____ 50 Ohms
Operating Temp Range _____ -55°C to +125°C

Mechanical:

7/16 - DIN Connectors _____ Silver or White Bronze Plated Brass
Mates with DIN 47 223
Conductors _____ Silver or White Bronze Plated Beryllium Copper
Housing _____ Anodized Aluminum

Custom Mtg. hole Config.
may be Added to this
Surface.

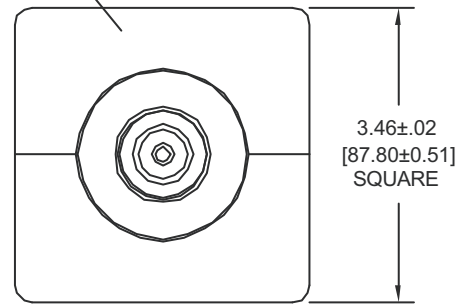

END VIEW
TYPICAL

Model Number: TDXXXF-100W

7/16 - DIN Female Connector
Length: 6.26±.08 [159.0 ±2.0]
Pictured

Model Number: TDXXXM-100W

7/16 - DIN Male Connector
Length: 6.12 ±.08 [155.4 ±2.0]

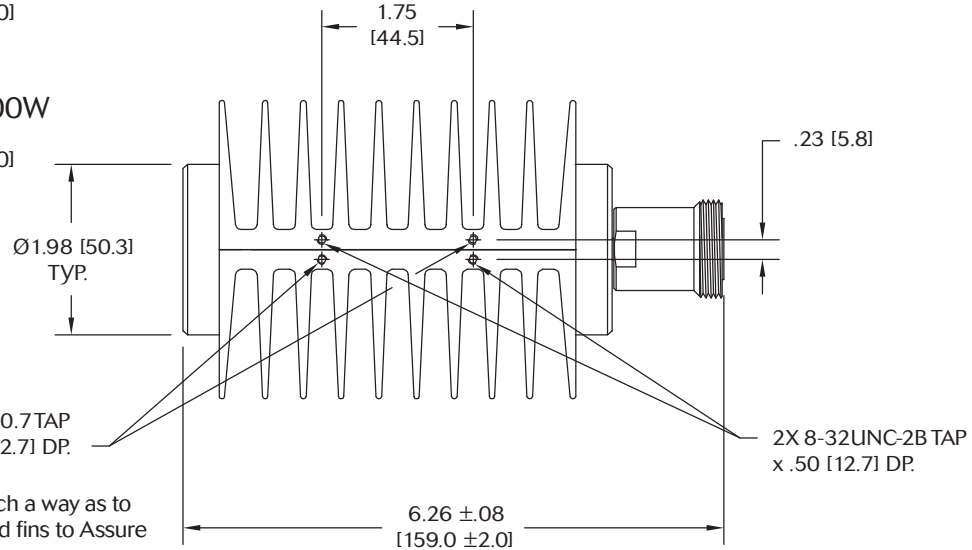

Units must be Mounted in such a way as to
Allow for Free Air Flow Around fins to Assure
Performance

HOW TO ORDER:

Model Number: **TDXXXY-100W**

Freq. Range _____ Connector Configuration
020 = DC - 2.5 GHz F = Female
060 = DC - 6 GHz M = Male

Ordering Examples:

Model Number: **TD020M-100W**
DC - 2.5 GHz, 7/16 DIN Male CONN.

Model Number: **TD060F-100W**
DC - 6.0 GHz, 7/16 DIN Female CONN.

Note: Dimensions in Brackets are Expressed in Millimeters and are for Reference Only.
Design specifications are subject to change without notice.
Contact factory for technical specifications before purchasing or use.

TDXXXY-100W: REV J

AEROFLEX
INMET

Aeroflex / Inmet, Inc. • 300 Dino Drive, Ann Arbor, MI 48103 • U.S.A.
888-244-6638 or 734-426-5553 • FAX: 734-426-5557
www.aeroflex.com/inmet • inmet-sales@eroflex.com