

MECHANICAL  
CONTACT: BREAK BEFORE MAKE  
ACTUATOR: FAILSAFE  
SWITCHING SPEED: 20 mSEC MAX

ELECTRICAL  
ACTUATOR VOLTAGE: 28.0 Vdc (22.0–32.0 Vdc)  
ACTUATOR CURRENT: 0.250 A MAX @ 28.0 Vdc  
POWER HANDLING: 200 WCW @ 1.0 GHz

ENVIRONMENTAL  
OPERATING TEMP: -54°C to +90°C  
SINE VIBRATION: 30 G'S rms  
LIFE : 1,000,000 CYCLES  
RANDOM VIBRATION: 20 G'S rms

SPECIFICATION:

FREQUENCY RANGE (GHz): DC–1.0

VSWR (Max.): 1.20:1

INSERTION LOSS (dB): 0.20

ISOLATION (dB): 90

IMPEDANCE: 50 OHMS

REVISIONS				
ZONE	REV	DESCRIPTION	DATE	APPROVED

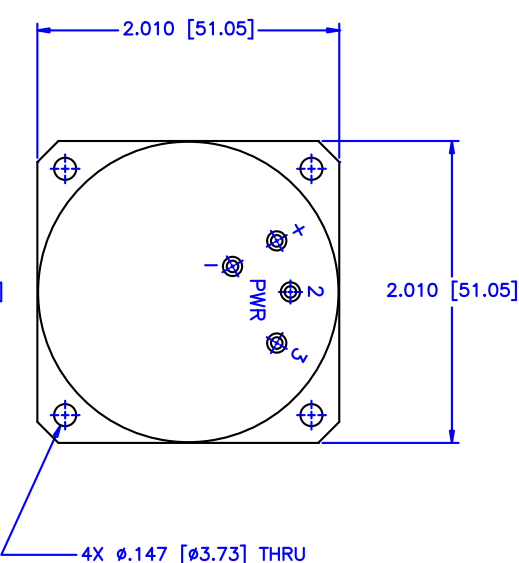
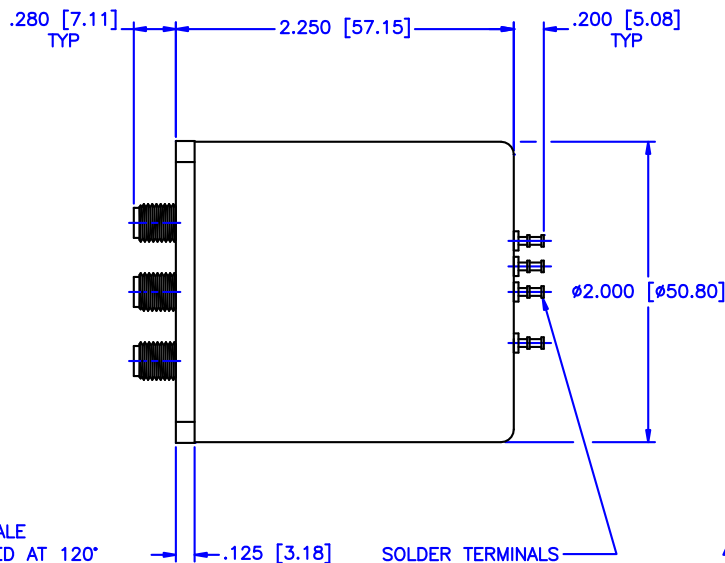
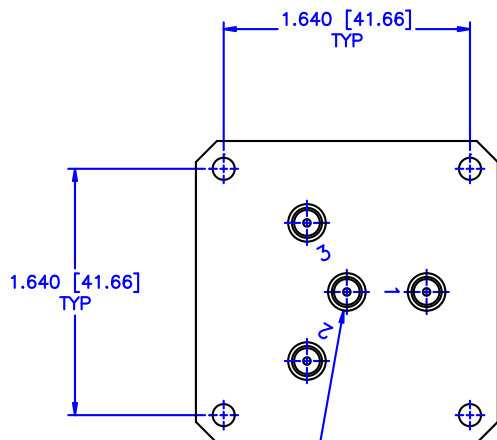

(4) TYPE SMA FEMALE  
(3) EQUALLY SPACED AT 120°  
ON Ø1.062 [Ø26.97] B.C.

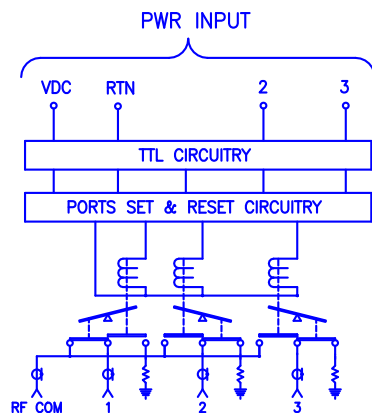

MATERIAL:	
DRAWN:	Paiboon Luekhamhan
DATE:	04-05-2001
APPROVED:	T. Nguyen
DATE:	04-05-2001

<b>MCLI</b> MICROWAVE COMMUNICATIONS LABORATORIES INC. 7255 30TH AVE. N. SAINT PETERSBURG, FL 33710 TEL: (727) 344-6254 FAX: (727) 381-6116 http://WWW.MCLI.COM		SCALE:	N/A
UNLESS OTHERWISE SPECIFIED: TOLERANCES IN (INCHES) OR [mm] (MILLIMETERS) FRACTIONS: $\pm 1/64$ DECIMALS: $\pm 0.01 \pm 0.005$ ANGLE: $\pm 1/2^\circ$		SHEET:	N/A
DRAWING TITLE: ELECTROMECHANICAL SWITCHES		PART NO.	V3-1-FL
CAGE CODE:		SIZE:	N/A
DO2L5		REV:	N/A
DO NOT SCALE THE DRAWING		DWG NO.	81708