

- \* Units pressure tested to 30 psi
- \* Ideal for high power sensing
- \* Available in Aluminum or Brass
- \* Single arm standard, multi-arm available
- \* Finishing: Corrosion-resistance 316 stainless steel epoxy coating

REVISIONS				
ZONE	REV	DESCRIPTION	DATE	APPROVED

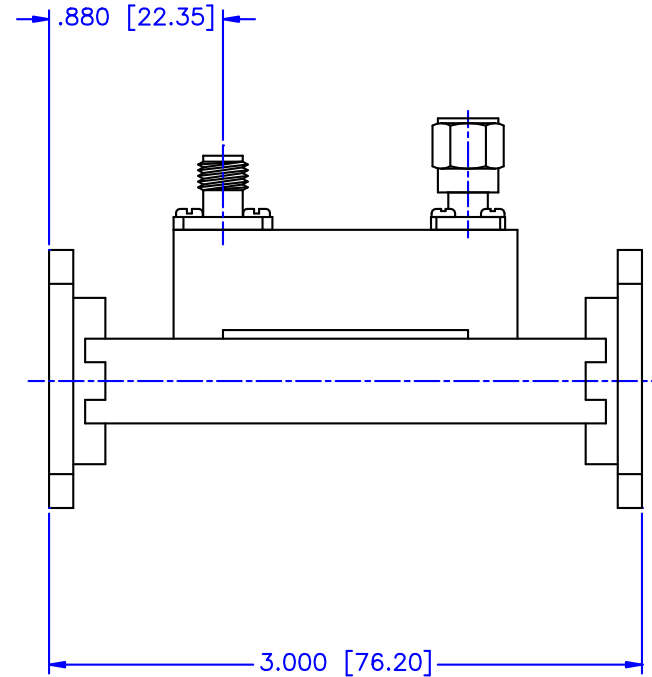
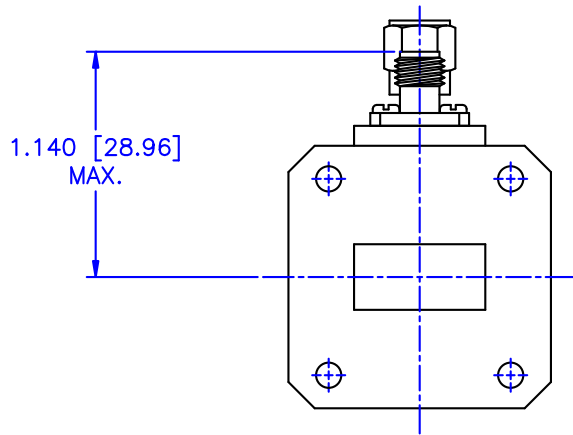

SPECIFICATIONS:

- Frequency Range: 12.4–18 GHz
- Nominal Coupling: 30±1.0dB
- Frequency Sensitivity: ±1.0dB
- VSWR Primary: 1.07:1 Max.
- VSWR Coaxial: 1.35:1 Max.
- Directivity: 15dB Min.
- Connector Type: SMA Female
- Flange Type: UG-COVER

MATERIAL:			MICROWAVE COMMUNICATIONS LABORATORIES INC. 7255 30TH AVE. N. SAINT PETERSBURG, FL 33710 TEL: (727) 344-6254 FAX: (727) 381-6116 http://WWW.MCLI.COM		SCALE:	N/A
DRAWN: Paiboon Luekhamhan			DATE: 04-03-2008	UNLESS OTHERWISE SPECIFIED: TOLERANCES IN (INCHES) OR [mm] (MILLIMETERS) FRACTIONS: ± 1/64 DECIMALS: ±.01 ±.005 ANGLE: ±1/2°		SHEET:
APPROVED: T. Nguyen		DATE: 04-03-2008	PROPRIETARY NOTICE: THE INFORMATION IN THIS DRAWING IS PROPRIETARY AND SHALL NOT BE USED OR DISCLOSED WITHOUT WRITTEN PERMISSION FROM MICROWAVE COMMUNICATIONS LABORATORIES INC. (MCLI)		DRAWING TITLE: WAVEGUIDE, COUPLER	
THIRD ANGLE PROJECTION				PART NO. WGL11-30-S-2		
CAGE CODE: OD2L5		SIZE: A	REV: N/A	DWG NO. 82819		
DO NOT SCALE THE DRAWING						