



50 Ohm 1 Watts Brass SMP Female RF Load Up To 18 GHz

TECHNICAL DATA SHEET

PE6160

50 Ohm 1 Watts Brass SMP Female RF Load Up To 18 GHz

Configuration

Connector	SMP Female
Heat Sink	Brass, Gold
Connection Method	Standard
Body Style	Straight

Electrical Specifications

Frequency Range, GHz	DC to 18
Impedance, Ohms	50
Maximum VSWR	1.2:1
Maximum Input Power, Watts	1

Mechanical Specifications

Temperature

Operating Range, deg C	-65 to +125
------------------------	-------------

Size

Length, in [mm]	0.518 [13.16]
Width/Dia., in [mm]	0.25 [6.35]

Connector

Type	SMP Female
Inner Conductor Material and Plating	Beryllium Copper, Gold
Body Material and Plating	Brass, Gold
Dielectric Type	PTFE

Compliance Certifications (visit www.Pasternack.com for current document)

RoHS Compliant	Yes
----------------	-----

Click the following link (or enter part number in "SEARCH" on website) to obtain additional part information including price, inventory and certifications: [50 Ohm 1 Watts Brass SMP Female RF Load Up To 18 GHz PE6160](#)

The information contained in this document is accurate to the best of our knowledge and representative of the part described herein. It may be necessary to make modifications to the part and/or the documentation of the part, in order to implement improvements. Pasternack reserves the right to make such changes as required. Unless otherwise stated, all specifications are nominal.



50 Ohm 1 Watts Brass SMP Female RF Load Up To 18 GHz

TECHNICAL DATA SHEET

PE6160

Plotted and Other Data

Notes:

Values at 25 °C, sea level

50 Ohm 1 Watts Brass SMP Female RF Load Up To 18 GHz from Pasternack Enterprises has same day shipment for domestic and International orders. Our RF, microwave and fiber optic products maintain a 99% availability and are part of the broadest selection in the industry.

Click the following link (or enter part number in "SEARCH" on website) to obtain additional part information including price, inventory and certifications: [50 Ohm 1 Watts Brass SMP Female RF Load Up To 18 GHz PE6160](http://www.pasternack.com/1-watts-smp-female-rf-load-up-to-18-ghz-pe6160-p.aspx)

URL: <http://www.pasternack.com/1-watts-smp-female-rf-load-up-to-18-ghz-pe6160-p.aspx>

The information contained in this document is accurate to the best of our knowledge and representative of the part described herein. It may be necessary to make modifications to the part and/or the documentation of the part, in order to implement improvements. Pasternack reserves the right to make such changes as required. Unless otherwise stated, all specifications are nominal.



PE6160 CAD Drawing

50 Ohm 1 Watts Brass SMP Female RF Load Up To 18 GHz

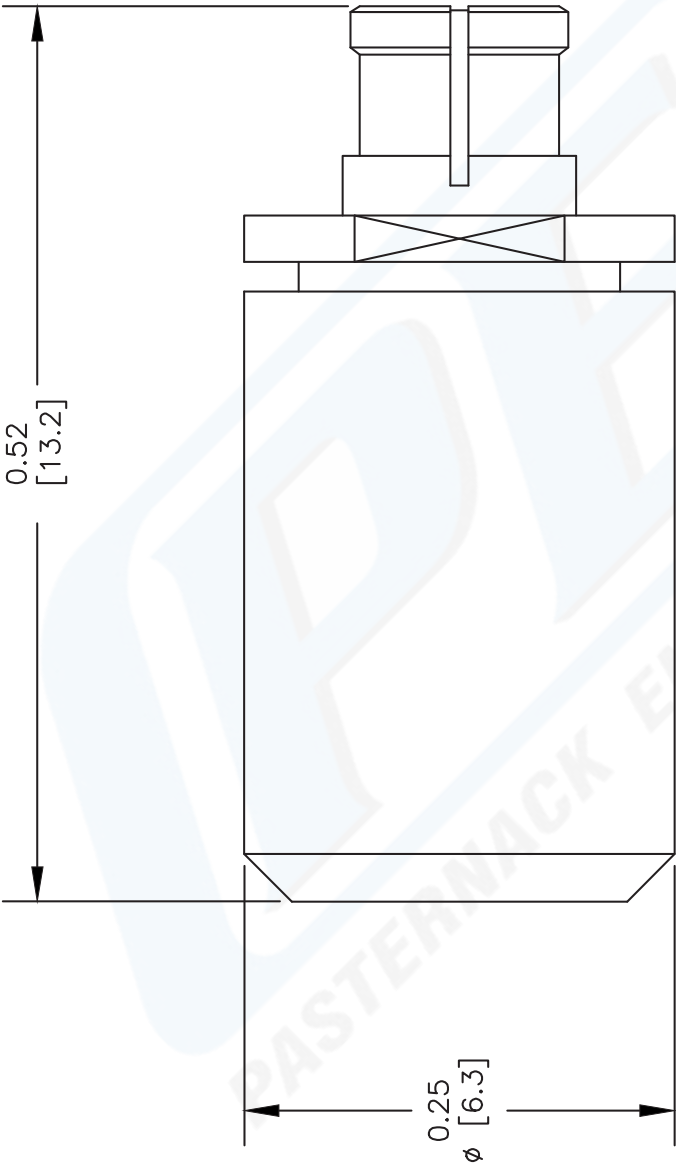

NOTES:
1. UNLESS OTHERWISE SPECIFIED ALL DIMENSIONS ARE NOMINAL.
2. ALL SPECIFICATIONS ARE SUBJECT TO CHANGE WITHOUT NOTICE AT ANY TIME.
3. DIMENSIONS ARE IN INCHES [mm].

DWG TITLE
PE6160

REV. D
FSCM NO. 53919

CAD FILE
022013-D

SCALE
N/A

SIZE
A

127

PE PASTERNAK®
Pasternack Enterprises, Inc.
P.O. Box 16759 | Irvine | CA | 92623
Phone: (949) 261-1920 | **Fax:** (949) 261-7451
Website: www.pasternack.com | **E-Mail:** sales@pasternack.com