



WR51 Waveguide Circulator 15-22GHz 50W



- Wide band operation 15-22GHz
- High isolation within operational band
- Low Insertion loss
- Low temperature coefficient ferrite material offer stable performance over temperature
- Commercial Aerospace and military application
- High peak to average handle capability
- All specifications can be modified upon request

Parameter	Min	Type	Max	Units
Frequency Range	15-22			GHz
Insertion Loss			0.50	dB
Isolation	20			dB
(see Note 1 for formula between frequency, isolation and insertion loss)				
VSWR			1.25	:1
Forward Power (CW)			50	W
Size	L	W	H	
	1.19"	1.46"	1.19"	Inch
	30.2	37	30.2	mm
Rotation	Clockwise (Standard) Counter Clockwise (upon request)			
Impedance	50			Ω
Input /Output Connector	UBR 180/FBP180Waveguide COVER Flange 4 Holes Flat			
Finishing	conductive oxide (not painted)			
Case Material	Aluminum/copper			
Operational Temp.	-20		60	$^{\circ}\text{C}$
Storage Temp.	-40		85	$^{\circ}\text{C}$
Altitude	15000		TBD	ft.
Vibration	10g 15 degree 2KHz			RMS
Humidity	100% RH at 35c, 95%RH at 40 $^{\circ}\text{C}$			
Shock	20G for 11msc.			



RF-LAMBDA

The power beyond expectations

RFWC51B

Note: Unit has narrow frequency bandwidth can achieve higher isolation & low insertion loss

Bandwidth (5 ~10) % x Center Frequency (Isolation >25dB)

Bandwidth (20~30) % x Center Frequency (Isolation >20dB)

Bandwidth (40~60) % x Center Frequency (Isolation >17dB)

Ask manufacture for detail

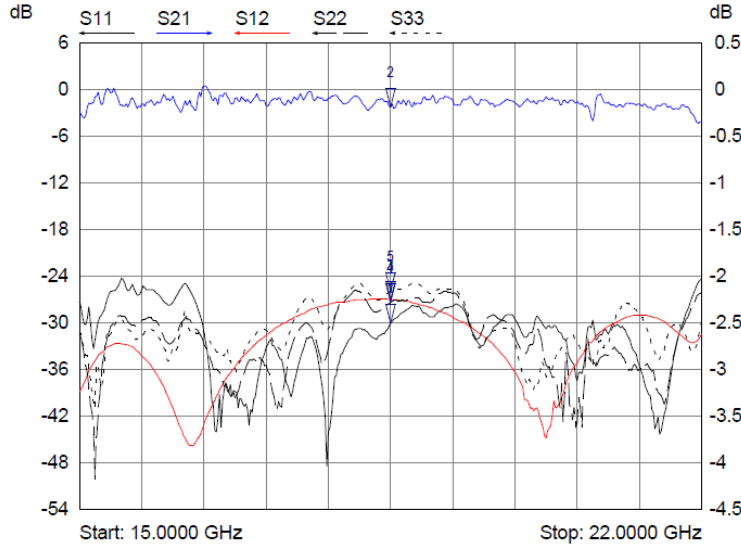

Mkr	Trace	X-Axis	Value
1 ▾	S11	18.5000 GHz	-30.14 dB
2 ▾	S21	18.5000 GHz	-0.19 dB
3 ▾	S12	18.5000 GHz	-27.10 dB
4 ▾	S22	18.5000 GHz	-27.38 dB
5 ▾	S33	18.5000 GHz	-26.03 dB

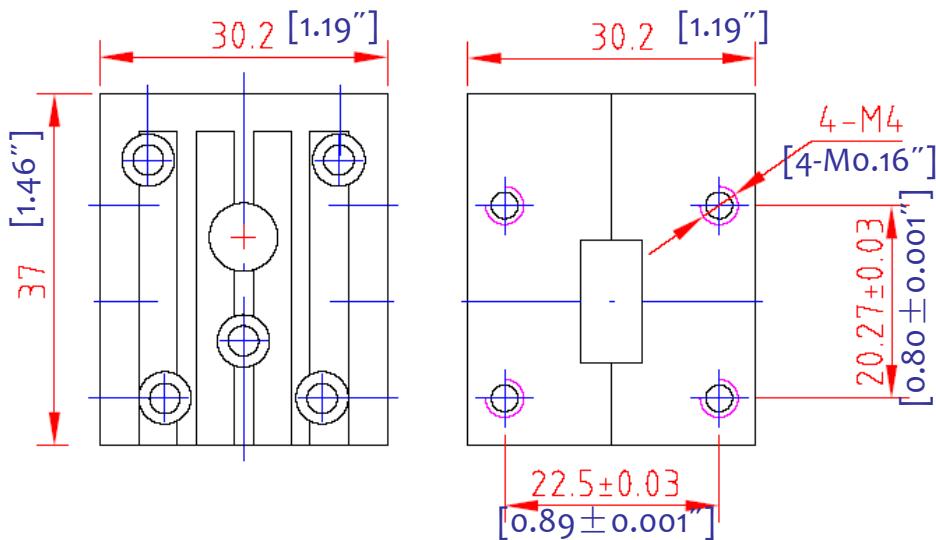

Important Notice

The information contained herein is believed to be reliable. RF-Lambda makes no warranties regarding the information contained herein. RF-Lambda assumes no responsibility or liability whatsoever for any of the information contained herein. RF-Lambda assumes no responsibility or liability whatsoever for the use of the information contained herein. The information contained herein is provided "AS IS, WHERE IS" and with all faults, and the entire risk associated with such information is entirely with the user. All information contained herein is subject to change without notice. Customers should obtain and verify the latest relevant information before placing orders for RF-Lambda products. The information contained herein or any use of such information does not grant, explicitly or implicitly, to any party any patent rights, licenses, or any other intellectual property rights, whether with regard to such information itself or anything described by such information.

RF-Lambda products are not warranted or authorized for use as critical components in medical, life-saving, or life sustaining applications, or other applications where a failure would reasonably be expected to cause severe personal injury or death.

50W WR34 Waveguide Circulator 15-22GHz