

# ADAPTER, BETWEEN SERIES 3.5mm / 1.85mm

**DC - 34 GHz**



MODELS: 5254, 5255, 5256, 5257

## SPECIFICATIONS:

### Electrical:

Frequency Range \_\_\_\_\_ DC – 34 GHz  
 VSWR \_\_\_\_\_ 1.30:1 Max.  
 Impedance \_\_\_\_\_ 50 Ohms  
 Operating Temp. Range \_\_\_\_\_ -65°C to +125°C

### Mechanical:

3.5mm Connectors \_\_\_\_\_ Passivated Stainless Steel  
 Mates both Electrically and Mechanically with all  
 SMA & K\* Series Connectors.  
 1.85mm Connectors \_\_\_\_\_ Passivated Stainless Steel  
 (Mates with 2.4mm & V\* Connectors)  
 Conductors \_\_\_\_\_ Gold Plated Beryllium Copper

\*V & \*K are trademarks of Anritsu Corp.

Model Number: **5254**  
 3.5mm Female to 1.85mm Male

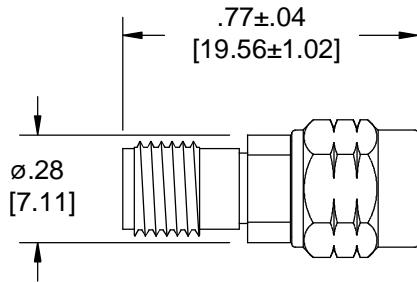

Model Number: **5255**  
 3.5mm Male to 1.85mm Female

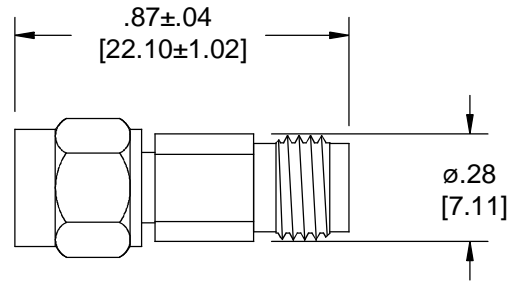

Model Number: **5256**  
 3.5mm Female to 1.85mm Female

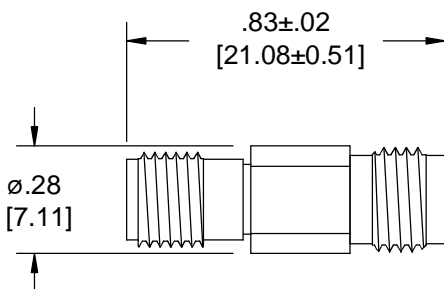

Model Number: **5257**  
 3.5mm Male to 1.85mm Male

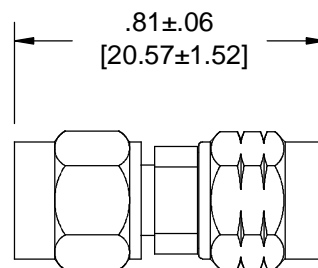

Note: Dimensions in Brackets are Expressed in Millimeters and are for Reference Only.  
 Design specifications are subject to change without notice.  
 Contact factory for technical specifications before purchasing or use.

5257; REV A