

REVISIONS				
ZONE	REV	DESCRIPTION	Date	APPROVED

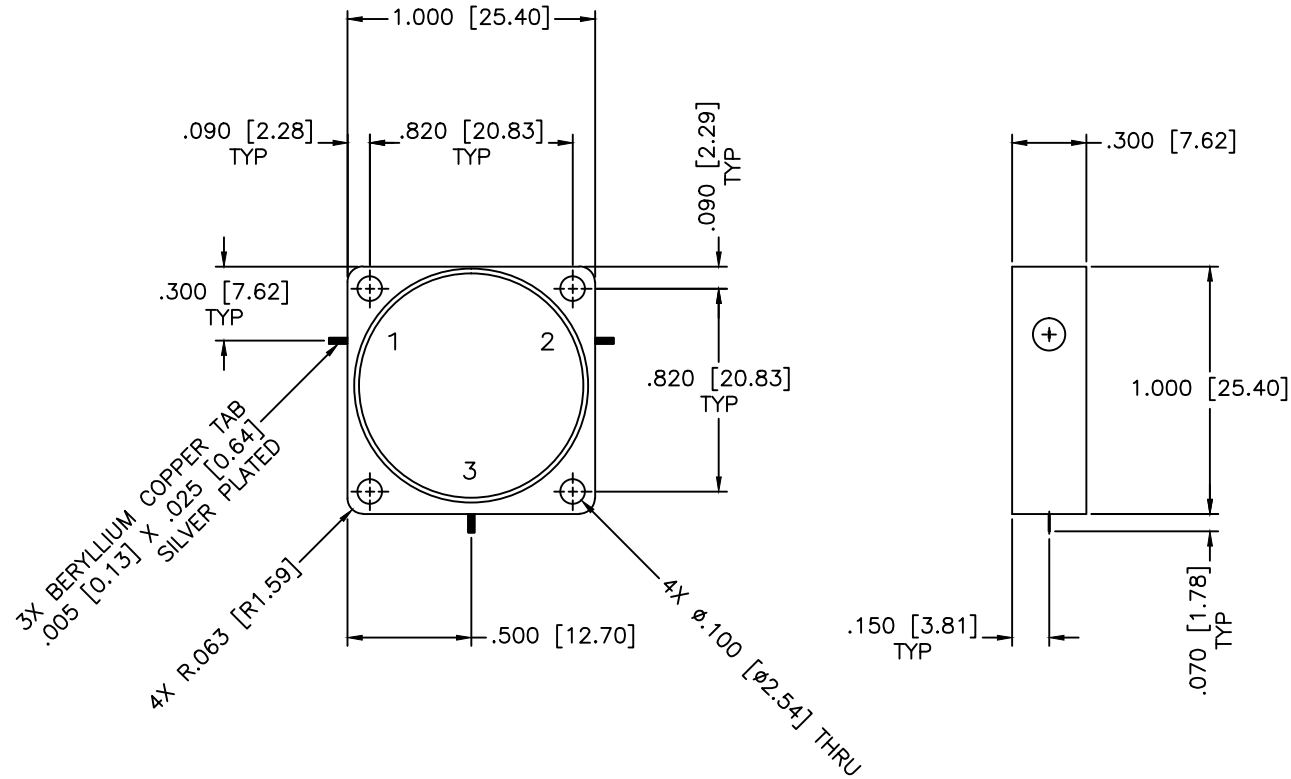

SPECIFICATIONS

Frequency Range: 1.62–1.66 GHz
 Isolation: 20dB Min.
 Insertion loss: 0.3dB Max.
 VSWR: 1.22:1 Max.
 Operating Temperature: -40°C to +85°C
 Power: 100W Avg. 500W Peak

MATERIAL:		MCLI MICROWAVE COMMUNICATIONS LABORATORIES INC. 7255 30TH AVE. N. SAINT PETERSBURG, FL 33710 TEL: (727) 344-6254 FAX: (727) 381-6116 http://WWW.MCLI.COM	SCALE:	N/A
			SHEET:	N/A
UNLESS OTHERWISE SPECIFIED: TOLERANCES IN (INCHES) OR [mm] (MILLIMETERS) FRACTIONS: ± 1/64 DECIMALS: ± .01 ± .005 ANGLE: ± 1/2°		DRAWING TITLE: DROP-IN CIRCULATOR		
DRAWN: Paiboon Luekhamhan		PART NO.: MC-24		
DATE: 06-21-2010		CAGE CODE: OD2L5		
APPROVED: T. Nguyen		SIZE: N/A		
DATE: 06-21-2010		REV: N/A		
THIRD ANGLE PROJECTION		DWG NO.: 84926		
		DO NOT SCALE THE DRAWING		