

TERMINATION, FLANGED

DC-2.7 GHz, 250 WATTS

SPECIFICATIONS:

Electrical:

Frequency Range _____ DC - 2.7 GHz
Ohm Value** _____ 50 \pm 5% Ohms Standard
Power Handling* _____ 250 Watts Average
Derated Linearly to 0 Watts @ +150°C
VSWR _____ 1.35:1 Max.
Operating Temp. Range _____ -55°C to +150°C

Mechanical:

Substrate _____ Aluminum Nitride
Resistor Material _____ Proprietary Thin Film
Cover _____ Alumina Ceramic
Flange _____ Nickel Plated Copper
Tab _____ Gold Plated Beryllium Copper

*Mounting Surface Shall not Exceed 100°C Max.

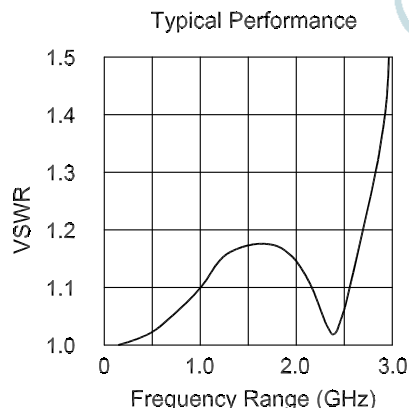

Model Number: ANT975-250-50R0J Shown

Tolerance: .XXX = \pm .010

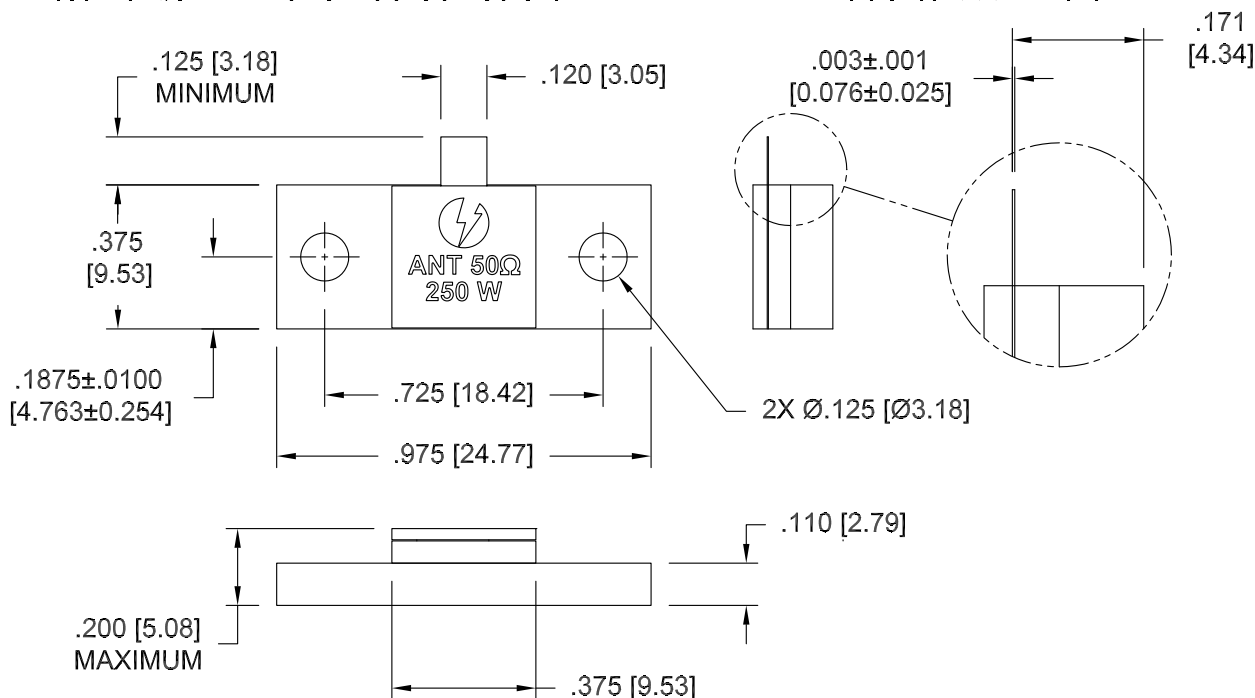

HOW TO ORDER

Model Number: ANT975-250-XXXXY

**Ohm Value _____ Tolerance _____
50R0 = 50 Ohms G = \pm 2%
1000 = 100 Ohms J = \pm 5%
(Other Values Available)

Note: Dimensions in Brackets are Expressed in Millimeters and are for Reference Only.
Design Specifications are subject to change without notice.

OL-ANT975-250; REV C



Aeroflex / Inmet, Inc. • 300 Dino Drive, Ann Arbor, MI 48103 • U.S.A.
888-244-6638 or 734-426-5553 • FAX: 734-426-5557
www.aeroflex-inmetcorp.com • sales@aeroflex-inmetcorp.com