

ADAPTERS, BETWEEN-SERIES

BNC / SMA , DC - 8 GHz

SPECIFICATIONS:

Models: 5011, 5012, 5013, 5014

RoHS
Compliant

AEROFLEX
A passion for performance.

Electrical:

Frequency Range _____ DC - 8 GHz
VSWR _____ 1.25:1 Max.
Impedance _____ 50 Ohms
Operating Temp. Range _____ -65°C to +125°C

Mechanical:

SMA Connectors _____ Passivated Stainless Steel
Mates with MIL-STD-348
BNC Connectors _____ Nickel Plated Brass
Mates with MIL-STD-348
Conductors _____ Gold Plated Beryllium Copper

Model Number: **5011**
BNC Male / SMA Male

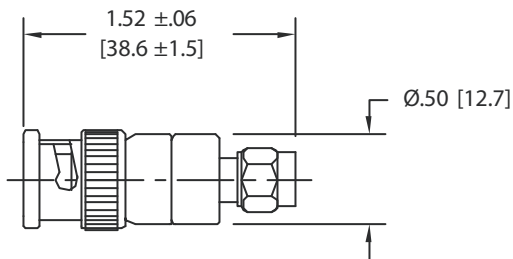

Model Number: **5013**
BNC Male / SMA Female

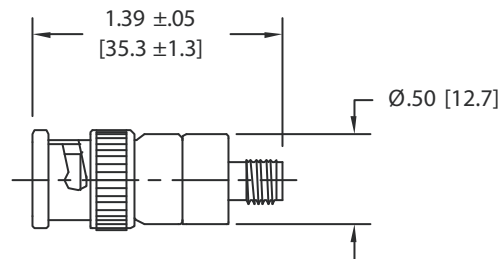

Model Number: **5012**
BNC Female / SMA Male

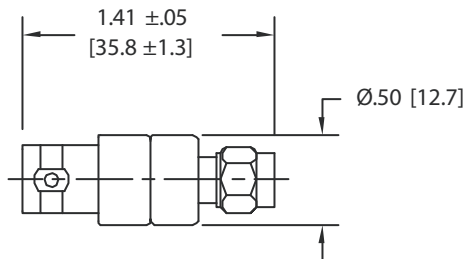

Model Number: **5014**
BNC Female / SMA Female

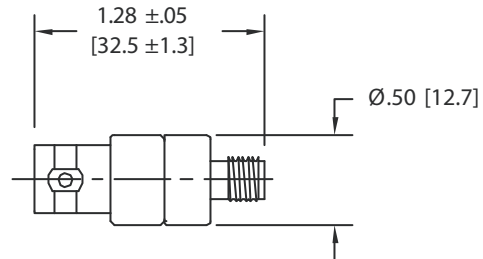

Note: Dimensions in Brackets are Expressed in Millimeters and are for Reference Only.

5011: REV B

AEROFLEX
INMET

Aeroflex / Inmet, Inc. • 300 Dino Drive, Ann Arbor, MI 48103 • U.S.A.
888-244-6638 or 734-426-5553 • FAX: 734-426-5557
www.aeroflex.com/inmet • inmet@aeroflex.com