

MECHANICAL
CONTACT: BREAK BEFORE MAKE
ACTUATOR: LATCHING
SWITCHING SPEED: 20 mSEC MAX

ELECTRICAL
ACTUATOR VOLTAGE: 28.0 ± 3.0 Vdc
ACTUATOR CURRENT: 0.350 A MAX @ 28.0 Vdc
POWER HANDLING: 350 WCW @ 1.0 GHz
IMPEDANCE: 50 OHMS

ENVIRONMENTAL
OPERATING TEMP: -54°C to $+90^{\circ}\text{C}$
SINE VIBRATION: 30 G'S rms
LIFE : 1,000,000 CYCLES
RANDOM VIBRATION: 20 G'S rms

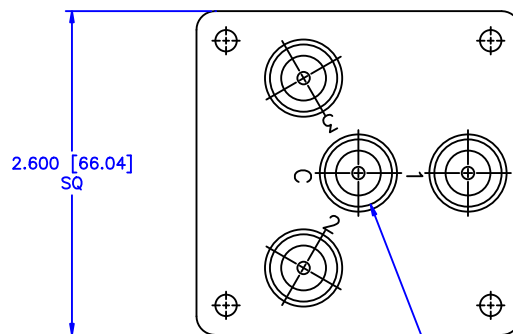

(4) TYPE SC CONNECTOR
(3) EQUALLY SPACED AT 120°
ON $\phi 1.760$ [44.7] B.C.

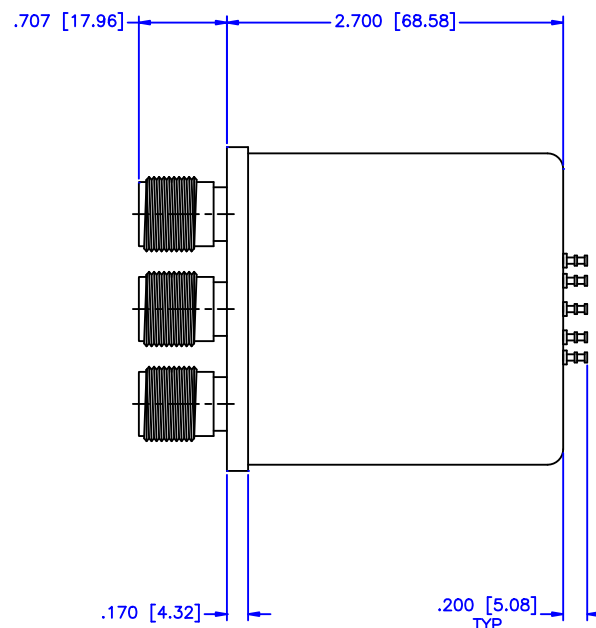
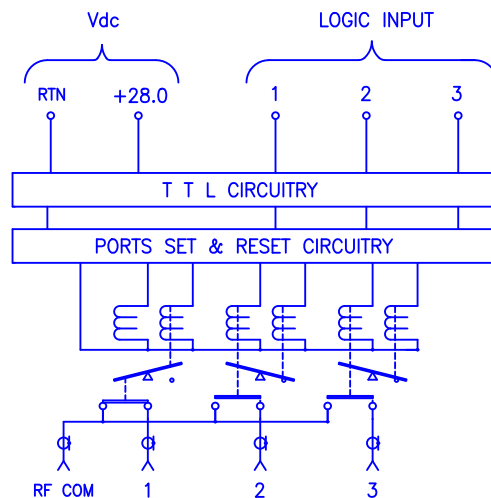

SPECIFICATION:

FREQUENCY RANGE (GHz): DC-1.0
VSWR (Max.): 1.20:1
INSERTION LOSS (dB): 0.20
ISOLATION (dB): 90

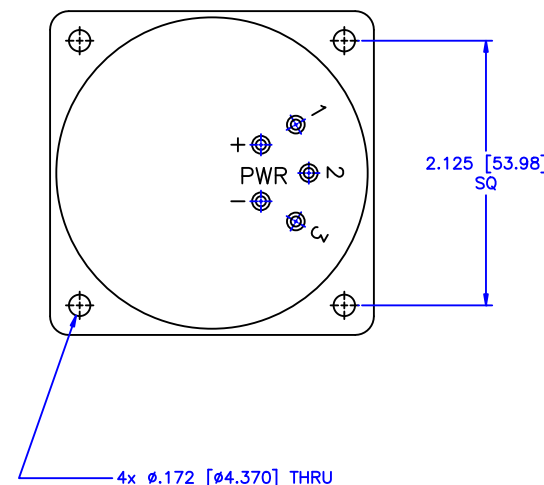

MATERIAL:		MCLI MICROWAVE COMMUNICATIONS LABORATORIES INC. 7255 30TH AVE. N. SAINT PETERSBURG, FL 33710 TEL: (727) 344-6254 FAX: (727) 381-6116 http://WWW.MCLI.COM		SCALE: N/A
UNLESS OTHERWISE SPECIFIED: TOLERANCES IN (INCHES) OR (mm) (MILLIMETERS) FRACTIONS: $\pm 1/64$ DECIMALS: ± 0.01 ± 0.005 ANGLE: $\pm 1/2^{\circ}$		DRAWING TITLE: ELECTROMECHANICAL SWITCHES		
DRAWN: Paiboon Luekhamhan		PART NO.: D3-1-LL/SC		
DATE: 09-24-2003		CAGE CODE: 0D2L5		
APPROVED: T. Nguyen		SIZE: A		
DATE: 09-24-2003		REV: N/A		
THIRD ANGLE PROJECTION		DWG NO.: 82294		
		DO NOT SCALE THE DRAWING		