

### Isolators: Connectorized

**CMI** has achieved strong capability in developing and manufacturing isolators and circulators. All of our designs are rated conservatively to ensure the utmost in reliability and successful system performance.

**CMI** offers a wide range of narrow and wide bandwidth RF and microwave isolator and circulator products in coaxial, drop-in and waveguide configurations that extend from 300MHz to 18GHz frequency ranges. You can select from the products listed below or send us specific requirements so that we can meet your needs better.

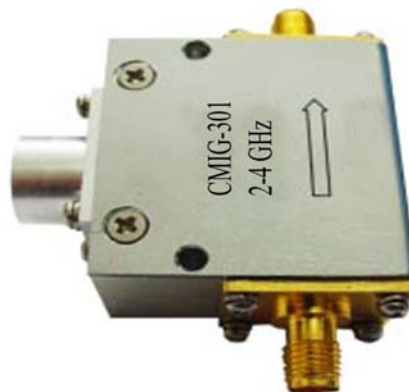

#### Specification:

Forward power: 10/50/100 watts

Reverse power: 1 watt

Connector: SMA or N

#### Order:

When ordering, please specify the center frequency ( in GHz),Bandwidth (in MHz), Forward power etc.

Example: TGG101-0.5-100-10, means: Isolator TGG101,center frequency=0.5 GHz, bandwidth=100 MHZ and Forward power 10 watts

#### Note:

Other special requirements are available, please contact the factory to discuss your requirements.

**CALL OUR SALES DEPARTMENT FOR MORE INFORMATION OR VARIATIONS OF THIS PRODUCT.**

**Corry Micronics, Inc. One Plastics Rd. - Corry, PA 16407**  
**(814) 664-7728 Fax (814) 664-4582 [www.cormic.com](http://www.cormic.com)**

Corry Micronics Inc. herein referred to CMI, believes this information to be accurate, but makes no warranties, expressed or implied as to the accuracy of this document. CMI assumes no liability for any injury, loss, damage, direct or consequential arising from the use of our products. User assumes all risk whatsoever in connection with it's intended use. CMI also reserves the right to change this document without notice.

ISOLATOR MODEL NUMBER	FREQUENCY RANGE (GHz)	BANDWIDTH (MHz)	ISOLATION (dB Min.)	VSWR (MAX.)	INSERTION LOSS (dB MAX.)	OPERATING TEMPERATURE DEGREES C	OUTLINE
CMIH101	0.3-0.8	50	23	1.2:1	0.4	-40 to +70	1
		100	20	1.25:1	0.5	-40 to +70	1
CMIH201	0.75-1.4	50	25	1.15:1	0.3	-40 to +70	2
		100	23	1.20:1	0.4	-40 to +70	2
		250	20	1.25:1	0.5	-40 to +70	2
CMIH201B	0.75-1.7	50	25	1.15:1	0.3	-40 to +70	3
		100	23	1.20:1	0.4	-40 to +70	3
		250	20	1.25:1	0.5	-40 to +70	3
CMIG202B	0.75 ~ 1.7	50	25	1.15:1	0.3	-40 to +70	16
		100	23	1.20:1	0.4	-40 to +70	16
		200	20	1.25:1	0.5	-40 to +70	16
	0.9 ~ 1.225	FULL	20	1.30:1	0.6	-40 to +70	16
CMIG206	0.8-1.7	50	50	1.15:1	0.6	-40 to +70	4
		100	45	1.20:1	0.8	-40 to +70	4
		200	40	1.25:1	1.0	-40 to +70	4
CMIG301	2-4	200	25	1.15:1	0.3	-40 to +70	5
		600	23	1.20:1	0.4	-40 to +70	5
		FULL	20	1.25:1	0.5	-40 to +70	5
CMIG305	1.8-4.2	200	25	1.15:1	0.3	-40 to +70	6
		400	23	1.20:1	0.4	-40 to +70	6
CMIG308	2.6-3.6	100	50	1.15:1	0.5	-40 to +70	7
		200	45	1.20:1	0.6	-40 to +70	7
		400	40	1.25:1	0.8	-40 to +70	7
CMIG401	2.5-6.0	400	25	1.15:1	0.3	-40 to +70	8
		600	23	1.20:1	0.3	-40 to +70	8
		1000	20	1.25:1	0.4	-40 to +70	8
CMIG402	3.0-8.0	400	23	1.15:1	0.3	-40 to +70	9
		800	20	1.25:1	0.4	-40 to +70	9
		2000	20	1.30:1	0.4	-40 to +70	9
CMIG402	2.0-4.0	FULL	20	1.20:1	0.5	-40 to +70	9

**CALL OUR SALES DEPARTMENT FOR MORE INFORMATION OR VARIATIONS OF THIS PRODUCT.**

**Corry Micronics, Inc. One Plastics Rd. - Corry, PA 16407**  
**(814) 664-7728 Fax (814) 664-4582 [www.cormic.com](http://www.cormic.com)**

Corry Micronics Inc. herein referred to CMI, believes this information to be accurate, but makes no warranties, expressed or implied as to the accuracy of this document. CMI assumes no liability for any injury, loss, damage, direct or consequential arising from the use of our products. User assumes all risk whatsoever in connection with it's intended use. CMI also reserves the right to change this document without notice.



# PRODUCT SPECIFICATION

CMIG406	4.0-8.0	300	50	1.25:1	0.6	-40 to +70	10
		600	45	1.40:1	0.8	-40 to +70	10
		1000	40	1.35:1	1.0	-40 to +70	10
CMIG501	8.0-10.0	200	25	1.15:1	0.3	-40 to +70	11
		400	23	1.20:1	0.4	-40 to +70	11
		800	20	1.25:1	0.5	-40 to +70	11
CMIA505	7.0-10.0	300	50	1.15:1	0.6	-40 to +70	12
		600	45	1.25:1	0.7	-40 to +70	12
		1000	40	1.22:1	0.8	-40 to +70	12
CMIG601	8.0-12.0	300	25	1.15:1	0.3	-40 to +70	13
		600	23	1.20:1	0.4	-40 to +70	13
		FULL	20	1.35:1	0.5	-40 to +70	13
	12.0-18.0	400	25	1.20:1	0.3	-40 to +70	13
		600	23	1.25:1	0.4	-40 to +70	13
		FULL	20	1.40:1	0.6	-40 to +70	13
	8.0-18.0	FULL	16	1.50:1	1.0	-54 to +85	13
CMIG601B	9.0-16.0	300	25	1.15:1	0.3	-54 to +85	14
		600	23	1.20:1	0.4	-54 to +85	14
CMIG603	8.5-16.0	500	50	1.15:1	0.5	-54 to +85	15
		1000	45	1.20:1	0.7	-54 to +85	15
		2000	40	1.25:1	1.0	-54 to +85	15

**CALL OUR SALES DEPARTMENT FOR MORE INFORMATION OR VARIATIONS OF THIS PRODUCT.**

**Corry Micronics, Inc. One Plastics Rd. - Corry, PA 16407**  
**(814) 664-7728 Fax (814) 664-4582 [www.cormic.com](http://www.cormic.com)**

Corry Micronics Inc. herein referred to CMI, believes this information to be accurate, but makes no warranties, expressed or implied as to the accuracy of this document. CMI assumes no liability for any injury, loss, damage, direct or consequential arising from the use of our products. User assumes all risk whatsoever in connection with it's intended use. CMI also reserves the right to change this document without notice.

### Outline Drawings:

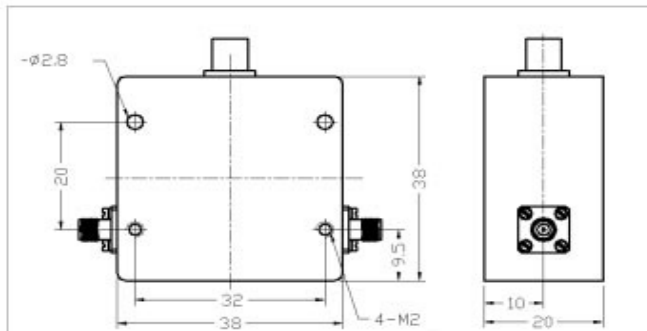

FIG.1 CMIG101

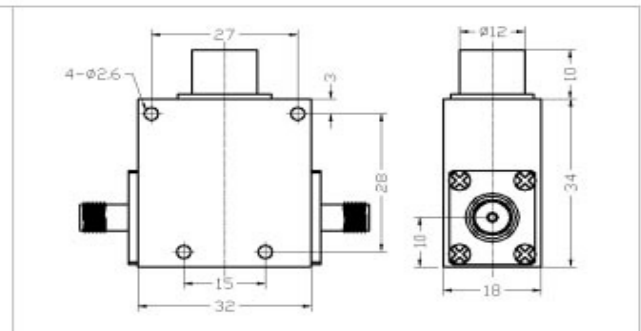

FIG.2 CMIG201

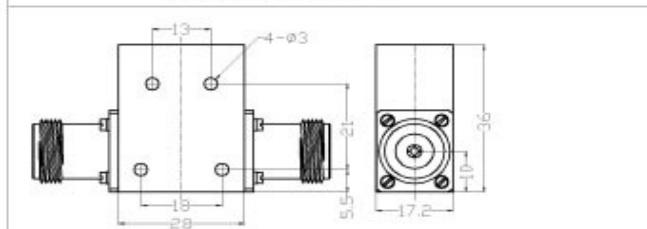

FIG.3 CMIG201B

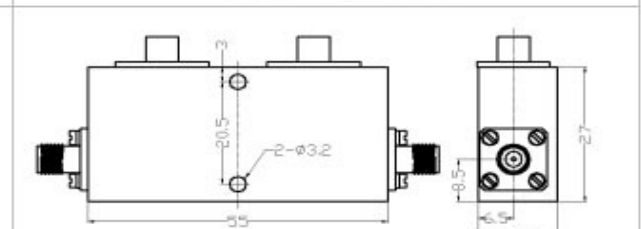

FIG.4 CMIG206

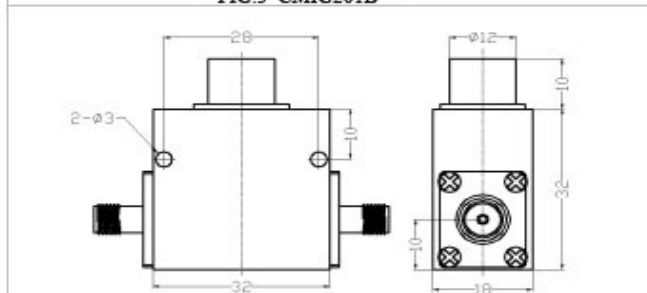

FIG.5 CMIG301

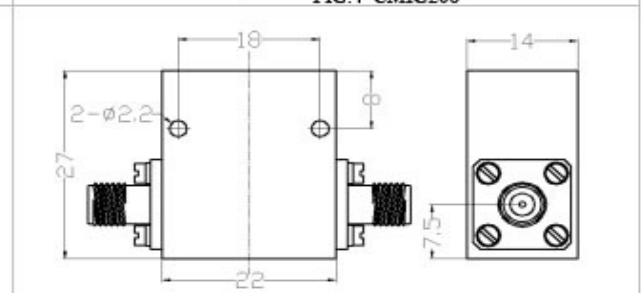

FIG.6 CMIG305

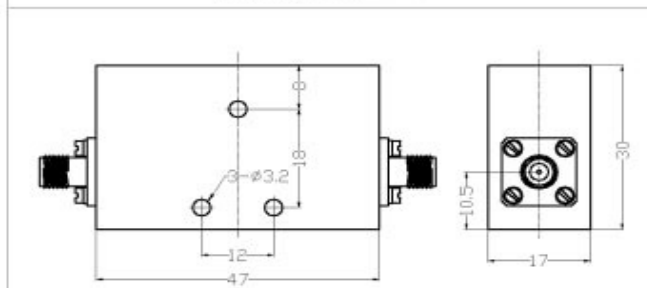

FIG.7 CMIG308

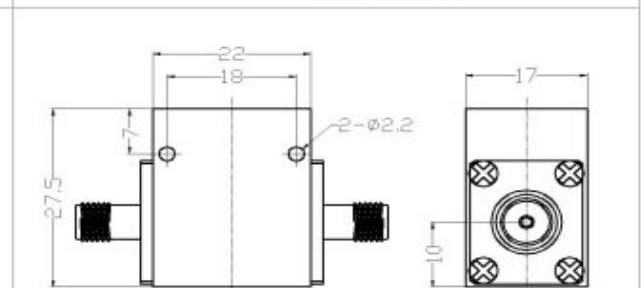
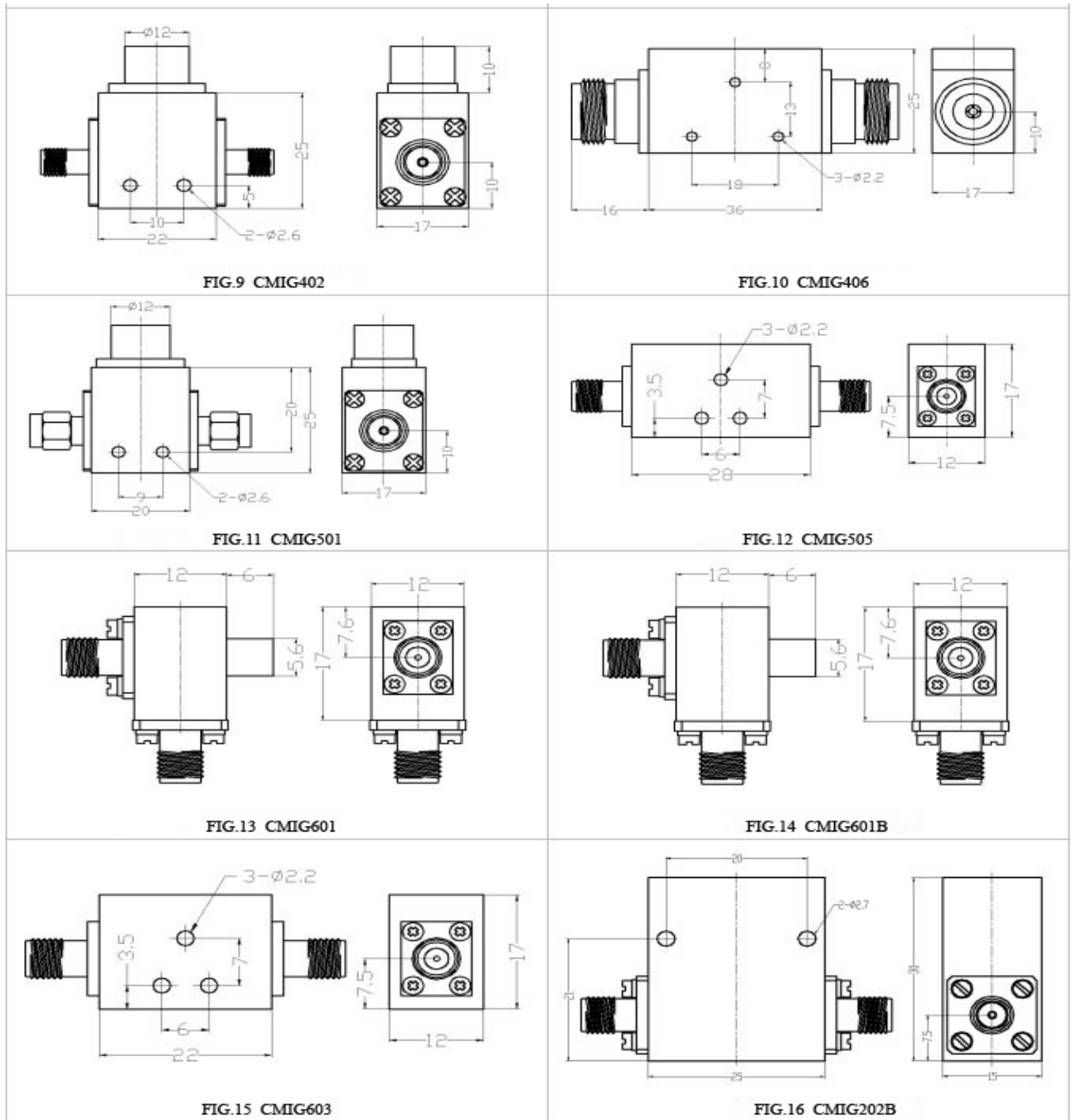

FIG.8 CMIG401

**CALL OUR SALES DEPARTMENT FOR MORE INFORMATION OR VARIATIONS OF THIS PRODUCT.**

**Corry Micronics, Inc. One Plastics Rd. - Corry, PA 16407**  
**(814) 664-7728 Fax (814) 664-4582 [www.cormic.com](http://www.cormic.com)**

Corry Micronics Inc. herein referred to CMI, believes this information to be accurate, but makes no warranties, expressed or implied as to the accuracy of this document. CMI assumes no liability for any injury, loss, damage, direct or consequential arising from the use of our products. User assumes all risk whatsoever in connection with it's intended use. CMI also reserves the right to change this document without notice.



**CALL OUR SALES DEPARTMENT FOR MORE INFORMATION OR VARIATIONS OF THIS PRODUCT.**

**Corry Micronics, Inc. One Plastics Rd. - Corry, PA 16407**  
**(814) 664-7728 Fax (814) 664-4582 [www.cormic.com](http://www.cormic.com)**

Corry Micronics Inc. herein referred to CMI, believes this information to be accurate, but makes no warranties, expressed or implied as to the accuracy of this document. CMI assumes no liability for any injury, loss, damage, direct or consequential arising from the use of our products. User assumes all risk whatsoever in connection with it's intended use. CMI also reserves the right to change this document without notice.

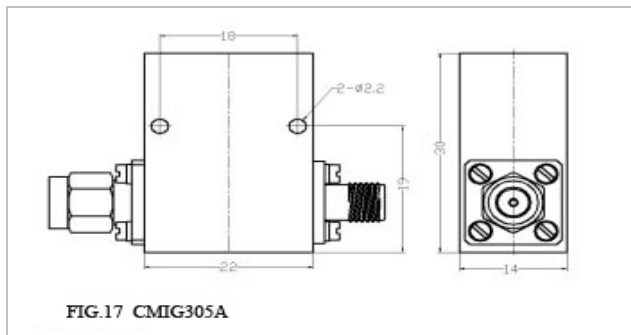

**CALL OUR SALES DEPARTMENT FOR MORE INFORMATION OR VARIATIONS OF THIS PRODUCT.**

**Corry Micronics, Inc. One Plastics Rd. - Corry, PA 16407**  
**(814) 664-7728 Fax (814) 664-4582 [www.cormic.com](http://www.cormic.com)**

Corry Micronics Inc. herein referred to CMI, believes this information to be accurate, but makes no warranties, expressed or implied as to the accuracy of this document. CMI assumes no liability for any injury, loss, damage, direct or consequential arising from the use of our products. User assumes all risk whatsoever in connection with it's intended use. CMI also reserves the right to change this document without notice.

### **Isolators: Dropin**

**CMI** has achieved strong capability in developing and manufacturing isolators and circulators. All of our designs are rated conservatively to ensure the utmost in reliability and successful system performance.

**CMI** offers a wide range of narrow and wide bandwidth RF and microwave isolator and circulator products in coaxial, drop-in and waveguide configurations that extend from 300MHz to 18GHz frequency ranges. You can select from the products listed below or send us specific requirements so that we can meet your needs better.

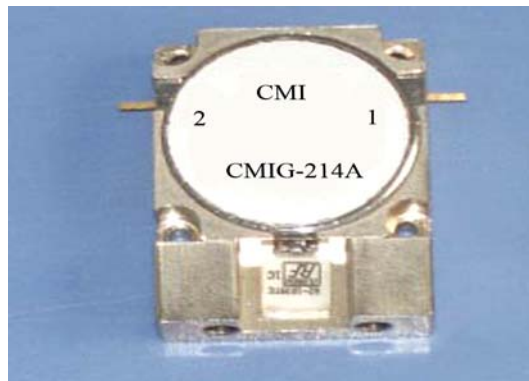

**Specification:**

Forward power: 10/50/100 watts

Reverse power: 1 watt

**Order:**

When ordering, please specify the center frequency ( in GHz), Bandwidth (in MHz), Forward power etc.

Example: TGG101-0.5-100-10, means: Isolator TGG101, center frequency=0.5 GHz, bandwidth=100 MHz and Forward power 10 watts

**Note:**

Other special requirements are available, please contact the factory to discuss your requirements.

**CALL OUR SALES DEPARTMENT FOR MORE INFORMATION OR VARIATIONS OF THIS PRODUCT.**

**Corry Micronics, Inc. One Plastics Rd. - Corry, PA 16407**  
**(814) 664-7728 Fax (814) 664-4582 [www.cormic.com](http://www.cormic.com)**

Corry Micronics Inc. herein referred to CMI, believes this information to be accurate, but makes no warranties, expressed or implied as to the accuracy of this document. CMI assumes no liability for any injury, loss, damage, direct or consequential arising from the use of our products. User assumes all risk whatsoever in connection with it's intended use. CMI also reserves the right to change this document without notice.

ISOLATOR MODEL NUMBER	FREQUENCY RANGE (GHz)	BANDWIDTH (MHz)	ISOLATION (dB Min.)	VSWR (MAX.)	INSERTION LOSS (dB Max.)	OPERATING TEMPERATURE DEGREES C	OUTLINE
CMIG204	0.75-1.7	50	25	1.15:1	0.3	-40 to +70	1
		100	23	1.20:1	0.4	-40 to +70	1
		250	20	1.25:1	0.5	-40 to +70	1
CMIG210	0.75-1.7	50	25	1.15:1	0.3	-40 to +70	2
		100	23	1.20:1	0.4	-40 to +70	2
		250	20	1.25:1	0.5	-40 to +70	2
CMIG214	0.8-2.2	50	23	1.15:1	0.3	-40 to +70	3
		100	20	1.20:1	0.4	-40 to +70	3
	0.925-0.96	FULL	23	1.15:1	0.3	-40 to +70	3
	0.96-1.225	FULL	20	1.20:1	0.4	-40 to +70	3
	1.805-1.88	FULL	23	1.20:1	0.4	-40 to +70	3
CMIG214C	0.925-0.96	FULL	25	1.25:1	0.4	-10-+60	4
	1.805-1.88	FULL	25	1.25:1	0.4	-10-+60	4
	1.93-1.99	FULL	25	1.25:1	0.4	-10-+60	4
CMIG304	1.8-2.4	50	25	1.15:1	0.3	-40 to +70	3
		100	23	1.20:1	0.4	-40 to +70	3
		200	20	1.25:1	0.5	-40 to +70	3
CMIG306	1.8-4.2	200	25	1.20:1	0.3	-40 to +70	4
		400	23	1.25:1	0.4	-40 to +70	4
CMIG311A	2.5-3.5	300	20	1.20:1	0.4	-40 to +70	5
CMIG312	2.2-3.5	100	25	1.15:1	0.3	-25 to +70	6
		200	23	1.20:1	0.4	-25 to +70	6
		300	20	1.25:1	0.4	-25 to +70	6
CMIG404	3.7-6.5	300	25	1.15:1	0.25	-40 to +85	7
		600	23	1.22:1	0.5	-40 to +85	7
CMIG405	4.0-8.0	300	50	1.15:1	0.6	-40 to +85	8
		600	45	1.20:1	0.3	-40 to +85	8
CMIG504	6.0-9.0	300	23	1.20:1	0.3	-40 to +70	9
		600	20	1.25:1	0.4	-40 to +70	9
CMIA602	7.0-10.0	300	25	1.15:1	0.3	-40 to +70	10
		600	23	1.20:1	0.4	-40 to +70	10

**CALL OUR SALES DEPARTMENT FOR MORE INFORMATION OR VARIATIONS OF THIS PRODUCT.**

**Corry Micronics, Inc. One Plastics Rd. - Corry, PA 16407**  
**(814) 664-7728 Fax (814) 664-4582 [www.cormic.com](http://www.cormic.com)**

Corry Micronics Inc. herein referred to CMI, believes this information to be accurate, but makes no warranties, expressed or implied as to the accuracy of this document. CMI assumes no liability for any injury, loss, damage, direct or consequential arising from the use of our products. User assumes all risk whatsoever in connection with it's intended use. CMI also reserves the right to change this document without notice.



### Outline Drawings:

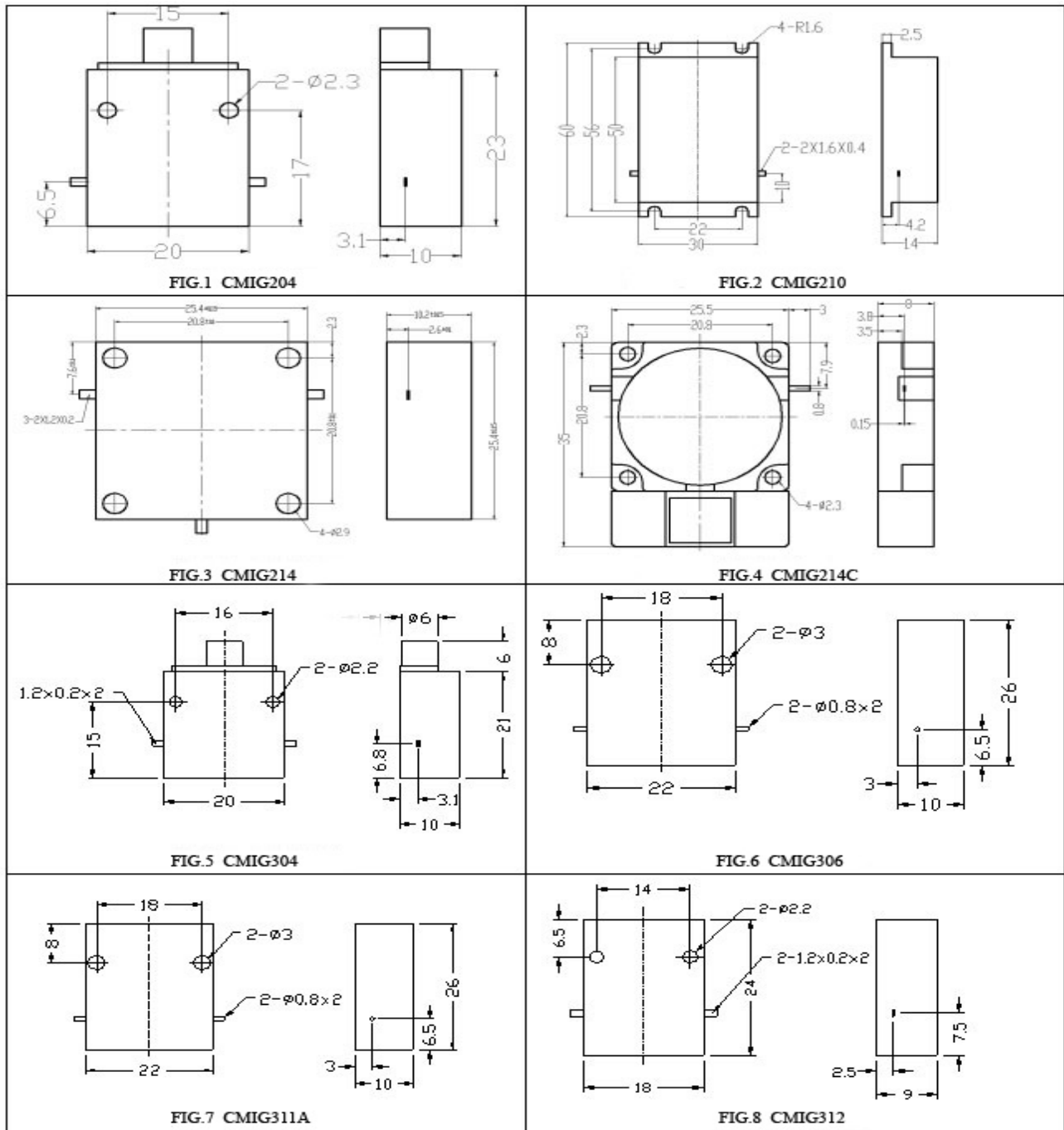

**CALL OUR SALES DEPARTMENT FOR MORE INFORMATION OR VARIATIONS OF THIS PRODUCT.**

**Corry Micronics, Inc. One Plastics Rd. - Corry, PA 16407**  
**(814) 664-7728 Fax (814) 664-4582 [www.cormic.com](http://www.cormic.com)**

Corry Micronics Inc. herein referred to CMI, believes this information to be accurate, but makes no warranties, expressed or implied as to the accuracy of this document. CMI assumes no liability for any injury, loss, damage, direct or consequential arising from the use of our products. User assumes all risk whatsoever in connection with it's intended use. CMI also reserves the right to change this document without notice.

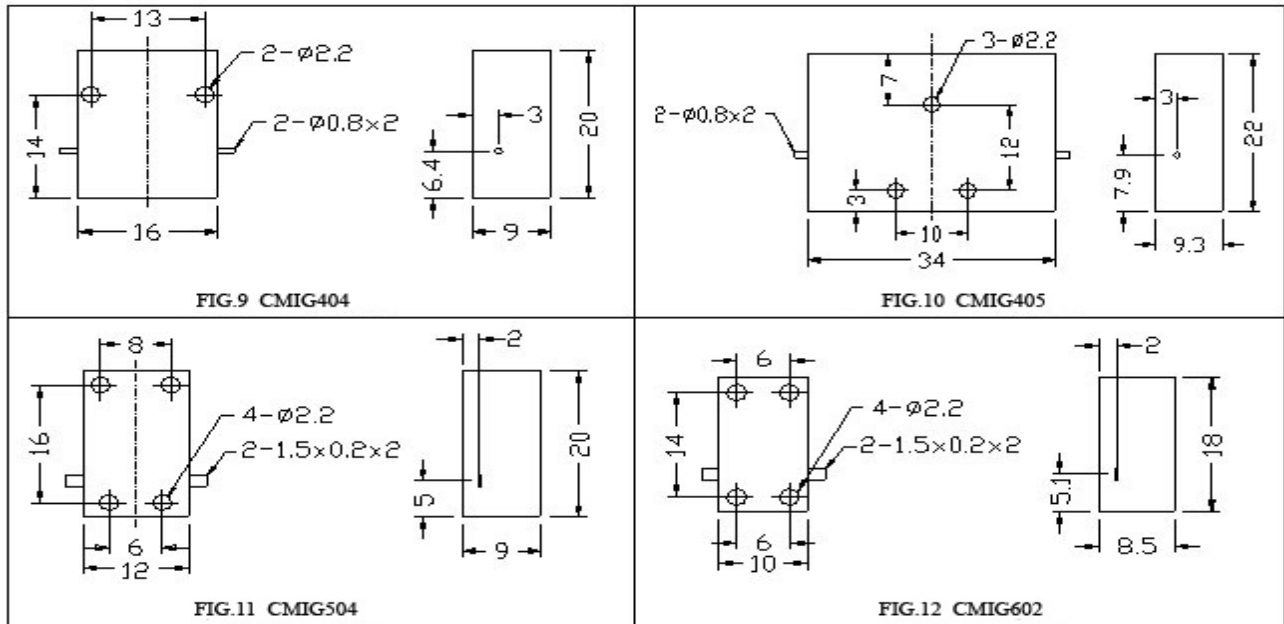

**CALL OUR SALES DEPARTMENT FOR MORE INFORMATION OR VARIATIONS OF THIS PRODUCT.**

**Corry Micronics, Inc. One Plastics Rd. - Corry, PA 16407**  
**(814) 664-7728 Fax (814) 664-4582 [www.cormic.com](http://www.cormic.com)**

Corry Micronics Inc. herein referred to CMI, believes this information to be accurate, but makes no warranties, expressed or implied as to the accuracy of this document. CMI assumes no liability for any injury, loss, damage, direct or consequential arising from the use of our products. User assumes all risk whatsoever in connection with it's intended use. CMI also reserves the right to change this document without notice.

**Lumped Element Isolators**

PART NUMBER	FREQ. RANGE ( GHz )	BANDWIDTH ( % )	IL (dB )	ISO (dB)	VSWR	POWER (W)	DIMENSION ( mm )				PACKAGE
							A	B	C	D	
CMIGL101	0.05 ~ 0.1	5 ~ 15	0.8	18	1.3	10					FIG.5
CMIGL102	0.1 ~ 0.9	20	0.6	20	1.25	30					FIG.6
CMIGL103	0.12 ~ 0.2	5 ~ 15	0.5	20	1.25	1200	250	130			FIG.2
CMIGL104	0.15 ~ 0.9	5	0.4	22	1.20	50					FIG.1
CMIGL105	0.15 ~ 0.9	10 ~ 20	0.6	20	1.25	10					FIG.1
CMIGL106	0.2 ~ 1.0	30 ~ 50	1.0	18	1.35	10					FIG.4
CMIGL107	0.2 ~ 0.4	5 ~ 15	0.5	20	1.25	1200	190	65			FIG.2
CMIGL108	0.36 ~ 0.7	15 ~ 20	0.6	20	1.3	300					FIG.3
CMIGL109	0.4 ~ 0.9	5 ~ 15	0.5	20	1.25	1200	120	40			FIG.2

**CALL OUR SALES DEPARTMENT FOR MORE INFORMATION OR VARIATIONS OF THIS PRODUCT.**

**Corry Micronics, Inc. One Plastics Rd. - Corry, PA 16407**  
**(814) 664-7728 Fax (814) 664-4582 [www.cormic.com](http://www.cormic.com)**

Corry Micronics Inc. herein referred to CMI, believes this information to be accurate, but makes no warranties, expressed or implied as to the accuracy of this document. CMI assumes no liability for any injury, loss, damage, direct or consequential arising from the use of our products. User assumes all risk whatsoever in connection with it's intended use. CMI also reserves the right to change this document without notice.

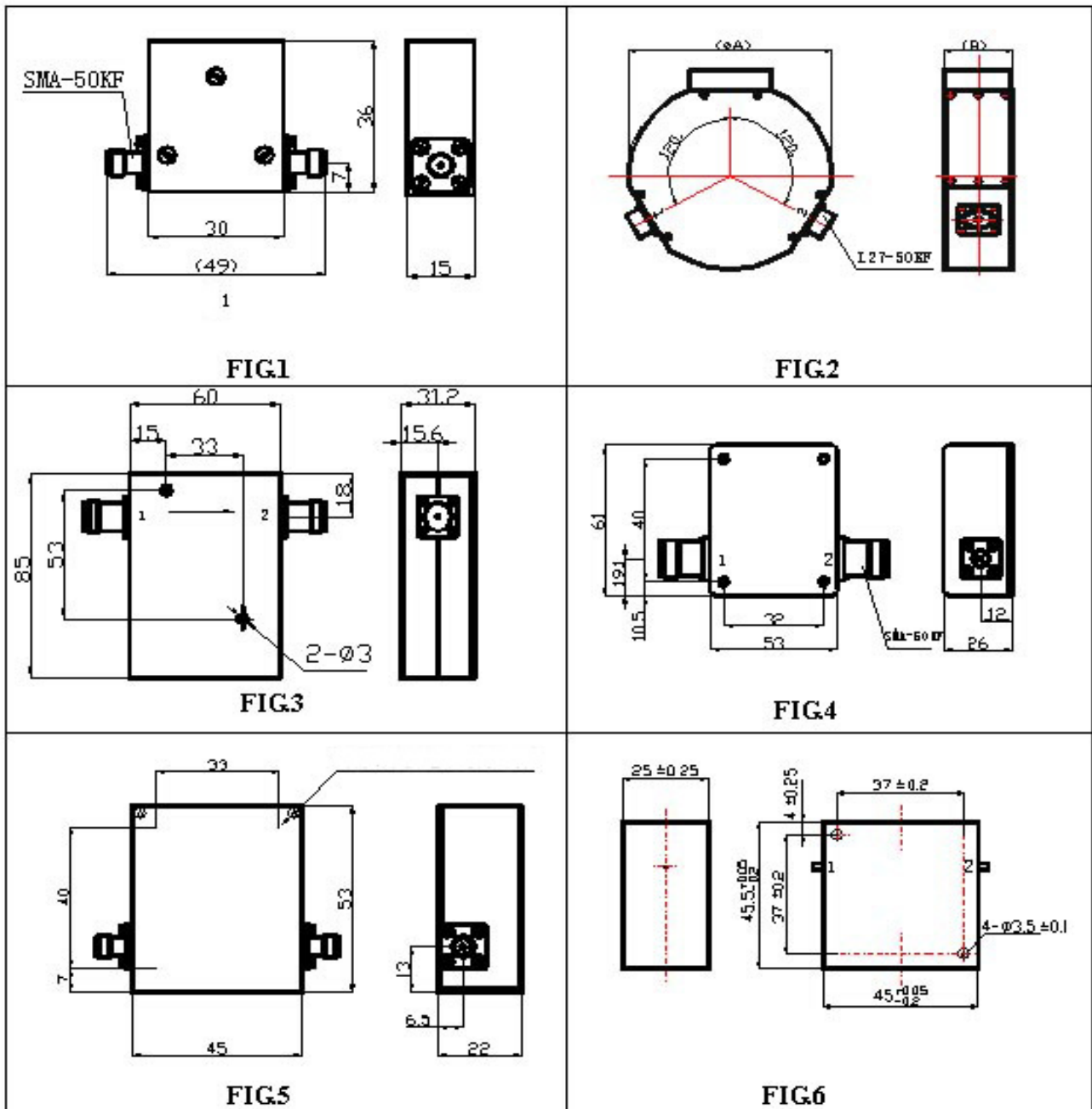

**CALL OUR SALES DEPARTMENT FOR MORE INFORMATION OR VARIATIONS OF THIS PRODUCT.**

**Corry Micronics, Inc. One Plastics Rd. - Corry, PA 16407**  
**(814) 664-7728 Fax (814) 664-4582 [www.cormic.com](http://www.cormic.com)**

Corry Micronics Inc. herein referred to CMI, believes this information to be accurate, but makes no warranties, expressed or implied as to the accuracy of this document. CMI assumes no liability for any injury, loss, damage, direct or consequential arising from the use of our products. User assumes all risk whatsoever in connection with it's intended use. CMI also reserves the right to change this document without notice.

### Waveguide Isolators and Circulators

CMI manufactures a selection of WG Isolators/Circulators ranging from WR28 to WR284.

Please call us with your requirements and discuss your needs with our design engineers.

The flange can choose following type according to your requirements:

1,CPRG, 2,CPRF, 3,COVER, 4,CHOKE. (COVER IS THE STANDARD)



### Waveguide Isolators

PART NUMBER	FREQ. (GHz)	BW (MHz)	INS. (dB)	ISO. (dB)	VSWR	TEMP. (C)	AVG. POWER(W)	PEAK POWER (kW)	WAVEGUIDE TYPE	LENGTH (mm)
CMIGS-1A	2.7-3.2	140	0.8	20	1.15	-40-+55	800	800	WR284	250
CMIGS-2	2.988-3.008	full	0.5	20	1.10	-10-+55	2000	2000	WR284	250
CMIGS-4A	2.7-3.2	100	1	20	1.20	-40-+70	2000	2000	WR284	310
CMIGX-12A	7.75-9.5	500	0.5	20	1.15	-55-+70	250	250	WR112	90
CMIGX-13	9.0-9.8	full	0.7	20	1.15	-55-+70	250	250	WR112	90
CMIGX-5	8.6-9.6	full	0.7	20	1.20	-55-+55	150	150	WR90	65
CMIGX-5A	8.5-10.5	300	0.5	20	1.15	-55-+55	150	150	WR90	65
CMIGX-5B	8.5-10.5	500	0.6	20	1.20	-55-+55	150	150	WR90	65
CMIGK-2	14.5-15.5	full	0.6	20	1.15	-55-+70	80	80	WR62	55
CMIGK-2A	12.8-17.5	800	0.8	20	1.15	-55-+70	80	80	WR62	55
CMIGK-4	14.5-16.5	full	0.6	20	1.15	-55-+70	120	120	WR62	55
CMIGK-4A	12.8-16.5	800	0.6	20	1.15	-55-+70	120	120	WR62	55
CMIGC-12	3.4-4.3	200	0.3	30	1.05	0-+45		58x10		130
CMIGX-8A	7.5-9	300	0.6	20	1.25	-25-+55			WR112	20
CMIGX-21	7.7-8.3	300	0.3	30	1.05	0-+45			WR112	100
CMIGX-1Az	8.5-10.5	400	0.6	20	1.30	-25-+55			WR90	15
CMIGX-1B	8.5-10.3	600	0.6	20	1.35	-25-+55			WR90	15
CMIGX-2A	8.5-9.6	full	0.6 6	15	1.15	+10-+60			WR90	35.
CMIGX-2	8.6-9.6	full	0.5	20	1.15	-10-+55			WR90	60
CMIGX-15	9-9.5	full	0.6	20	1.25	-25 ~ +55			WR90	30
CMIGK-1A	13.5-16.5	1000	0.7	20	1.15	-10-+55			WR62	80
CMIGK-5A	14.5-16.5	400	0.6	20	1.25	-10-+55			WR62	12

**CALL OUR SALES DEPARTMENT FOR MORE INFORMATION OR VARIATIONS OF THIS PRODUCT.**

**Corry Micronics, Inc. One Plastics Rd. - Corry, PA 16407**  
**(814) 664-7728 Fax (814) 664-4582 [www.cormic.com](http://www.cormic.com)**

Corry Micronics Inc. herein referred to CMI, believes this information to be accurate, but makes no warranties, expressed or implied as to the accuracy of this document. CMI assumes no liability for any injury, loss, damage, direct or consequential arising from the use of our products. User assumes all risk whatsoever in connection with it's intended use. CMI also reserves the right to change this document without notice.

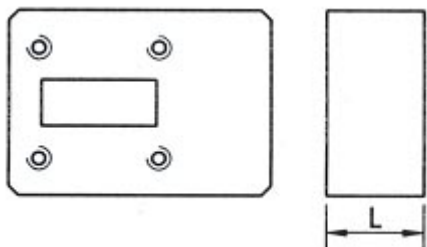

### Waveguide Circulators

TYPE	FREQ. (GHz)	BW (MHz)	INS. (dB)	ISO. (dB)	VSWR	TEMP. (°C)	AVG. POWER (W)	PEAK POWER (kW)	WAVEGUIDE TYPE	DIMENSION LxW (mm)
CMIHS-11	2.6-3.5	300	0.2	30	1.06 0-+45				WR284	110x120
CMIHC-12	3.4-4.2	200	0.2	30	1.06	0-+45			58x10	110x120
CMIHC-13	3.9-5.8	200	0.2	30	1.06	0-+45			WR187	110x120
CMIHC-21	5.9-6.4	full	0.2	28	1.06	0-+45			WR137	98x98.6
CMIHC-22	6.4-7.1	full	0.2	28	1.06	0-+45			WR137	100x103.6
CMIHC-23	7.1-7.7	full	0.2	28	1.06	0-+45			WR137	120x94
CMIHX-17	7.1-8.75	300	0.2	28	1.08	0-+45			WR112	60x60
CMIHX-16	7.1-8.75	600	0.25	28	1.08	0-+45			WR112	82x87
CMIHX-10	8.2-9.0	300	0.2	28	1.05	0-+45			WR90	48x53
CMIHX-15	10.7-11.7	full	0.25	28	1.08	-10-+45			WR90	60x60
CMIHK-3A	13.5-17.5	500	0.5	20	1.25	-25-+55			WR62	42x42
CMIH-31	2.6-3.5	10%	0.25	20	1.25	0-+45	2000	2000	WR284	110x120
CMIH-32	3.4-4.2	10%	0.25	20	1.25	0-+45	500	500	WR187	110x110
CMIH-33	3.9-5.8	10%	0.25	20	1.25	0-+45	500	500	WR187	110x110
CMIH-34	5.8-6.4	10%	0.25	20	1.25	0-+45	500	500	WR159	100x100
CMIH-35	6.4-7.1	10%	0.25	20	1.25	0-+45	500	500	WR159	100x100
CMIH-36	7.1-7.7	10%	0.25	20	1.25	0-+45	500	500	WR137	100x100
CMIH-37	7.7-8.8	10%	0.25	20	1.25	0-+45	300	300	WR112	90x90
CMIH-38	8.6-10	10%	0.25	20	1.25	0-+45	250	250	WR90	80x980
CMIH-39	10-12	10%	0.25	20	1.25	0-+45	200	200	WR90	80x80
CMIH-40	12-14	10%	0.25	20	1.25	0-+45	100	100	WR62	60x60
CMIH-41	13.8-17.5	10%	0.25	20	1.25	0-+45	80	80	WR62	60x60

**CALL OUR SALES DEPARTMENT FOR MORE INFORMATION OR VARIATIONS OF THIS PRODUCT.**

**Corry Micronics, Inc. One Plastics Rd. - Corry, PA 16407**  
**(814) 664-7728 Fax (814) 664-4582 [www.cormic.com](http://www.cormic.com)**

Corry Micronics Inc. herein referred to CMI, believes this information to be accurate, but makes no warranties, expressed or implied as to the accuracy of this document. CMI assumes no liability for any injury, loss, damage, direct or consequential arising from the use of our products. User assumes all risk whatsoever in connection with it's intended use. CMI also reserves the right to change this document without notice.

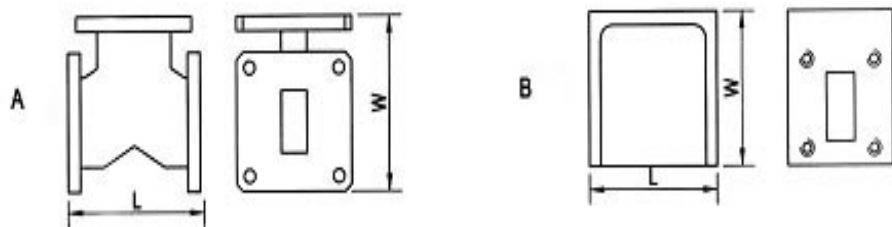

### Waveguide 4 Port Circulators

TYPE	FREQ. (GHz)	BW (MHz)	1→2 INS. (dB)	2→3 INS. (dB)	2→1 ISO. (dB)	1→3 ISO. (dB)	1→2 VSWR	TEMP. (°C)	AVG. POWER (W)	PEAK POWER (MW)	WAVEGUIDE TYPE	LENGTH (mm)
CMIP331	2.6-3.4	10%	0.4	0.4	20	20	1.2	-10-+50	2.6kw water	2.6	WR284	700
CMIP332	2.6-3.4	10%	0.5	0.5	20	20	1.2	-10-+50	5k water	5	WR284	700
CMIP333	2.6-3.4	10%	0.5	0.5	20	20	1.2	-10-+50	1k water	10	WR284	700
CMIP334	2.6-3.4	10%	0.5	0.5	20	20	1.2	-10-+50	10k water	1	WR284	700
CMIP351	4.8-5.8	10%	0.5	0.5	20	20	1.2	-10-+50	2k water	1	WR187	500
CMIP381	8.2-12	10%	0.5	0.5	20	20	1.2	-25-+60	300	0.3	WR90	300
CMIP382	8.2-12	10%	0.5	0.5	20	20	1.2	-25-+60	1k water	1.3	WR112	300
CMIP311	12.4-18	5%	0.5	0.5	20	20	1.2	-25-+60	120	0.07	WR62	200
CMIP312	14.5-15.5	16%	0.5	0.5	20	20	1.2	-25-+60	30	0.1	WR62	200

**CALL OUR SALES DEPARTMENT FOR MORE INFORMATION OR VARIATIONS OF THIS PRODUCT.**

**Corry Micronics, Inc. One Plastics Rd. - Corry, PA 16407**  
**(814) 664-7728 Fax (814) 664-4582 [www.cormic.com](http://www.cormic.com)**

Corry Micronics Inc. herein referred to CMI, believes this information to be accurate, but makes no warranties, expressed or implied as to the accuracy of this document. CMI assumes no liability for any injury, loss, damage, direct or consequential arising from the use of our products. User assumes all risk whatsoever in connection with it's intended use. CMI also reserves the right to change this document without notice.

### **Circulators: Connectorized**

**CMI** has achieved strong capability in developing and manufacturing isolators and circulators. All of our designs are rated conservatively to ensure the utmost in reliability and successful system performance.

**CMI** offers a wide range of narrow and wide bandwidth RF and microwave isolator and circulator products in coaxial, drop-in and waveguide configurations that extend from 300MHz to 18GHz frequency ranges. You can select from the products listed below or send us specific requirements so that we can meet your needs better.



#### **Specifications:**

Forward power: 10/50/100 watts

Reverse power: 1 watt

Connector: SMA or N

#### **Order:**

When ordering, please specify the center frequency ( in GHz), Bandwidth (in MHz), Forward power etc.

Example: TGH101-0.5-100-10, means: Circulator TGH101, center frequency=0.5 GHz, bandwidth=100 MHz and Forward power 10 watts

**Note:** Other special requirements are available, please contact the factory to discuss your requirements.

**CALL OUR SALES DEPARTMENT FOR MORE INFORMATION OR VARIATIONS OF THIS PRODUCT.**

**Corry Micronics, Inc. One Plastics Rd. - Corry, PA 16407**  
**(814) 664-7728 Fax (814) 664-4582 [www.cormic.com](http://www.cormic.com)**

Corry Micronics Inc. herein referred to CMI, believes this information to be accurate, but makes no warranties, expressed or implied as to the accuracy of this document. CMI assumes no liability for any injury, loss, damage, direct or consequential arising from the use of our products. User assumes all risk whatsoever in connection with it's intended use. CMI also reserves the right to change this document without notice.



CICULATOR MODEL NUMBER	FREQUENCY RANGE (GHz)	BANDWIDTH (MHz)	ISOLATION (dB Min.)	VSWR (MAX.)	INSERTION LOSS (dB Max.)	OPERATING TEMPERATURE DEGREES C	OUTLINE
CMIH101	0.3-0.8	50	23	1.2:1	0.4	-40 to +70	1
		100	20	1.25:1	0.5	-40 to +70	1
CMIH201	0.75-1.4	50	25	1.15:1	0.3	-40 to +70	2
		100	23	1.20:1	0.4	-40 to +70	2
		250	20	1.25:1	0.5	-40 to +70	2
CMIH202	0.8-1.7	50	23	1.15:1	0.3	-40 to +70	3
		100	20	1.20:1	0.4	-40 to +70	3
		200	18	1.25:1	0.5	-40 to +70	3
CMIH301	2-4	200	25	1.15:1	0.3	-40 to +70	4
		600	23	1.20:1	0.4	-40 to +70	4
		FULL	18	1.30:1	0.5	-40 to +70	4
CMI5H313	1.8-3.6	300	50	1.15:1	0.5	-25 to +70	6
		600	45	1.20:1	0.7	-25 to +70	6
		1000	40	1.25:1	0.8	-25 to +70	6
CMIH402	3.0-8.0	100	23	1.15:1	0.3	-40 to +85	7
		800	20	1.25:1	0.4	-40 to +85	7
		2000	20	1.30:1	0.4	-40 to +85	7
	4.0-8.0	FULL	20	1.35:1	0.5	-40 to +85	7
CMIH407	4.0-8.0	300	50	1.15:1	0.6	-40 to +85	8
		600	45	1.20:1	0.8	-40 to +85	8
		2000	40	1.25:1	0.8	-40 to +85	8
CMIH501	8.0-10.0	200	25	1.15:1	0.3	-40 to +85	9
		400	23	1.20:1	0.4	-40 to +85	9
		800	20	1.25:1	0.5	-40 to +85	9
CMIH601	8.0-12.0	300	25	1.15:1	0.3	-40 to +85	10
		600	23	1.20:1	0.4	-40 to +85	10
		FULL	16	1.40:1	0.5	-40 to +85	10
	12.0-18.0	400	23	1.15:1	0.3	-40 to +85	10
		600	20	1.20:1	0.4	-40 to +85	10
		FULL	16	1.40:1	0.5	-40 to +85	10
	8.0-18.0	FULL	16	1.50:1	1.0	-40 to +85	10
		FULL	16	1.50:1	1.0	-40 to +85	10
CMIH305	1.8-4.2	100	23	1.15:1	0.3	-40 to +70	5
		200	20	1.20:1	0.4	-40 to +70	5
		400	18	1.25:1	0.5	-40 to +70	5

**CALL OUR SALES DEPARTMENT FOR MORE INFORMATION OR VARIATIONS OF THIS PRODUCT.**

**Corry Micronics, Inc. One Plastics Rd. - Corry, PA 16407**  
**(814) 664-7728 Fax (814) 664-4582 [www.cormic.com](http://www.cormic.com)**

Corry Micronics Inc. herein referred to CMI, believes this information to be accurate, but makes no warranties, expressed or implied as to the accuracy of this document. CMI assumes no liability for any injury, loss, damage, direct or consequential arising from the use of our products. User assumes all risk whatsoever in connection with it's intended use. CMI also reserves the right to change this document without notice.

**Note:**

INSERTION LOSS (Excluding coupled power)

Given for reference only, a value which is the internal power dissipation of the device not including the power routed to other ports.

\*\*All published specifications apply by using a matched designed test fixture with testing performed at 23°C. Tests include VSWR, insertion loss and isolation. All measurements are performed in a 50 ohm impedance test system.

**Outline Drawings:**

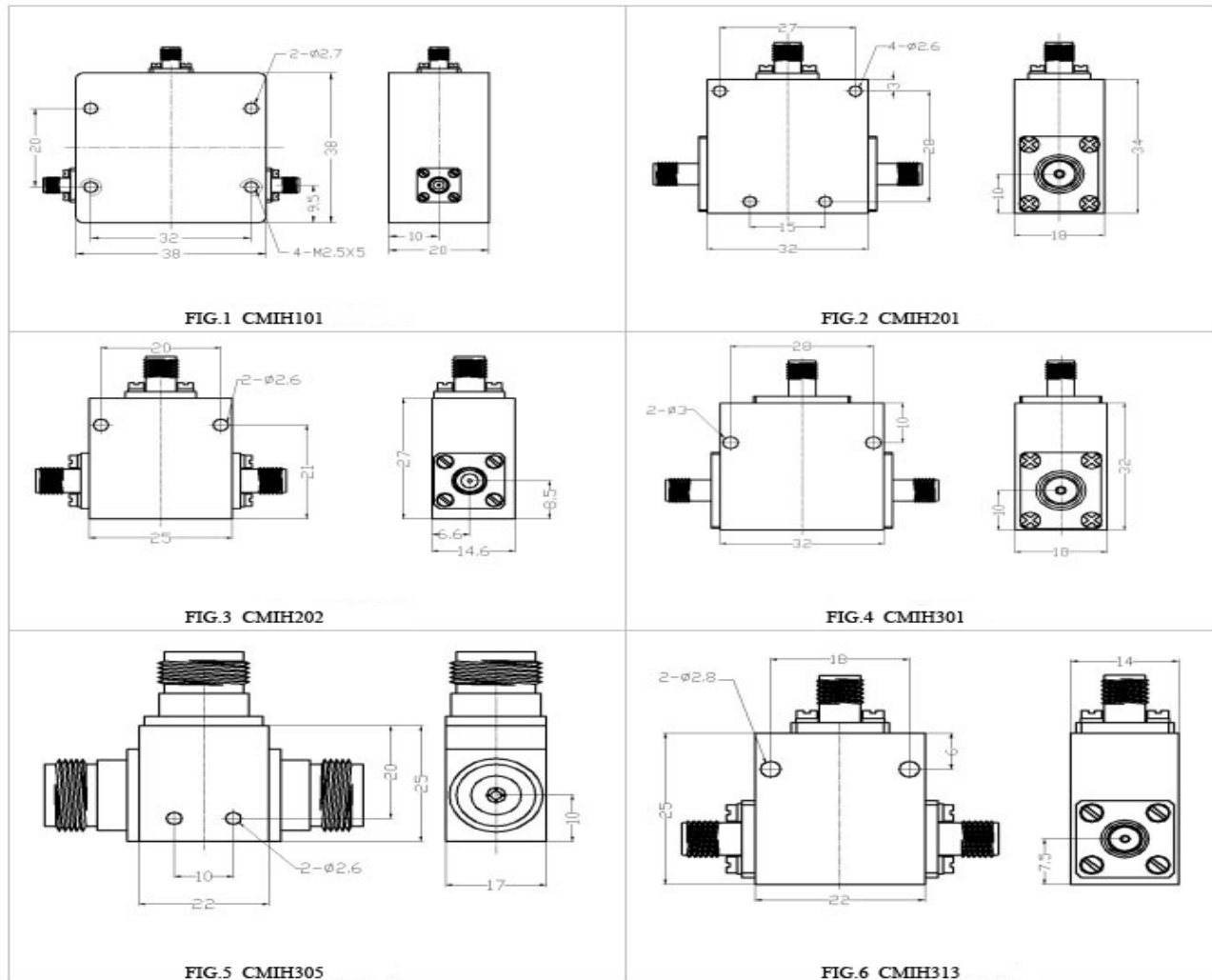

**CALL OUR SALES DEPARTMENT FOR MORE INFORMATION OR VARIATIONS OF THIS PRODUCT.**

**Corry Micronics, Inc. One Plastics Rd. - Corry, PA 16407**  
**(814) 664-7728 Fax (814) 664-4582 [www.cormic.com](http://www.cormic.com)**

Corry Micronics Inc. herein referred to CMI, believes this information to be accurate, but makes no warranties, expressed or implied as to the accuracy of this document. CMI assumes no liability for any injury, loss, damage, direct or consequential arising from the use of our products. User assumes all risk whatsoever in connection with it's intended use. CMI also reserves the right to change this document without notice.

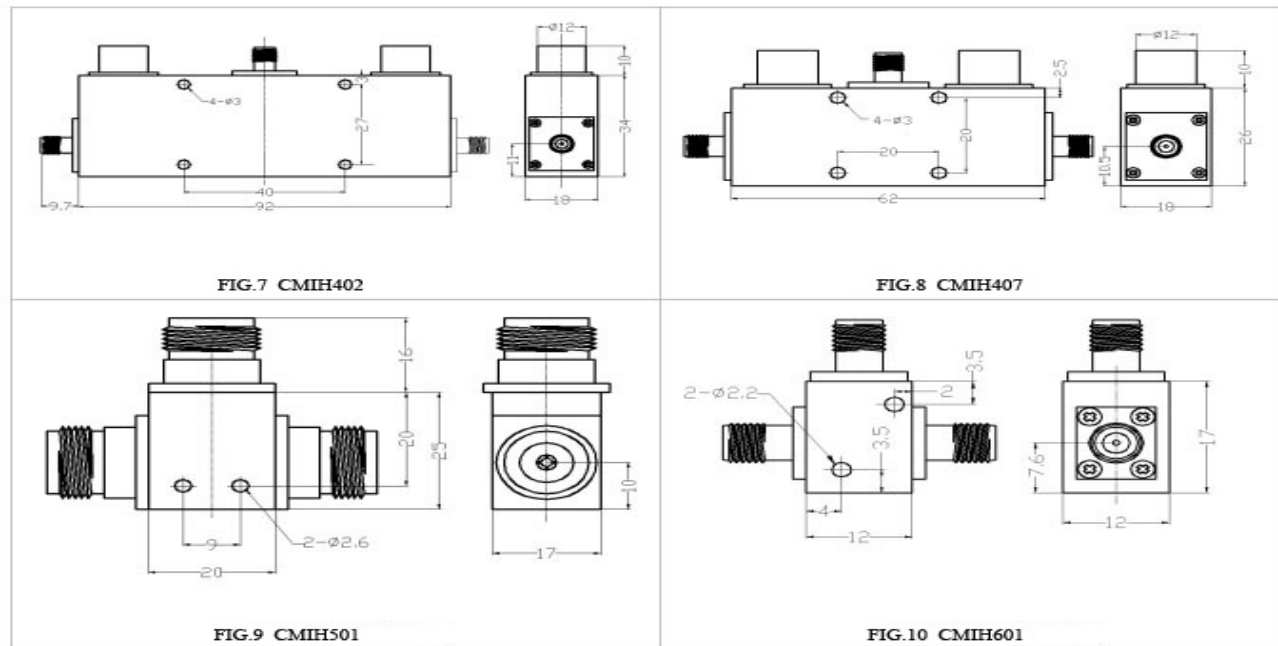

**CALL OUR SALES DEPARTMENT FOR MORE INFORMATION OR VARIATIONS OF THIS PRODUCT.**

**Corry Micronics, Inc. One Plastics Rd. - Corry, PA 16407**  
**(814) 664-7728 Fax (814) 664-4582 [www.cormic.com](http://www.cormic.com)**

Corry Micronics Inc. herein referred to CMI, believes this information to be accurate, but makes no warranties, expressed or implied as to the accuracy of this document. CMI assumes no liability for any injury, loss, damage, direct or consequential arising from the use of our products. User assumes all risk whatsoever in connection with it's intended use. CMI also reserves the right to change this document without notice.

### **Circulators: Dropin**

**CMI** has achieved strong capability in developing and manufacturing isolators and circulators. All of our designs are rated conservatively to ensure the utmost in reliability and successful system performance.

**CMI** offers a wide range of narrow and wide bandwidth RF and microwave isolator and circulator products in coaxial, drop-in and waveguide configurations that extend from 300MHz to 18GHz frequency ranges. You can select from the products listed below or send us specific requirements so that we can meet your needs better.

#### **Specifications:**

Forward power: 10/50/100 Watts

Reverse power: 1 Watt

#### **Order:**

When ordering, please specify the center frequency (in GHz),

Bandwidth (in MHz), Forward power etc.

Example: CMIH203-1.0-100-10, means: Circulator CMIH203, center frequency=1.0 GHz, bandwidth=100 MHz and Forward power 10 watts

#### **Note:**

Other special requirements are available, please contact the factory to discuss your requirements.

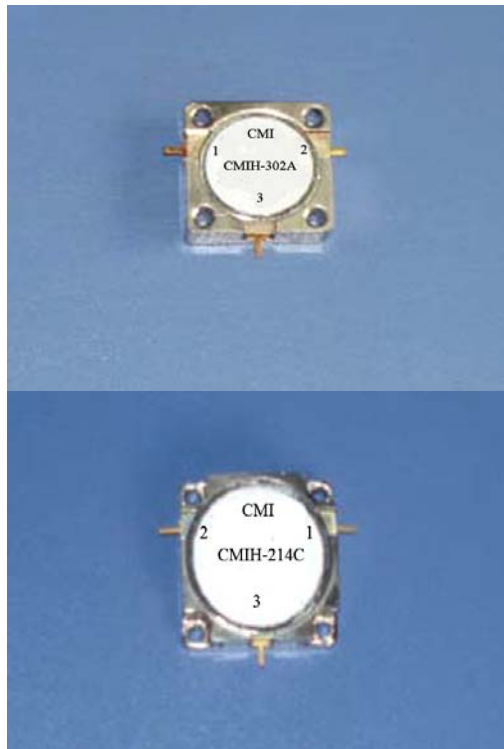

**CALL OUR SALES DEPARTMENT FOR MORE INFORMATION OR VARIATIONS OF THIS PRODUCT.**

**Corry Micronics, Inc. One Plastics Rd. - Corry, PA 16407**  
**(814) 664-7728 Fax (814) 664-4582 [www.cormic.com](http://www.cormic.com)**

Corry Micronics Inc. herein referred to CMI, believes this information to be accurate, but makes no warranties, expressed or implied as to the accuracy of this document. CMI assumes no liability for any injury, loss, damage, direct or consequential arising from the use of our products. User assumes all risk whatsoever in connection with it's intended use. CMI also reserves the right to change this document without notice.

ISOLATOR MODEL NUMBER	FREQUENCY RANGE (GHz)	BANDWIDTH (MHz)	ISOLATION (dB Min.)	VSWR (MAX.)	INSERTION LOSS (dB MAX.)	OPERATING TEMPERATURE DEGREES C	OUTLINE
CMIH203	0.8-1.7	50	23	1.15:1	0.3	-40 to +85	1
		100	20	1.20:1	0.4	-40 to +85	1
		200	18	1.25:1	0.5	-40 to +85	1
CMIH214	0.8-2.2	50	23	1.15:1	0.3	-40 to +70	2
		100	20	1.20:1	0.4	-40 to +70	2
	0.925-0.965	FULL	23	1.15:1	0.3	-40 to +70	2
	1.8-2.4	FULL	20	1.20:1	0.4	-40 to +70	2
	1.805-1.88	FULL	23	1.20:1	0.3	-40 to +70	2
CMIH214CTGG311A	0.925-0.96	FULL	25	1.20:1	0.4	-10-+60	3
		FULL	25	1.20:1	0.4	-10-+60	3
		FULL	25	1.20:1	0.4	-10-+60	3
CMIH306	1.8-4.2	100	23	1.15:1	0.3	-25 to +70	5
		200	20	1.20:1	0.4	-25 to +70	5
CMIH404	4.0-7.0	300	23	1.15:1	0.25	-40 to +85	6
		500	20	1.22:1	0.3	-40 to +85	6
CMIG404	7.0-10.0	300	23	1.20:1	0.3	-40 to +85	7
		600	20	1.25:1	0.4	-40 to +85	7

**CALL OUR SALES DEPARTMENT FOR MORE INFORMATION OR VARIATIONS OF THIS PRODUCT.**

**Corry Micronics, Inc. One Plastics Rd. - Corry, PA 16407**  
**(814) 664-7728 Fax (814) 664-4582 [www.cormic.com](http://www.cormic.com)**

Corry Micronics Inc. herein referred to CMI, believes this information to be accurate, but makes no warranties, expressed or implied as to the accuracy of this document. CMI assumes no liability for any injury, loss, damage, direct or consequential arising from the use of our products. User assumes all risk whatsoever in connection with it's intended use. CMI also reserves the right to change this document without notice.

### Outline Drawings:

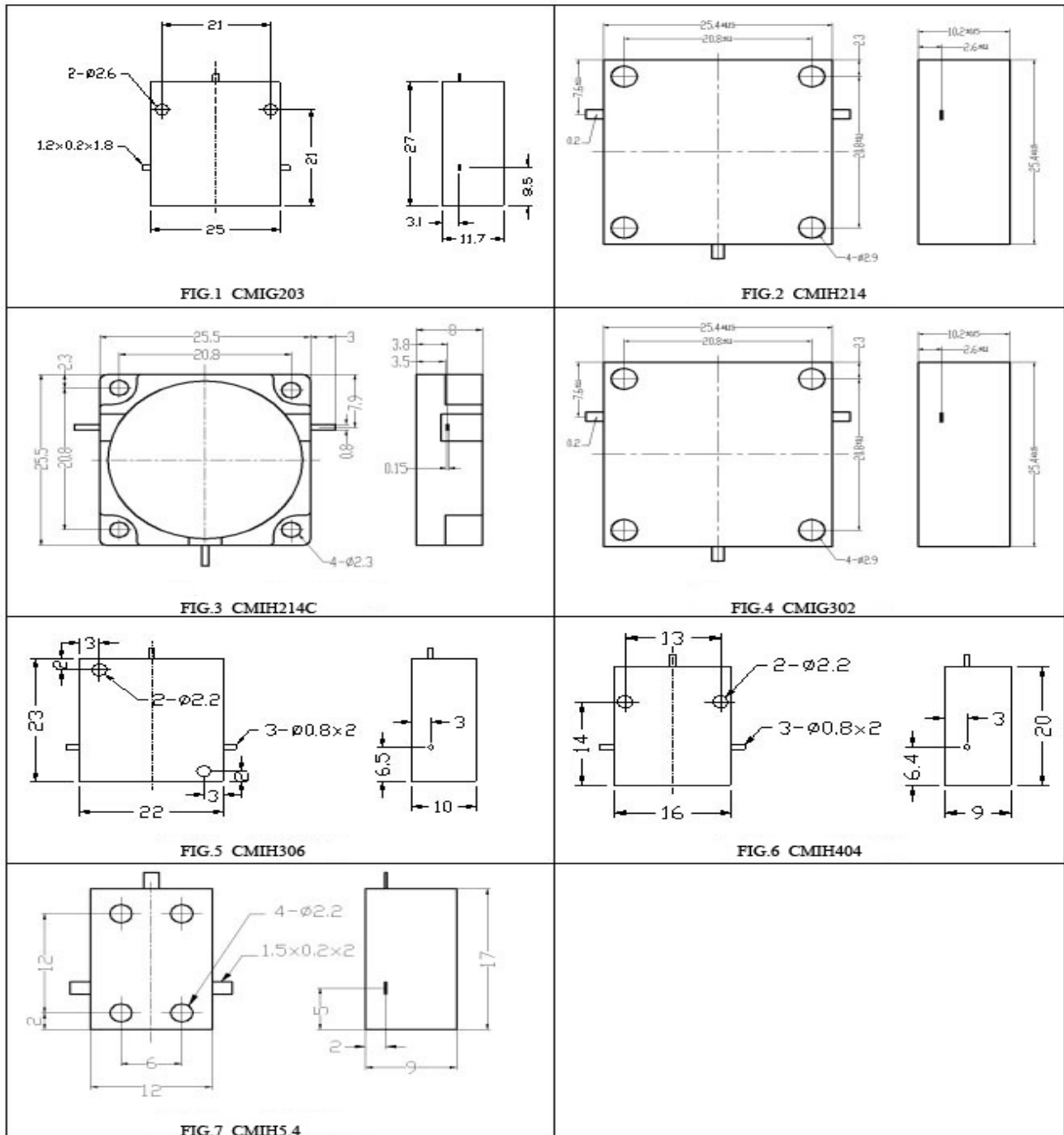

**CALL OUR SALES DEPARTMENT FOR MORE INFORMATION OR VARIATIONS OF THIS PRODUCT.**

**Corry Micronics, Inc. One Plastics Rd. - Corry, PA 16407**  
**(814) 664-7728 Fax (814) 664-4582 [www.cormic.com](http://www.cormic.com)**

Corry Micronics Inc. herein referred to CMI, believes this information to be accurate, but makes no warranties, expressed or implied as to the accuracy of this document. CMI assumes no liability for any injury, loss, damage, direct or consequential arising from the use of our products. User assumes all risk whatsoever in connection with it's intended use. CMI also reserves the right to change this document without notice.

**Lumped Element Circulators**

PART NUMBER	FREQ. RANGE ( GHz )	BANDWIDTH ( % )	IL (dB)	ISO (dB)	VSWR	Power (W)	DIMENSIONS (mm)				PACKAGE
							A	B	C	D	
CMIHL101	0.05 ~ 0.1	5 ~ 15	0.8	18	1.3	10					FIG.5
CMIHL102	0.1 ~ 0.9	20	0.6	20	1.25	30					FIG.6
CMIHL103	0.12 ~ 0.2	5 ~ 15	0.5	20	1.25	1200	250	130			FIG.2
CMIHL104	0.15 ~ 0.9	5	0.4	22	1.20	50					FIG.1
CMIHL105	0.15 ~ 0.9	10 ~ 20	0.6	20	1.25	10					FIG.1
CMIHL106	0.2 ~ 1.0	30 ~ 50	1.0	18	1.35	10					FIG.4
CMIHL107	0.2 ~ 0.4	5 ~ 15	0.5	20	1.25	1200	190	65			FIG.2
CMIHL108	0.36 ~ 0.7	15 ~ 20	0.6	20	1.3	300					FIG.3
CMIHL109	0.4 ~ 0.9	5 ~ 15	0.5	20	1.25	1200	120	40			FIG.2

**CALL OUR SALES DEPARTMENT FOR MORE INFORMATION OR VARIATIONS OF THIS PRODUCT.**

**Corry Micronics, Inc. One Plastics Rd. - Corry, PA 16407**  
**(814) 664-7728 Fax (814) 664-4582 [www.cormic.com](http://www.cormic.com)**

Corry Micronics Inc. herein referred to CMI, believes this information to be accurate, but makes no warranties, expressed or implied as to the accuracy of this document. CMI assumes no liability for any injury, loss, damage, direct or consequential arising from the use of our products. User assumes all risk whatsoever in connection with it's intended use. CMI also reserves the right to change this document without notice.

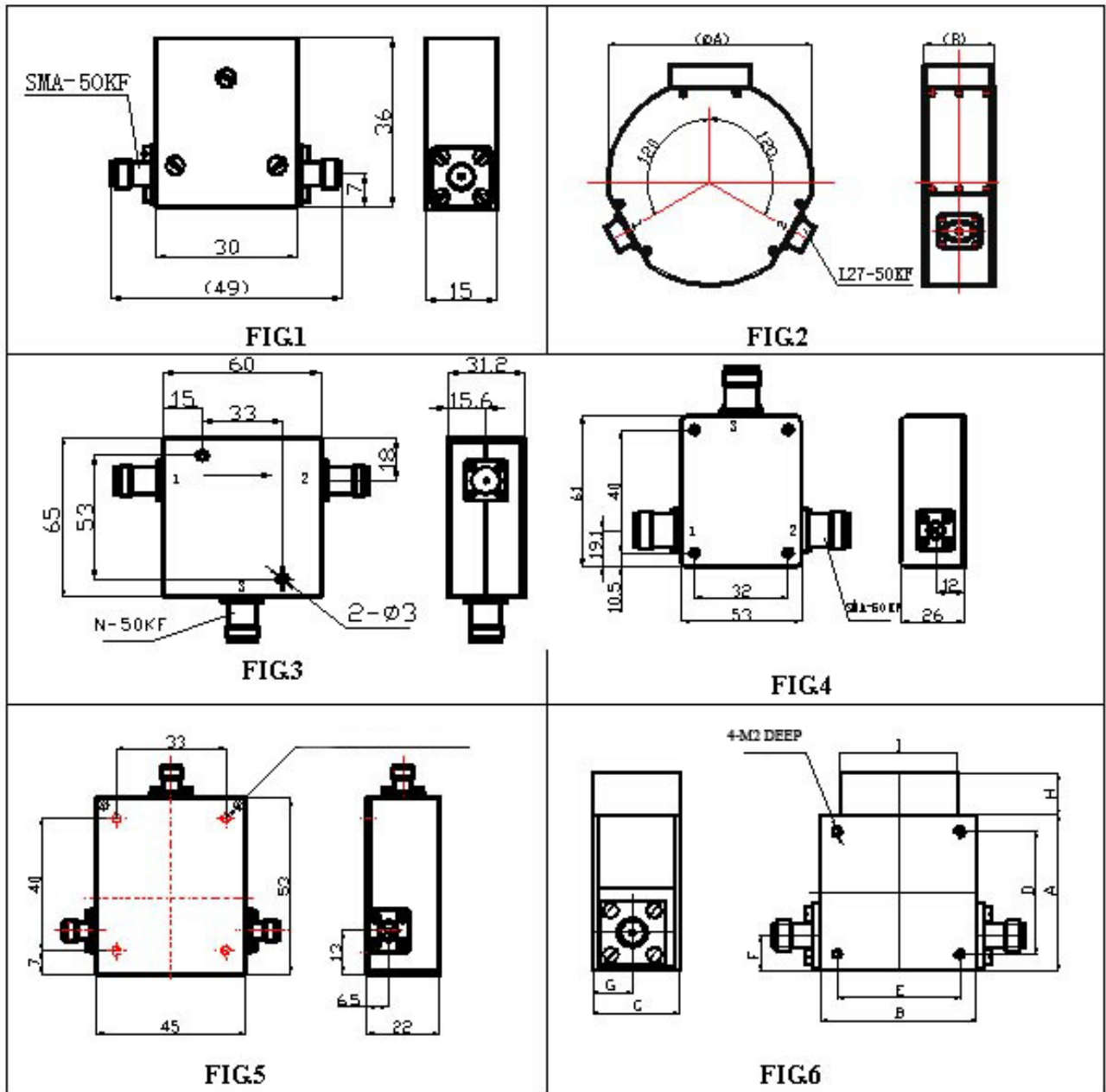

**CALL OUR SALES DEPARTMENT FOR MORE INFORMATION OR VARIATIONS OF THIS PRODUCT.**

**Corry Micronics, Inc. One Plastics Rd. - Corry, PA 16407**  
**(814) 664-7728 Fax (814) 664-4582 [www.cormic.com](http://www.cormic.com)**

Corry Micronics Inc. herein referred to CMI, believes this information to be accurate, but makes no warranties, expressed or implied as to the accuracy of this document. CMI assumes no liability for any injury, loss, damage, direct or consequential arising from the use of our products. User assumes all risk whatsoever in connection with it's intended use. CMI also reserves the right to change this document without notice.