



# EUROPEAN ANTENNAS

Excellence through design  
Creative in concept

## FLAT PANEL ANTENNA

### MODEL: FPA13-21VH/1094

<b>FREQUENCY:</b>	2.0 - 2.25 GHz	<b>GAIN:</b>	13 dBi Minimum
<b>POLARISATION:</b>	Dual Linear, Vertical & Horizontal	<b>BEAMWIDTH:</b>	32° (Az.) x 32° (El.)
<b>CROSS POLAR:</b>	20 dB Minimum	<b>VSWR:</b>	1.5 : 1
<b>POWER RATING:</b>	2 x 10 W	<b>FRONT TO BACK:</b>	20 dB Typical
<b>TEMPERATURE:</b>	-20° to +50°C	<b>MASS:</b>	900g / 1.98 lbs Approx.
<b>FINISH:</b>	Alocrom 1200 Chassis, White Radome	<b>WIND LOADING:</b>	9.5 Kg / 20.9 lbs @ 100 mph

### TOP VIEW

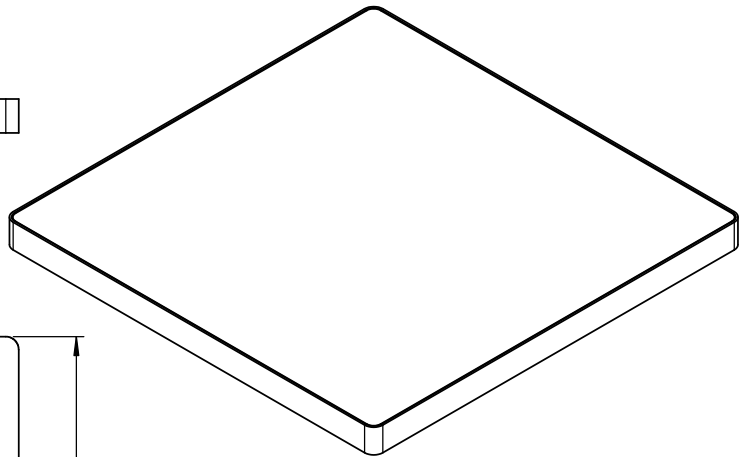
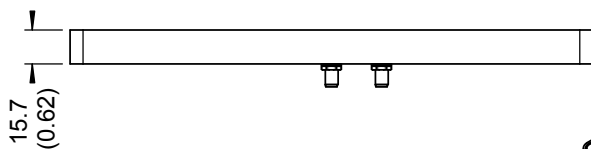

### ISOMETRIC VIEW

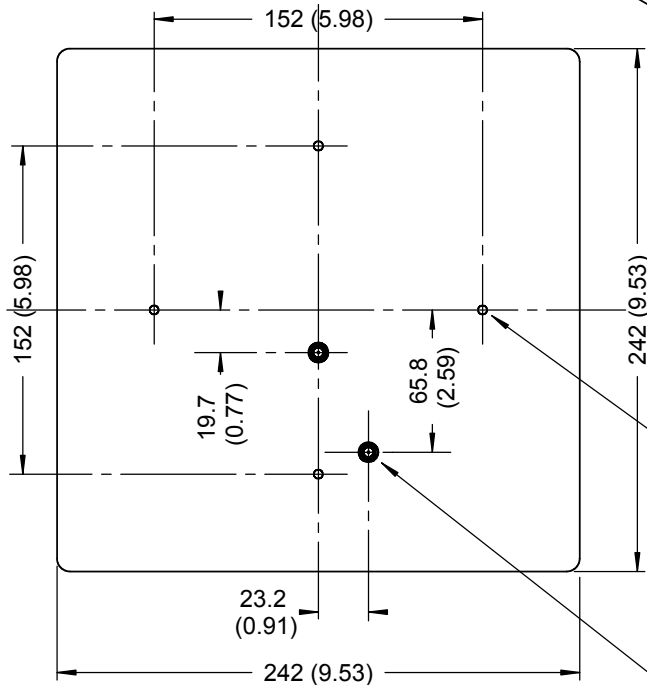

MOUNTED VIA 4 OFF  
M5 TAPPED HOLES

2 OFF  
SMA(F) CONNECTORS

### REAR VIEW

<b>DIMENSIONS:</b> mm (inches)	<b>M</b>
GA: 1094 - 1	Issued: 090104

EUROPEAN ANTENNAS LTD.

Tel: +44 (0)1638 731888  
Fax: +44 (0)1638 731999

LAMBDA HOUSE, CHEVELEY  
NEWMARKET, SUFFOLK, CB8 9RG,  
UNITED KINGDOM

E-Mail: [sales@european-antennas.co.uk](mailto:sales@european-antennas.co.uk)  
Website: [www.european-antennas.co.uk](http://www.european-antennas.co.uk)