

# ATTENUATORS

Type N, up to 4 GHz, 150 Watts

## SPECIFICATIONS:

Models: XN150W-XX, XN150W-XXF, XN150W-XXM

**RoHS**  
Compliant

**AEROFLEX**  
A passion for performance.

### Electrical:

Frequency Range \_\_\_\_\_ DC - 4.0 GHz  
Standard Freq. Values \_\_\_\_\_ 2.5 & 4 GHz  
Standard dB Value \_\_\_\_\_ 3, 6, 10, 20, 30 & 40 dB  
Attenuation Accuracy DC - 1.5 GHz 1.5 - 2.5 GHz 2.5 - 4 GHz  
3 & 6 dB \_\_\_\_\_  $\pm 0.50$  dB \_\_\_\_\_  $\pm 1.0$  dB \_\_\_\_\_  $\pm 1.5$  dB  
10 & 20 dB \_\_\_\_\_  $\pm 0.50$  dB \_\_\_\_\_  $\pm 0.75$  dB \_\_\_\_\_  $\pm 1.0$  dB  
30 & 40 dB \_\_\_\_\_  $\pm 0.75$  dB \_\_\_\_\_  $\pm 1.0$  dB \_\_\_\_\_  $\pm 1.5$  dB  
Input VSWR (Max.) \_\_\_\_\_ 1.15:1 \_\_\_\_\_ 1.25:1 \_\_\_\_\_ 1.35:1  
Input Power \_\_\_\_\_ 150 Watts Avg. @ +25°C  
Derated Linearly to 30 Watts @ +125°C  
Peak Power \_\_\_\_\_ 2 kW Max.  
(5uSec Pulse, .05% Duty Cycle)  
Impedance \_\_\_\_\_ 50 Ohms  
Operating Temp. Range \_\_\_\_\_ -54°C to +125°C

### Mechanical:

Type N Connectors \_\_\_\_\_ Passivated Stainless Steel  
Mates with MIL-STD-348  
Conductors \_\_\_\_\_ Gold Plated Beryllium Copper  
Housing \_\_\_\_\_ Anodized Aluminum

Custom Mtg. hole Config.  
may be Added to this  
Surface

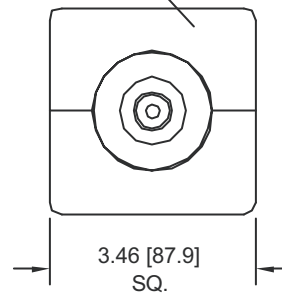

END VIEW  
TYPICAL

Units must be Mounted in such a way as to  
Allow for Free Air Flow Around fins to Assure  
Performance

Note: Units are Unidirectional, Therefore Input Connector MUST be specified & will be Indicated on Unit

Model Number: **XN150W-30**

Male/Female Connectors  
Length:  $6.36 \pm 0.05$  [161.5  $\pm$  1.3]  
Pictured

Model Number: **XN150W-30F**

Female/Female Connectors  
Length:  $6.45 \pm 0.05$  [163.8  $\pm$  1.3]

Model Number: **XN150W-30M**

Male/Male Connectors  
Length:  $6.28 \pm 0.05$  [159.5  $\pm$  1.3]

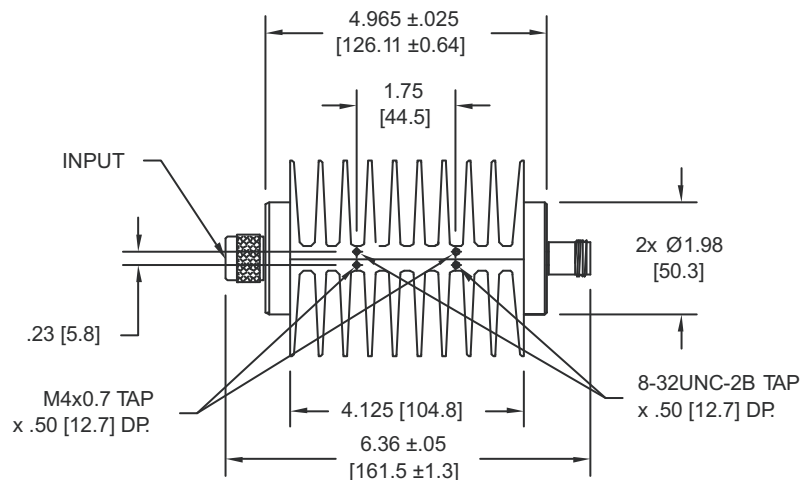

## HOW TO ORDER:

Model Number: **XN150W-30Y**

Freq. Range \_\_\_\_\_  
2 = DC - 2.5 GHz  
4 = DC - 4 GHz

Connector Configuration  
= Male/Female  
F = Fem/Fem  
M = Male/Male

## Ordering Examples:

Model Number: **4N150W-30**  
DC - 4 GHz, 30 dB; Type N - Male/Fem

Model Number: **2N150W-30F**  
DC - 2.5 GHz, 30 dB; Type N - Fem/Fem

Note: Dimensions in Brackets are Expressed in Millimeters and are for Reference Only.  
Design, specifications are subject to change without notice. Contact factory for technical  
specifications before purchasing and/or use.

XN150W-ATT: REV G

**AEROFLEX**  
INMET

Aeroflex / Inmet, Inc. • 300 Dino Drive, Ann Arbor, MI 48103 • U.S.A.  
888-244-6638 or 734-426-5553 • FAX: 734-426-5557  
www.aeroflex.com/inmet • inmet@aeroflex.com