

QMA Female Bulkhead Connector Solder Attachment For PE-SR402AL, PE-SR402FL, RG402, .268 inch D Hole



TECHNICAL DATA SHEET

PE44500

QMA Female Bulkhead Connector Solder Attachment For PE-SR402AL, PE-SR402FL, RG402, .268 inch D Hole

Configuration

| | |
|--|-------------------------------|
| Connector | QMA Female |
| Connector Interface Type | PE-SR402AL, PE-SR402FL, RG402 |
| Cable Attachment Method (Shield/Contact) | Solder/Solder |
| Body Style | Straight |
| Mount Method | Bulkhead |

Electrical Specifications

| | |
|---------------------------------------|----------|
| Frequency Range, GHz | DC to 18 |
| Impedance, Ohms | 50 |
| Maximum Operating Voltage, Volts | 335 |
| Dielectric Withstanding Voltage, Vrms | 1,000 |

Frequency 1

| | |
|--------------------|---------|
| Frequency, GHz | DC to 3 |
| VSWR | 1.05:1 |
| Return Loss, dB | 32 |
| Insertion Loss, dB | 0.087 |

Frequency 2

| | |
|--------------------|--------|
| Frequency, GHz | 3 to 6 |
| VSWR | 1.12:1 |
| Return Loss, dB | 25 |
| Insertion Loss, dB | 0.122 |

Mechanical Specifications

Temperature

| | |
|------------------------|------------|
| Operating Range, deg C | -40 to +85 |
|------------------------|------------|

Size

| | |
|---------------------|---------------|
| Length, in [mm] | 0.787 [19.99] |
| Width/Dia., in [mm] | 0.433 [11] |
| Weight, lbs [g] | 0.006 [2.72] |

Click the following link (or enter part number in "SEARCH" on website) to obtain additional part information including price, inventory and certifications: [QMA Female Bulkhead Connector Solder Attachment For PE-SR402AL, PE-SR402FL, RG402, .268 inch D Hole PE44500](#)

The information contained in this document is accurate to the best of our knowledge and representative of the part described herein. It may be necessary to make modifications to the part and/or the documentation of the part, in order to implement improvements. Pasternack reserves the right to make such changes as required. Unless otherwise stated, all specifications are nominal.

QMA Female Bulkhead Connector Solder Attachment For PE-SR402AL, PE-SR402FL, RG402, .268 inch D Hole



TECHNICAL DATA SHEET

PE44500

Connector

| | |
|---------------------------------------|------------------------|
| Type | QMA Female |
| Contact Material and Plating | Beryllium Copper, Gold |
| Contact Plating Specification | 6μ in. minimum |
| Outer Conductor Material and Plating | Brass, Gold |
| Outer Conductor Plating Specification | 6μ in. minimum |
| Body Material and Plating | Brass, Gold |
| Body Plating Specification | 6μ in. minimum |
| Dielectric Type | PTFE |

Compliance Certifications (visit www.Pasternack.com for current document)

| | |
|----------------|-----|
| RoHS Compliant | Yes |
|----------------|-----|

Plotted and Other Data

| | |
|--------|----------------------------|
| Notes: | Values at 25 °C, sea level |
|--------|----------------------------|

QMA Female Bulkhead Connector Solder Attachment For PE-SR402AL, PE-SR402FL, RG402, .268 inch D Hole from Pasternack Enterprises has same day shipment for domestic and International orders. Our RF, microwave and fiber optic products maintain a 99% availability and are part of the broadest selection in the industry.

Click the following link (or enter part number in "SEARCH" on website) to obtain additional part information including price, inventory and certifications: [QMA Female Bulkhead Connector Solder Attachment For PE-SR402AL, PE-SR402FL, RG402, .268 inch D Hole PE44500](http://www.pasternack.com/qma-female-standard-pe-sr402al-pe-sr402fl-rg402-connector-pe44500-p.aspx)

URL: <http://www.pasternack.com/qma-female-standard-pe-sr402al-pe-sr402fl-rg402-connector-pe44500-p.aspx>

The information contained in this document is accurate to the best of our knowledge and representative of the part described herein. It may be necessary to make modifications to the part and/or the documentation of the part, in order to implement improvements. Pasternack reserves the right to make such changes as required. Unless otherwise stated, all specifications are nominal.

PE44500 CAD Drawing

QMA Female Bulkhead Connector Solder Attachment For
PE-SR402AL, PE-SR402FL, RG402, .268 inch D Hole

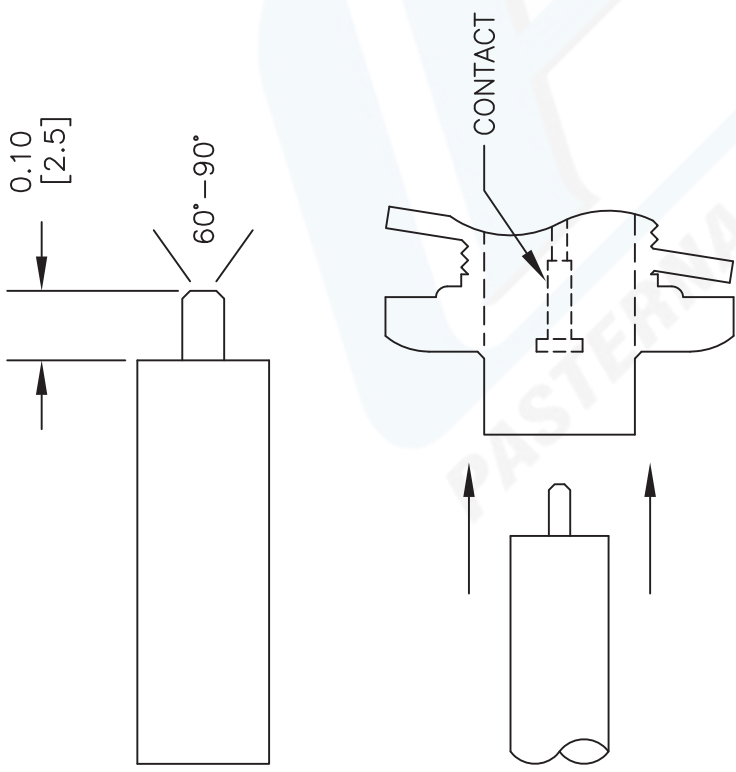
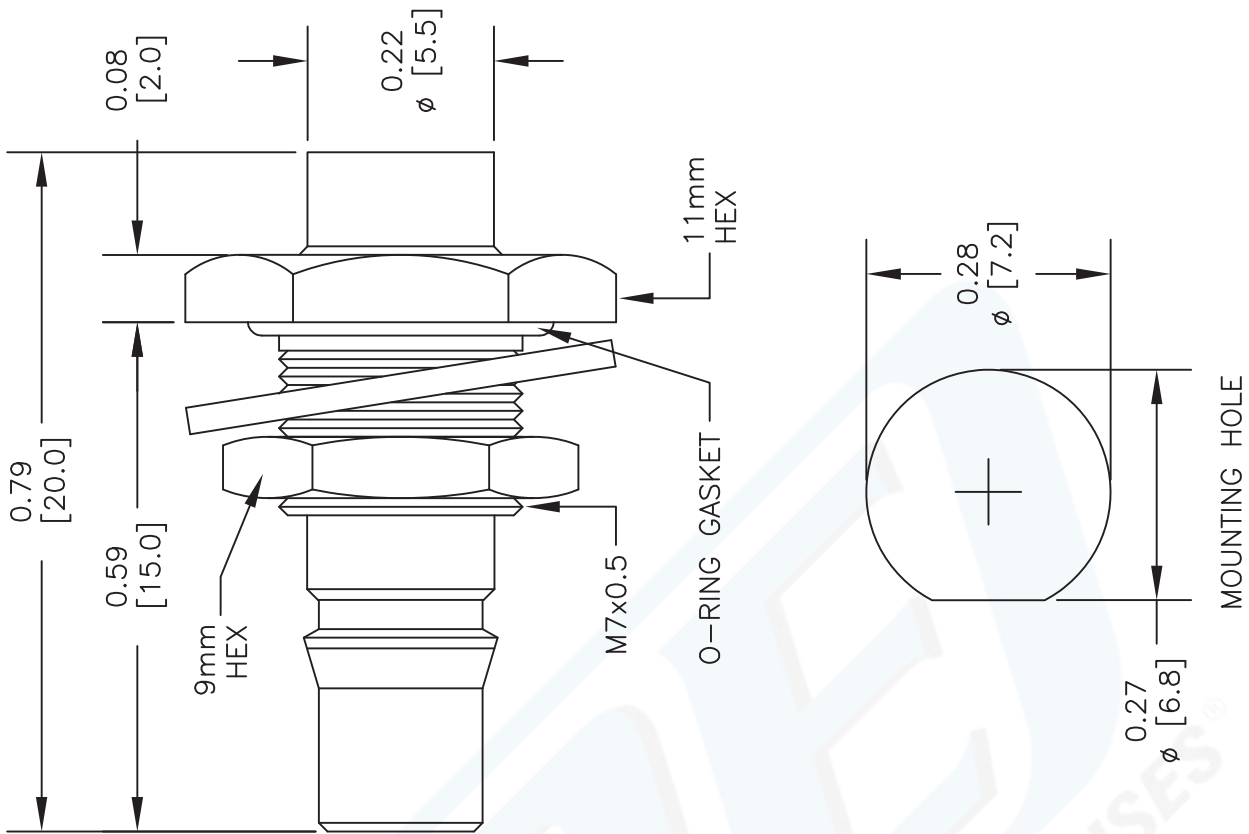

- STRIPPING DIMENSIONS
- ASSEMBLY PROCEDURES
1. STRIP CABLE AS SHOWN. DO NOT NICK CENTER CONDUCTOR.
 2. FILE CHAMFER.
 3. INSERT CABLE INTO CONNECTOR BODY. MATING THE CENTER CONDUCTOR IN TO CAPTIVATE CENTER PIN.
 4. SOLDER CABLE TO CONNECTOR BODY.

DWG TITLE

PE44500

NOTES:
1. UNLESS OTHERWISE SPECIFIED ALL DIMENSIONS ARE NOMINAL.
2. ALL SPECIFICATIONS ARE SUBJECT TO CHANGE WITHOUT NOTICE AT ANY TIME.
3. DIMENSIONS ARE IN INCHES [mm].
4. FITS MIL-C-17 AND EQUIVALENT CABLES.

FSCM NO. 53919

CAD FILE 110112-A

SCALE N/A

SIZE A

2233

P**ASTERNACK**[®]
Pasternack Enterprises, Inc.
P.O. Box 16759 | Irvine | CA | 92623
Phone: (949) 261-1920 | Fax: (949) 261-7451
Website: www.pasternack.com | E-Mail: sales@pasternack.com